

168940

THIS FORM HAS BEEN APPROVED BY THE INDIANA STATE BAR ASSOCIATION FOR USE BY LAWYERS ONLY. THE SELECTION OF A FORM OF INSTRUMENT, FILLING IN BLANK SPACES, STRIKING OUT PROVISIONS AND INSERTION OF SPECIAL CLAUSES, CONSTITUTES THE PRACTICE OF LAW AND MAY ONLY BE DONE BY A LAWYER.

Mail tax bills to: 92035783

Tax Key No.:

# WARRANTY DEED

8944 HESS DRIVE  
HIGHLAND, INDIANA 46322

STATE OF INDIANA  
LAKE COUNTY  
FILED FOR RECORD  
JUN 4 9 13 AM '92  
ROBERT HENDERSON  
RECORDER  
HIGHLAND

This indenture witnesseth that

STEVEN J. SCHAU

of LAKE County in the State of INDIANA

Convey and warrant to

CRAIG JOHNSTON AND KATHLEEN JOHNSTON, HUSBAND AND WIFE

of LAKE County in the State of INDIANA

for and in consideration of Ten Dollars and other good and valuable consideration the receipt whereof is hereby acknowledged, the following Real Estate in LAKE County in the State of Indiana, to wit:

LOT 7 IN BLOCK 2 IN FIFTH STREET ESTATES FIRST ADDITION TO THE TOWN OF HIGHLAND, AS PER PLAT THEREOF, RECORDED IN PLAT BOOK 31 PAGE 57, IN THE OFFICE OF THE RECORDER OF LAKE COUNTY, INDIANA.  
Commonly known as: 8944 HESS DRIVE, HIGHLAND, INDIANA 46322.



Subject to past and current year real estate taxes. 27-255-7  
Subject to easements, restrictions and covenants of record, if any.

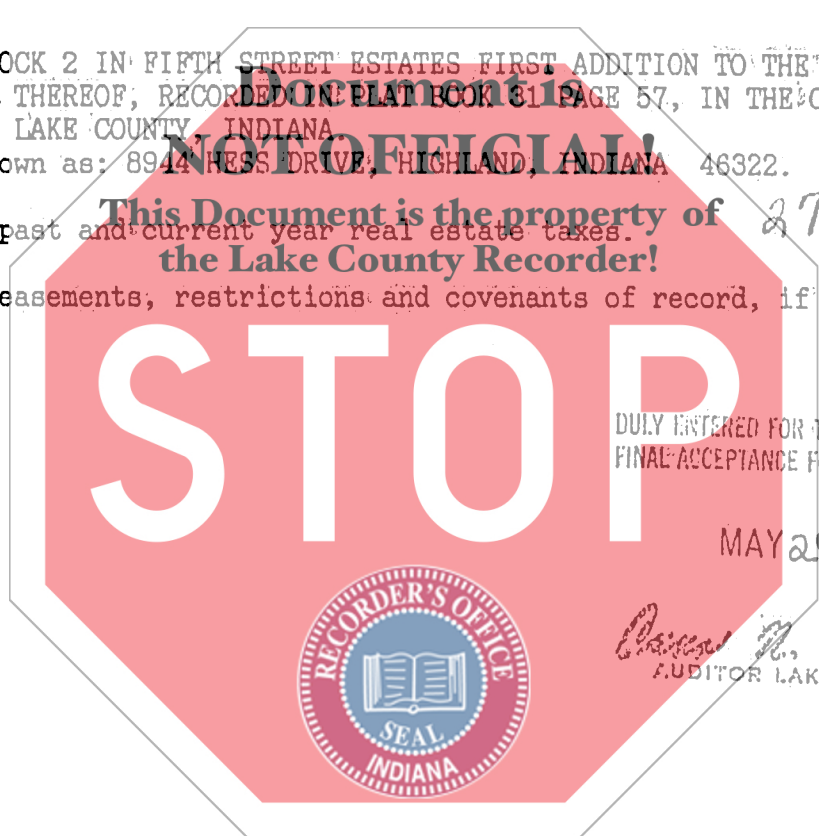

DULY ENTERED FOR TAXATION SUBJECT TO FINAL ACCEPTANCE FOR TRANSFER.  
MAY 29 1992  
Auditor Lake County

State of Indiana, Lake County, ss:  
Before me, the undersigned, a Notary Public in and for said County and State, this 19th day of May 19 92 personally appeared:

Dated this 19th Day of May 19 92

STEVEN J. SCHAU

STEVEN J. SCHAU

And acknowledged the execution of the foregoing deed. In witness whereof, I have hereunto subscribed my name and affixed my official seal. My commission expires December 31 93

Jean Henderson  
Notary Public

Resident of Lake County.

This instrument prepared by John D. Breclaw, JOHN D. BRECLAW & ASSOCIATES  
735 West Glen Park Avenue, Griffith, IN. 46319  
219-924-8750 Attorney at Law

700  
to  
01433 E