

MAIL TAX BILLS TO: 92035030
John M. Morley
731 Christy Lane
Scherverville, IN 46375

TAX KEY NO: 13-204-13

QUIT-CLAIM DEED

This indenture witnesseth that SYLVIA L. MORLEY

of LAKE County in the State of INDIANA

Releases and quit claims to JOHN M. MORLEY

of LAKE County in the State of INDIANA
for and in consideration of Ten Dollars and other good and valuable consideration the receipt whereof is hereby acknowledged, the following Real Estate in Lake County in the State of Indiana, to wit:

Lot 33, Cline Meadows, Unit No. 3, to the Town of Scherverville, as shown in Plat Book 46 page 66, in Lake County, Indiana.

Commonly known as 731 Christy Lane, Scherverville, Indiana 46375.

This Document is the property of the Lake County Recorder

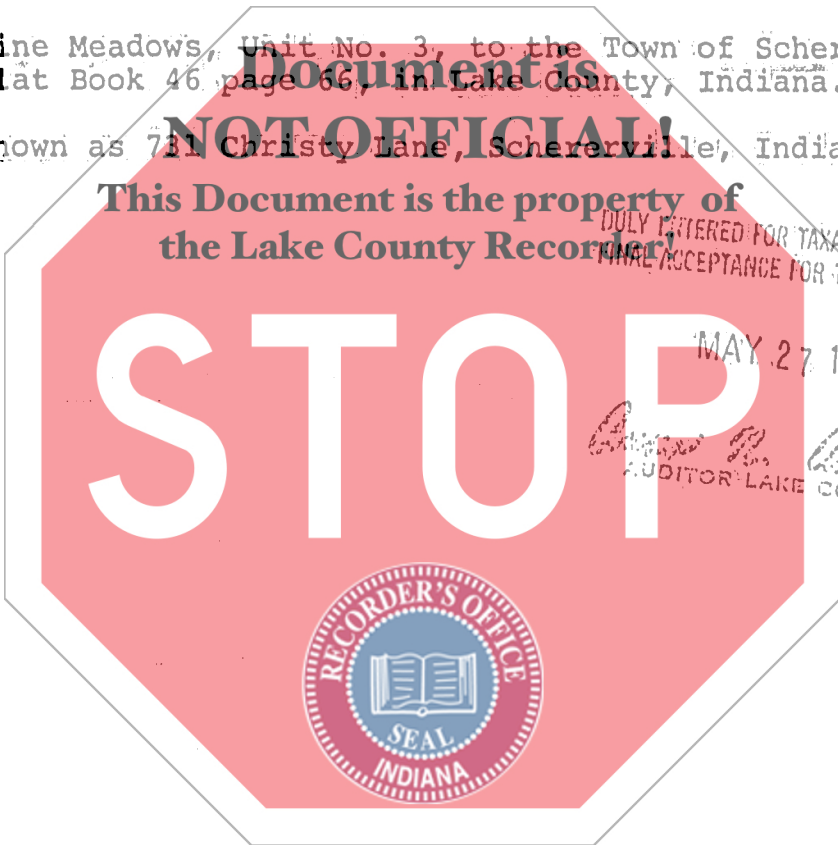

DULY ENTERED FOR TAXATION SUBJECT TO FUTURE ACCEPTANCE FOR TRANSFER.

MAY 27 1992

Robert M. Ireland
AUDITOR LAKE COUNTY



ROBERT M. IRELAND
RECORDER

JUN 2 9 47 AM '92

STATE OF INDIANA / S.S. NO. FILED FOR RECORDING

State of Indiana, Lake County, ss:
Before me, the undersigned, a Notary Public in and for said County and State, this 28th day of April 19 92 personally appeared:

Sylvia L. Morley

Dated this 28th Day of April 1992

Sylvia L. Morley
SYLVIA L. MORLEY

And acknowledged the execution of the foregoing deed. In witness whereof, I have hereunto subscribed my name and affixed my official seal. My commission expires August 8 19 94

Emma B. Nedberg
Emma B. Nedberg, Notary Public

Resident of Lake County

This instrument prepared by Richard C. Wolter, 1920 North Main St., Attorney at Law, PO Box 875, Crown Point, Indiana 46307

MAIL TO:

01200000