

H.O. 458 957 LD ②

THIS FORM HAS BEEN APPROVED BY THE INDIANA STATE BAR ASSOCIATION FOR USE BY LAWYERS ONLY. THE SELECTION OF A FORM OF INSTRUMENT, FILLING IN BLANK SPACES, STRIKING OUT PROVISIONS AND INSERTION OF SPECIAL CLAUSES, CONSTITUTES THE PRACTICE OF LAW AND MAY ONLY BE DONE BY A LAWYER.

92034007

Tax Key No. 36-24-8

Mail tax bills to:
1622 Lake Avenue
Whiting, IN. 46394

DEED OF PERSONAL REPRESENTATIVE

EDWARD FRANCIS MULLANEY

as Personal Representative,

of the Estate of Eleanor A. Mullaney, presently pending in Lake Superior Court, Room Three, Cause Number 45-D03-9204-ES-00094

DULY ENTERED FOR TAXATION SUBJECT TO FINAL ACCEPTANCE FOR TRANSFER.

MAY 29 1992

Anna M. Antox
AUDITOR LAKE COUNTY

conveys to Samuel Miramontes

of the County of Lake, State of Indiana, the following described real estate in Lake County, State of Indiana, more particularly described as follows, to-wit:

Lot 8, Block 6, Sheffield, a Subdivision in the City of Hammond, as shown in Plat Book 14, page 6, in Lake County, Indiana.

Commonly known as: 1622 Lake Avenue Whiting, IN. 46394

Key Number: 36-24-8

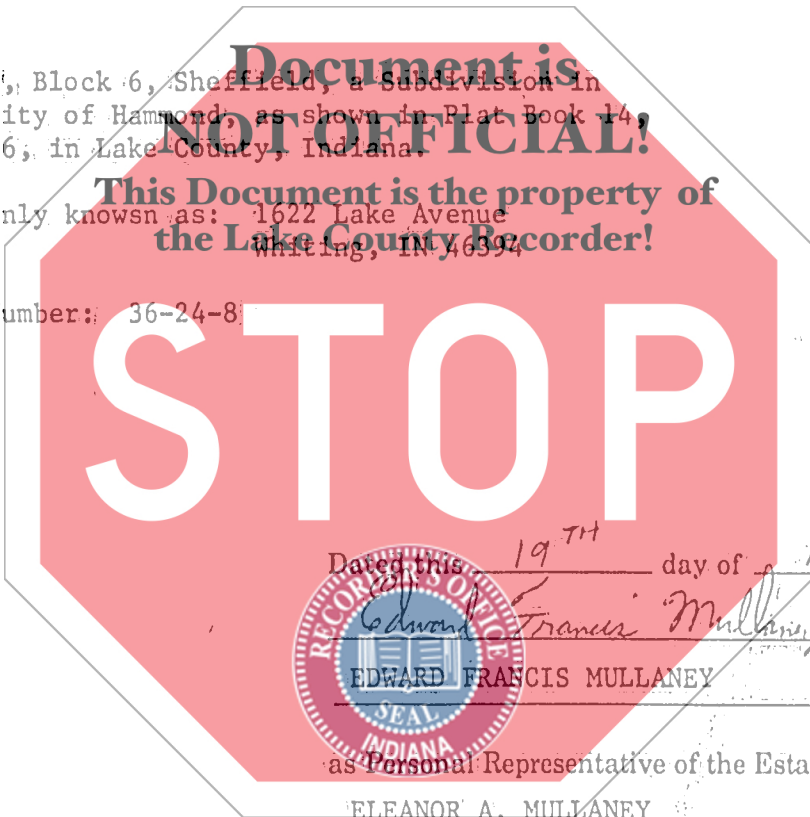

ROBERT RECORDER CLERK

JUN 11 1 23 PM '92

STATE OF INDIANA
LAKE COUNTY
FILED FOR RECORD

Dated this 19TH day of MAY, 1992

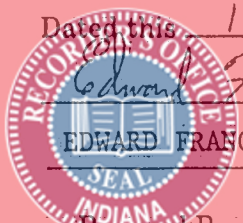

Edward Francis Mullaney
EDWARD FRANCIS MULLANEY

as Personal Representative of the Estate of ELEANOR A. MULLANEY

STATE OF INDIANA)
COUNTY OF Lake)

SS:

Before me, the undersigned, a Notary Public, in and for said County and State, personally appeared EDWARD FRANCIS MULLANEY

_____ as Personal Representative of the Estate of _____

deceased, and acknowledged the execution of this deed.

WITNESS MY HAND AND SEAL THIS 19th day of May, 1992

My Commission Expires: 12-17-93

Roberta S. Tate
Roberta S. Tate

Resident of Porter County

Notary Public

This instrument prepared by KENNETH L. ANDERSON

Attorney at Law.

Mail to:

01312

700 ct