

92031706

Warranty Deed

THIS INDENTURE WITNESSETH, That SANDRA LORENZ, a single adult

of LAPORTE County, in the State of INDIANA. Convey and Warrant

to GLENN BEESON AND SHIRLEY BEESON, Husband and Wife as

tenants by the entireties

of Lake County, in the State of Indiana, for and in consideration of the sum of

TEN (\$10.00) DOLLARS and other valuable consideration - - - - -

the receipt whereof is hereby acknowledged, the following described Real Estate in LAKE County, in the State of Indiana, to-wit:

Lot 19, Block 1, in Stafford and Trankel's Addition to the City of Hammond, as per plat thereof, recorded in Plat Book 5, page 4, in the Office of the Recorder of Lake County. 36-115-21

SUBJECT to 1992 real estate taxes due and payable in 1993 and all subsequent years thereto.

This conveyance is made subject to conditions, limitations, restrictions and easements of record, if any, including but not limited to:

Defects, liens, encumbrances, adverse claims or other matters, if any, created first appearing in the public records or attaching subsequent to the effective date hereof but prior to the date the proposed insured acquires for value of the real estate or interest or mortgage thereon.

Rights or claims of parties in possession not shown by the public records.

Easements or claims of easements; not shown by the public records; Encroachments, overlaps, boundary line disputes, or other matters which would be disclosed by an accurate survey or inspection of the premises.

Any lien, or right to a lien for services, labor, or material heretofore or hereafter furnished, imposed by law and not shown by the public records.

In Witness Whereof, The said SANDRA LORENZ, a single adult

has hereunto set her hand and seal, this 18th day of May

(Seal) *Sandra Lorenz* (Seal)
Sandra Lorenz

DULY ENTERED FOR TAXATION PURPOSES TO (Seal) (Seal)
FINAL ACCEPTANCE FOR TAXATION (Seal) (Seal)

MAY 19 1992 (Seal) (Seal)

STATE OF INDIANA, LAPORTE COUNTY, ss:

Anna N. [Signature]
AUDITOR LAKE COUNTY, before me the undersigned, a Notary Public in and for said County, this

18th day of May 19 92, came

SANDRA LORENZ, a single adult

, and acknowledged the execution of the foregoing instrument.

Witness my hand and official seal.

My Commission expires... 5-3-94

Elizabeth J. Pea Notary Public
A resident of Laporte County

This instrument prepared by:
Richard P. Schaumann, 6322 W. 400 N, Michigan City, IN 46360

01143

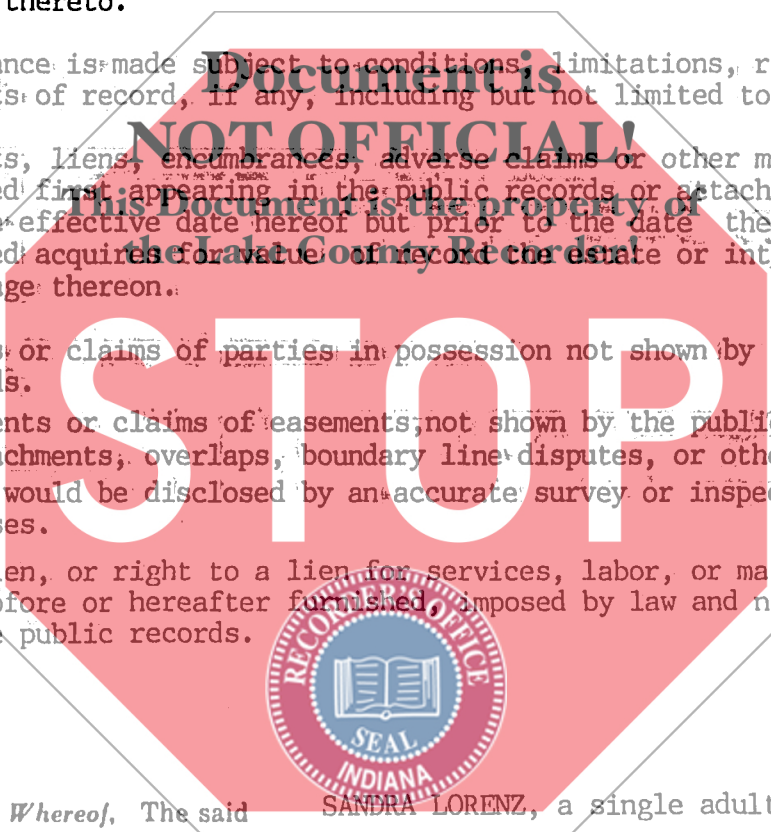

ROBERT J. REELAND
RECORDER
MAY 19 10 30 AM '92