

C097-1100

THIS FORM HAS BEEN APPROVED BY THE INDIANA STATE BAR ASSOCIATION FOR USE BY LAWYERS ONLY. THE SELECTION OF A FORM OF INSTRUMENT, FILLING IN BLANK SPACES, STRIKING OUT PROVISIONS AND INSERTION OF SPECIAL CLAUSES, CONSTITUTES THE PRACTICE OF LAW AND MAY ONLY BE DONE BY A LAWYER.

MAIL TAX BILLS TO:

TAX KEY NO: 25-15-39

92031041

QUIT-CLAIM DEED

This indenture witnesseth that

***** RUBY NAGLER *****

of _____ County in the State of Wisconsin

Releases and quit claims to:

***** VIRGINIA DECOUDRES *****

of Talladega County in the State of Alabama
for and in consideration of Ten dollars and other good and valuable consideration
the receipt whereof is hereby acknowledged, the following Real Estate in
in the State of Indiana, to wit:

STATE OF INDIANA/S.S.N.U.
LAKE COUNTY
FILED FOR RECORD
MAY 15 10 56 AM '92
ROBERT E. FREELAND
RECORDER

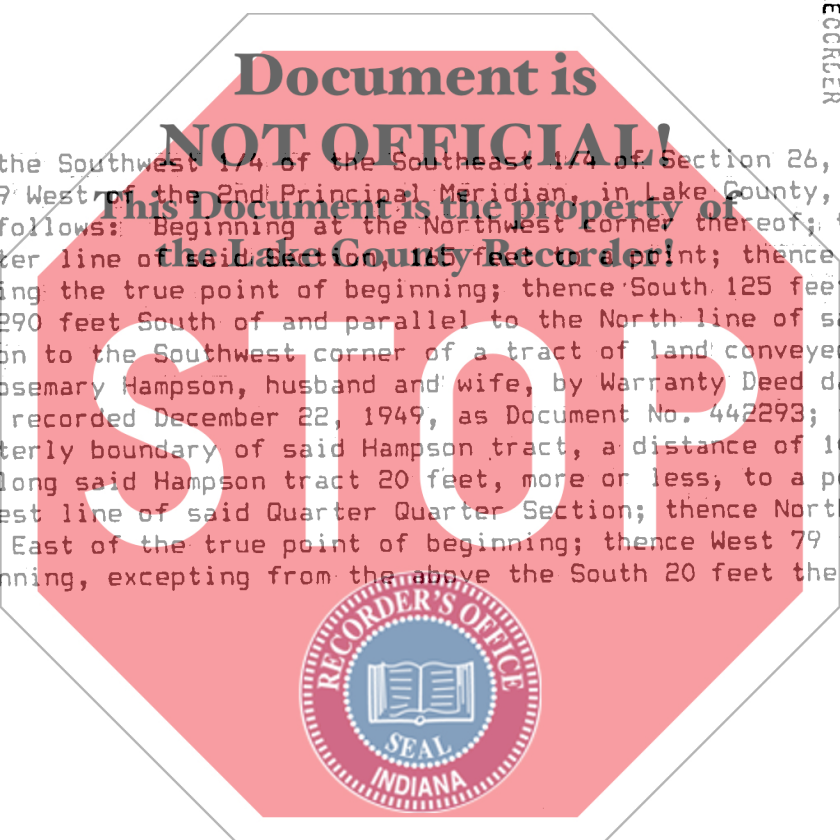

That part of the Southwest 1/4 of the Southeast 1/4 of Section 26, Township 34 North, Range 9 West of the 2nd Principal Meridian, in Lake County, Indiana, described as follows: Beginning at the Northwest corner thereof; thence South along the center line of said Section 26, 1/4 mile to a point; thence East 339 feet to a point being the true point of beginning; thence South 125 feet; thence East along a line 290 feet South of and parallel to the North line of said Quarter Quarter Section to the Southwest corner of a tract of land conveyed to Edwin F. Hampson and Rosemary Hampson, husband and wife, by Warranty Deed dated December 20, 1949, and recorded December 22, 1949, as Document No. 442293; thence North along the Westerly boundary of said Hampson tract, a distance of 105.15 feet; thence West along said Hampson tract 20 feet, more or less; to a point 418 feet East of the West line of said Quarter Quarter Section; thence North 20 feet to a point 79 feet East of the true point of beginning; thence West 79 feet to the true point of beginning, excepting from the above the South 20 feet thereof.

Wisconsin
State of ~~Indiana~~, WAUKESHA County, ss:
Before me, the undersigned, a Notary Public in and for said County and State, this 27 day of March 1992, personally appeared:

Dated this 27 Day of March 1992

Ruby Nagler Ruby M. Nagler,
RUBY NAGLER

** RUBY NAGLER **

DULY ENTERED FOR TAXATION SUBJECT TO
FINAL ACCEPTANCE FOR TRANSFER

APR 30 1992

And acknowledged the execution of the foregoing deed. In witness whereof, I have hereunto subscribed my name and affixed my official seal. My commission expires August 1 1993

Michelle L. Moore
(Notary Public)

Resident of Waukesha County

This instrument prepared by RICHARD A. ZUNICA, 162 Washington St., Lowell, IN 46356, Attorney at Law

MAIL TO:

See back