

RETURN TO;  
INDIANA UNIVERSITY EMPLOYEES  
FEDERAL CREDIT UNION  
105 EAST WINSLOW ROAD  
BLOOMINGTON INDIANA 47401

92021540

*Mi*

[Space Above This Line For Recording Data]

### MORTGAGE

THIS MORTGAGE ("Security Instrument") is given on **MARCH 28, 1992**  
The mortgagor is **GEORGE S. ZAHARIADIS AND FRANCES ZAHARIADIS, HUSBAND AND WIFE**

("Borrower"). This Security Instrument is given to  
**INDIANA UNIVERSITY EMPLOYEES FEDERAL CREDIT UNION**  
which is organized and existing under the laws of **THE UNITED STATES OF AMERICA**, and whose address is

**105 EAST WINSLOW ROAD, P.O. BOX 368, BLOOMINGTON, INDIANA 47402-0368**

("Lender"). Borrower owes Lender the principal sum of  
**SIXTY THOUSAND DOLLARS 00/00**  
Dollars (U.S. \$ **60,000.00**)

This debt is evidenced by Borrower's note dated the same date as this Security Instrument ("Note"), which provides for monthly payments, with the full debt, if not paid earlier, due and payable on **APRIL 1, 2007**. This Security Instrument secures to Lender: (a) the repayment of the debt evidenced by the Note, with interest, and all renewals, extensions and modifications of the Note; (b) the payment of all other sums, with interest, advanced under paragraph 1 to permit the security of this Security Instrument; and (c) the performance of Borrower's covenants and agreements under this Security Instrument and the Note. For this purpose, Borrower does hereby mortgage, grant and convey to Lender the following described property located in

County, Indiana:

**LOT 174, SOUTHBROOK UNIT NO. 2, AS SHOWN IN PLAT BOOK 43, PAGE 114,  
IN LAKE COUNTY, INDIANA.**

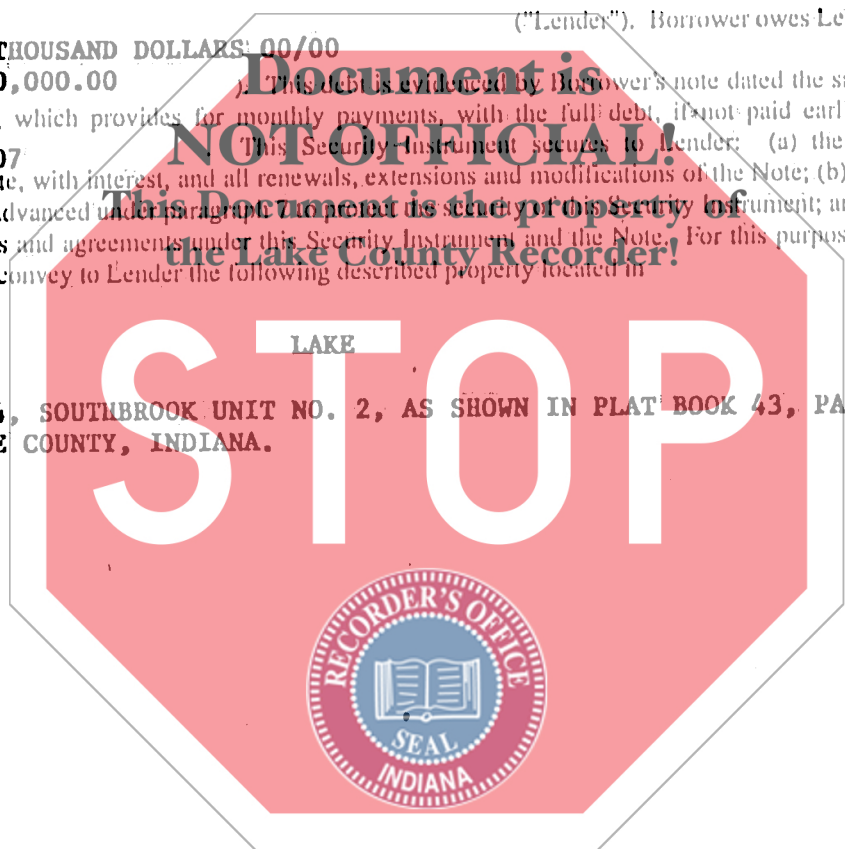

ROBERT J. ...  
RECORDER

Apr 9 9 42 AM '92

STATE OF INDIANA  
DEPT. OF REVENUE  
RECORDS SECTION

which has the address of **7491 WILSON PLACE**  
[Street]  
Indiana **46410** (**MERRILLVILLE**)  
[Zip Code] ("Property Address");

INDIANA -- Single Family -- Fannie Mae/Freddie Mae UNIFORM INSTRUMENT  
ITEM 1079 (9109)

Form 3015 9/90 (page 1 of 6 pages)  
Great Lakes Business Forms, Inc. ■  
To Order Call: 1-800-530-0303 CJ FAX 016-701-1111

*1600  
CKE*