

FA-5432

92020725

ASSIGNMENT OF REAL ESTATE MORTGAGE

Return to: First American Title Insurance Company, 2745 Commerce Plaza, Greenfield IN 46037

KNOW ALL MEN BY THESE PRESENTS: THAT DONALD WEBBER MORTGAGE COMPANY, INC. organized and existing under and by virtue of the laws of the State of Indiana and authorized to do business in Indiana and having its principal office and place of business in the Town of Highland, State of Indiana, Party of the First Part, for value received, has granted, bargained, sold assigned, transferred and set over, and by these presents does grant, sell assign, bargain, transfer and set over without recourse and without warranty, either expressed or implied, of any kind, unto: Key Corp Mortgage Inc. 205 Park Club Lane Buffalo New York 14221

Party of the Second Part, its successors and assigns, a certain indenture of mortgage dated the 5th day of March, 1992 made by Brian T. Stewart and Kathleen A. Stewart to it, securing the payment of one promissory note therein described for the sum of

Seventy Five Thousand and 00/100 (\$ 75,000.00 )

and all right, title and interest in and to the premises situated in the County of Lake, and State of Indiana and described in said mortgage as follows:

Parcel I: Lot 1 (Except the West 3 feet thereof) in Woodland Heights 7th Addition to Schererville, as per plat thereof, recorded in Plat Book 38, page 12, in the Office of the Recorder of Lake County, Indiana.

Parcel II: Part of the West 1/2 of the Southwest 1/4 of Section 16, Township 35 North, Range 9 West of the 2nd Principal Meridian, described as: Beginning at the Southeast corner of Lot 1 in Woodland Heights 7th Addition, as per Plat thereof, recorded in Plat Book 38, page 12, in the Office of the Recorder of Lake County, Indiana, thence East 20 feet along Oaksides Drive, thence Northerly on a line parallel with the East line of the said Lot 1 a distance of 165 feet, thence West for a distance of 20 feet to the Northeast corner of said Lot 1, thence South along the East Line (over) which said mortgage is recorded in the office of the Recorder of Lake County, in the State of Indiana, as Document No. 92014949 together with the said note therein described and the money due or to grow due thereon, with the interest:

TO HAVE AND TO HOLD the same unto the said party of the second part, its successors and assigns, forever; subject only to the provisions contained in the said indenture of mortgage.

IN WITNESS WHEREOF, the party of the first part has caused this instrument to be executed in its name by its President, and attested by its Secretary and its corporate seal to be hereunto affixed this 5th day of March A.D. 1992

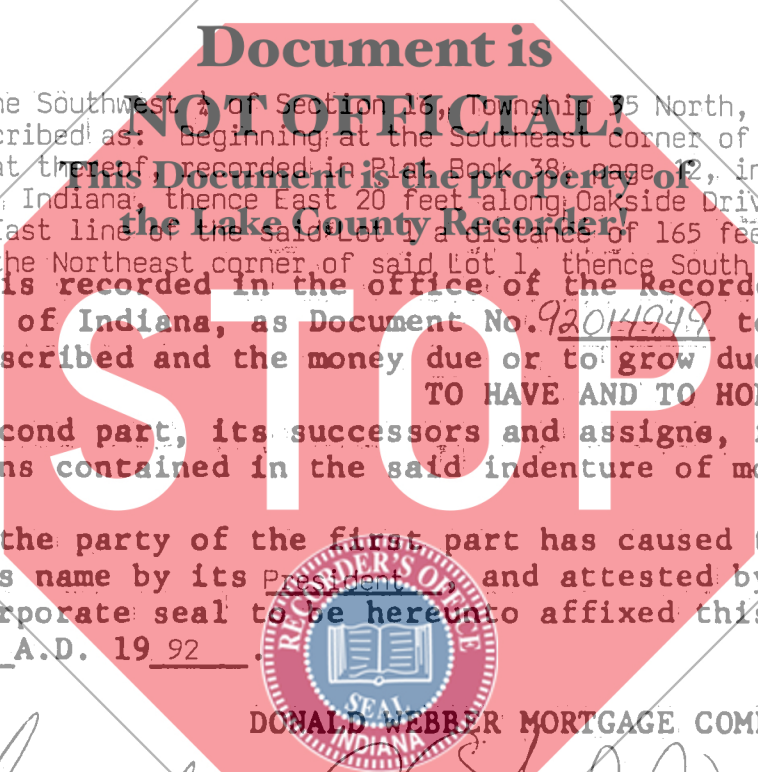

STATE OF INDIANA REC. 3-12-92 FILED FOR RECORD APR 12 29 PM '92

ATTEST SEAL Cynthia L. Gerlach BY: D.E. Webber Cynthia L. Gerlach, Compliance Officer D.E. Webber, President

STATE OF INDIANA COUNTY OF Lake

I, the undersigned, a Notary Public in and for the County and State aforesaid DO HEREBY CERTIFY that the persons whose names are subscribed to the foregoing instrument are personally known to me to be duly authorized officers of DONALD WEBBER MORTGAGE COMPANY, INC. personally known to me to be the same persons whose names are subscribed to the foregoing instrument as such officers, appeared before me this day in person and acknowledged that they signed and delivered the said instrument as their free and voluntary act and as the free and voluntary act of said corporation, for the uses and purposes therein set forth.

Given under my hand and notarial seal this 5th day of March, 1992.

My Commission expires: January 6, 1995 County of Residence: Lake

Donna J. Kozubal Notary Public

This instrument prepared by:

D.E. Webber, President of Donald Webber Mortgage Co., Inc. 2834 Highway Avenue Highland IN 46322

900 FA

of said Lot 1, a total distance of 165 feet to the place of beginning.

