



Chicago Title Insurance Company

92012696

THIS INDENTURE WITNESSETH

CHICAGO TITLE INSURANCE COMPANY
INDIANA DIVISION

That CURTIS DEAN MYERS and MARY EILEEN MYERS

Husband and Wife

of Lake County, and State of Indiana

CONVEY & WARRANT

To: RADOMIR KOVACEVIC and MOMO SIMIC

of Lake County, in the State of Indiana

for the sum of Ten (\$ 10.00) Dollars;

and other good and valuable consideration, the receipt of which is hereby acknowledged; The following described Real Estate, in Lake County, in the State of Indiana, to-wit:

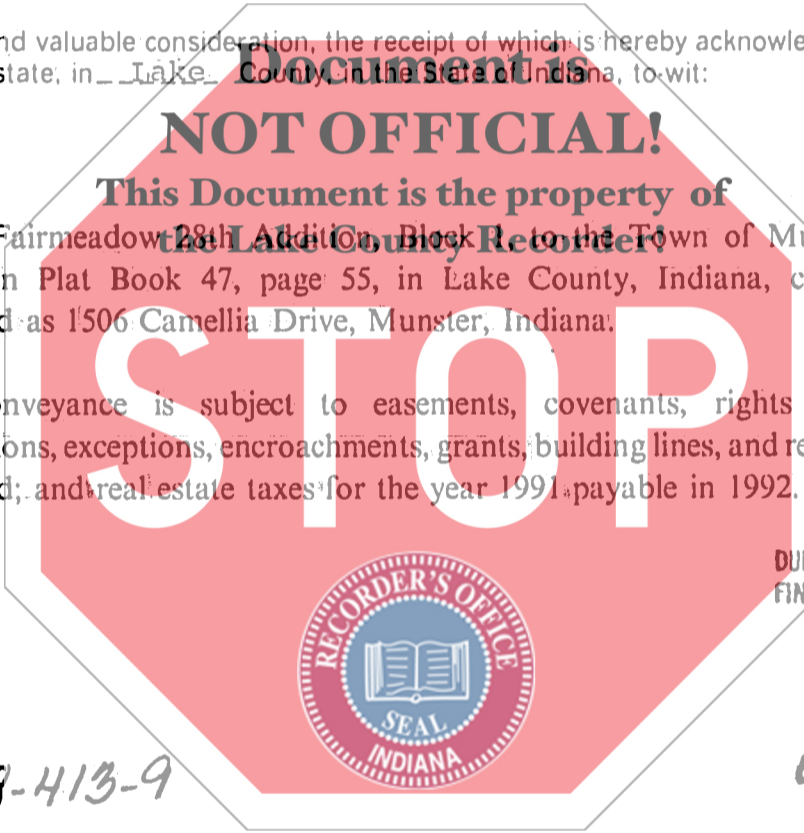

Lot 9, Fairmeadow 28th Addition, Block 1, to the Town of Munster, as shown in Plat Book 47, page 55, in Lake County, Indiana, commonly described as 1506 Camellia Drive, Munster, Indiana.

This conveyance is subject to easements, covenants, rights of way, reservations, exceptions, encroachments, grants, building lines, and restrictions of record; and real estate taxes for the year 1991 payable in 1992.

STATE OF INDIANA/S.S.NO.
LAKE COUNTY
FILED FOR RECORD
MAR 2 1 19 PM '92
ROBERT BUSHNELL
RECORDER

DULY ENTERED FOR TAXATION SUBJECT TO FINAL ACCEPTANCE FOR TRANSFER.

FEB 27 1992

Arno M. Antos
AUDITOR LAKE COUNTY

KEY NO: # 28-413-9

SEND TAX STATEMENTS TO: 9214 Kennedy Avenue; Highland, IN 46322

IN WITNESS WHEREOF, The said: CURTIS DEAN MYERS and MARY EILEEN MYERS,

Husband and Wife

Have hereunto set their Hand s this 20th day of February 1992

State of Indiana Lake County, ss:
Before me, the undersigned, a Notary Public, in and for said County and State, personally appeared the within named Curtis Dean Myers and Mary Eileen Myers,
Husband and Wife
on February 20, 1992
and acknowledged the execution of the foregoing Deed to be their voluntary act and deed, in witness whereof, I have hereunto subscribed my name and affixed my official seal. My commission expires: April 18, 1995

Curtis Dean Myers Seal
Curtis Dean Myers

Mary Eileen Myers Seal
Mary Eileen Myers

----- Seal

----- Seal

Arlene K. Royal
Arlene K. Royal Notary Public
Resident of Lake County

01395
700
u