

3648 Fillmore St.
Gary, IN 46408

QUIT-CLAIM DEED

92010801

This Indenture Witnesseth, That

JAMES R. LANE
3648 FILLMORE ST.
GARY, INDIANA 46408

of LAKE County, in the State of INDIANA

Release and Quit-Claim to JAMES R. LANE AND BARBARA A. LANE, HUSBAND AND WIFE

of LAKE County, in the State of INDIANA, for and in consideration
of ONE DOLLAR (\$1.00)-----Dollars,

and other valuable consideration, the receipt whereof is hereby acknowledged,
the following described Real Estate in LAKE County

in the State of INDIANA, to-wit: 25-178-22

Lot Twenty-two (22), Block Five (5), in Kelley-Glover-Vale Parkside Addition,
in the City of Gary, as shown in Plat Book 18, page 2, Lake County, Indiana,
commonly known as 3648 Fillmore Street, Gary, Indiana.

The Grantee herein accepts this conveyance subject to the following:

1. Real Estate taxes for the year 1991 payable in 1992 and subsequent thereto.
2. Restrictions and limitations, if any, contained in original plat and prior deeds.
3. Easements of record, zoning ordinances, laws and amendments thereto and revisions thereof.
4. Grantee expressly states and acknowledges that Grantee has inspected the above described real estate, together with improvements thereon and that Grantee accepts said property in its present condition and acknowledges that Grantors have made no representations concerning the condition of the said property and/or improvements thereon.

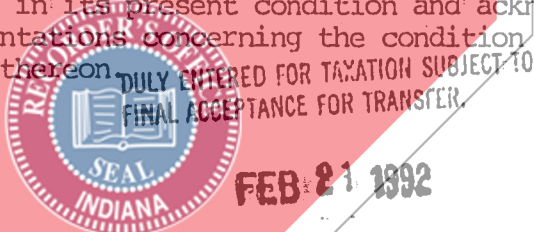
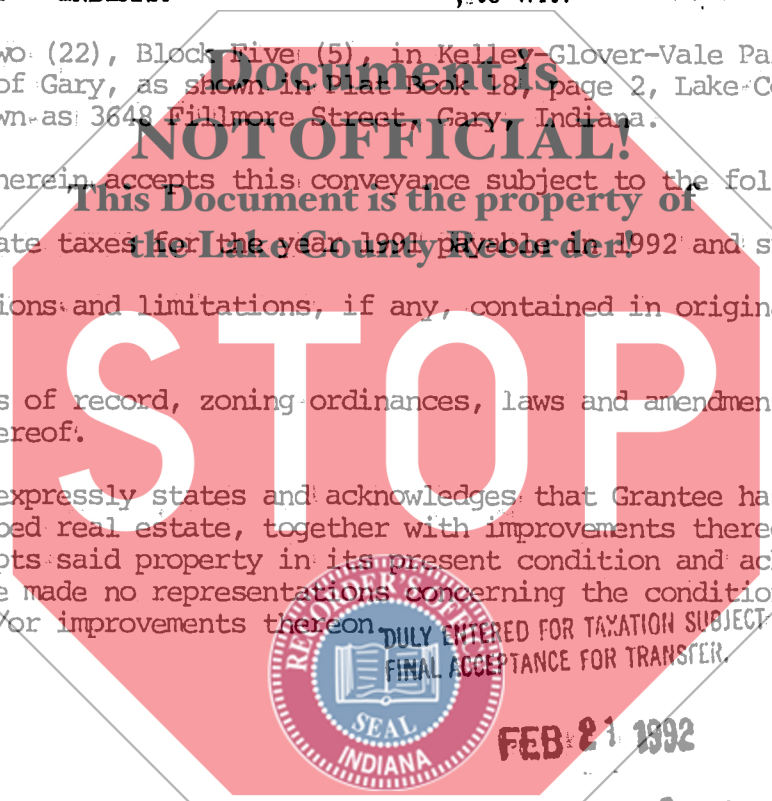

In Witness Whereof. The said

Alex N. Antos
AUDITOR LAKE COUNTY

has hereunto set his hand and seal, this 20th day of February 1992

(Seal) *James R. Lane* (Seal)
JAMES R. LANE

(Seal) _____ (Seal)

(Seal) _____ (Seal)

STATE OF INDIANA, LAKE COUNTY, as:

Before me, the undersigned, a Notary Public in and for said County, this
20th day of FEBRUARY 19 92, came

, and acknowledged the execution of the foregoing instrument.

Witness my hand and official seal.

My Commission expires 4/27/92

George Lapchar
Notary Public
Lake County of Residence

This instrument prepared by: JAMES R. LANE

01141

100