

MAIL TAX STATEMENTS TO: 92002032
4645 Jefferson Place
Gary, Indiana 46408

Warranty Deed

THIS INDENTURE WITNESSETH, That
WA-KO, INC., an Indiana Corporation, Now Known as WASHBURN LAND COMPANY, INC.
by Verne E. Washburn, its President

of Lake County, in the State of Indiana Convey and Warrant
to Edwin Carter and Embry Carter
as joint tenants with rights of survivorship and not as tenants in common

of Lake County, in the State of Indiana, for and in consideration of the sum of

-----TEN (\$10.00) DOLLARS AND OTHER GOOD AND VALUABLE CONSIDERATION-----

the receipt whereof is hereby acknowledged, the following described Real Estate in Lake County,
in the State of Indiana, to-wit:

Key # 47-80-50

Lot 52 in Block 1 in South Broadway Land Co's
Fifth South Broadway Addition to Gary, as per
plat thereof, recorded in Plat Book 9 page 2,
in the Office of the Recorder of Lake County,
Indiana.

Commonly known as 3801 Washington Street, Gary, Indiana 46408

Subject to Taxes for the year 1990, due and payable in 1991, and thereafter.

Grantor certifies that no Indiana Gross Income Tax is due and Payable with
respect to the transfer made by this deed.

**This Document is the property of
the Lake County Recorder!**

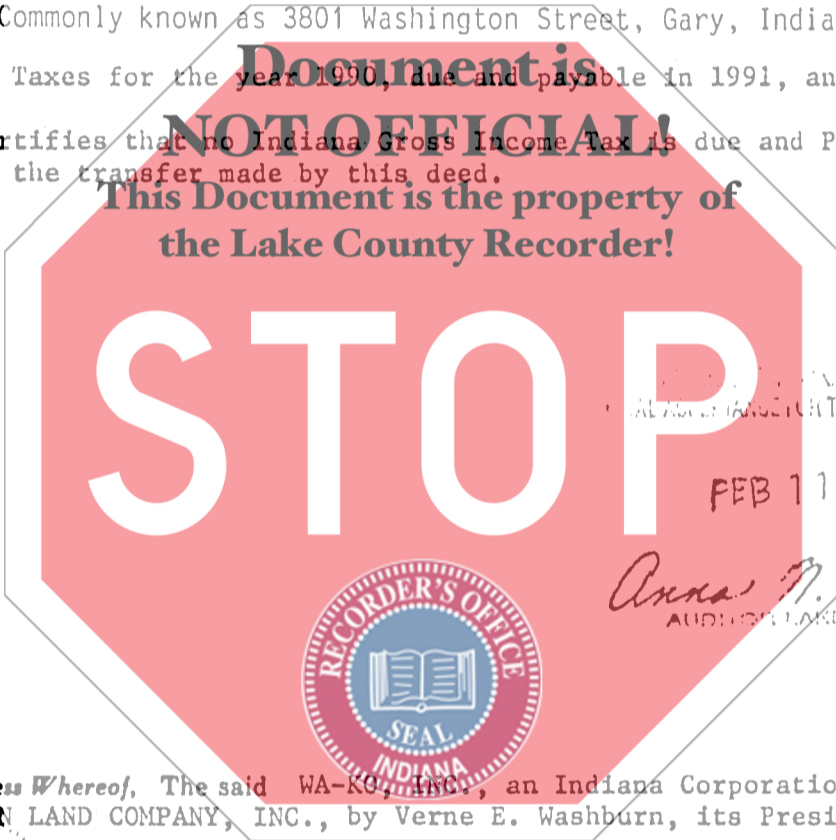

RECORDED SUBJECT TO
MAY 1991 TRANSFER.

FEB 11 1992

Anna N. Antone
AUDITOR LAKE COUNTY



In Witness Whereof, The said WA-KO, INC., an Indiana Corporation, Now Known
as WASHBURN LAND COMPANY, INC., by Verne E. Washburn, its President

has hereunto set its hand and seal, this 6th day of February 19 92

WA-KO, INC., an Indiana Corporation, Now Known
(Seal) As WASHBURN LAND COMPANY, INC. (Seal)

(Seal) By: *Verne E. Washburn* (Seal)
VERNE E. WASHBURN, President



STATE OF INDIANA, LAKE COUNTY, as:

Before me, the undersigned, a Notary Public in and for said County, this

6th day of February 19 92, came

WA-KO, INC., an Indiana Corporation, Now Known as WASHBURN LAND COMPANY, INC.,
by Verne E. Washburn, its President

, and acknowledged the execution of the foregoing instrument.

Witness my hand and official seal.

My Commission expires *Sept. 19, 1992*

Thelma Jean Carter Notary Public
Thelma Jean Carter

This instrument prepared by:
Verne E. Washburn

Resident of Lake County

400 CX