

THIS FORM HAS BEEN APPROVED BY THE INDIANA STATE BAR ASSOCIATION FOR USE BY LAWYERS ONLY. THE SELECTION OF A FORM OF INSTRUMENT, FILLING IN BLANK SPACES, STRIKING OUT PROVISIONS AND INSERTION OF SPECIAL CLAUSES, CONSTITUTES THE PRACTICE OF LAW AND MAY ONLY BE DONE BY A LAWYER.

Mail tax bills to: 92008135
1521 Azalea
Munster, Indiana 46321

Tax Key No.: 28-386-43

Tax Unit 18

WARRANTY DEED

This indenture witnesseth that

WILLIAM J. LUTTRINGER and BETTY E. LUTTRINGER
Husband and Wife

of Lake County in the State of Indiana

Convey and warrant to

LOUIS R. VAUTER and GUSSIE VAUTER
Husband and Wife

of Lake County in the State of Indiana

for and in consideration of Ten Dollars (\$10.00) and other good and valuable consideration the receipt whereof is hereby acknowledged, the following Real Estate in Lake County in the State of Indiana, to wit:

Lot 43, Fairmeadow 23rd Addition to the Town of Munster, as shown in Plat Book 45, Page 21, in Lake County, Indiana

Commonly known as: 1521 Azalea
Munster, Indiana 46321

Subject to all easements and restrictions of record.

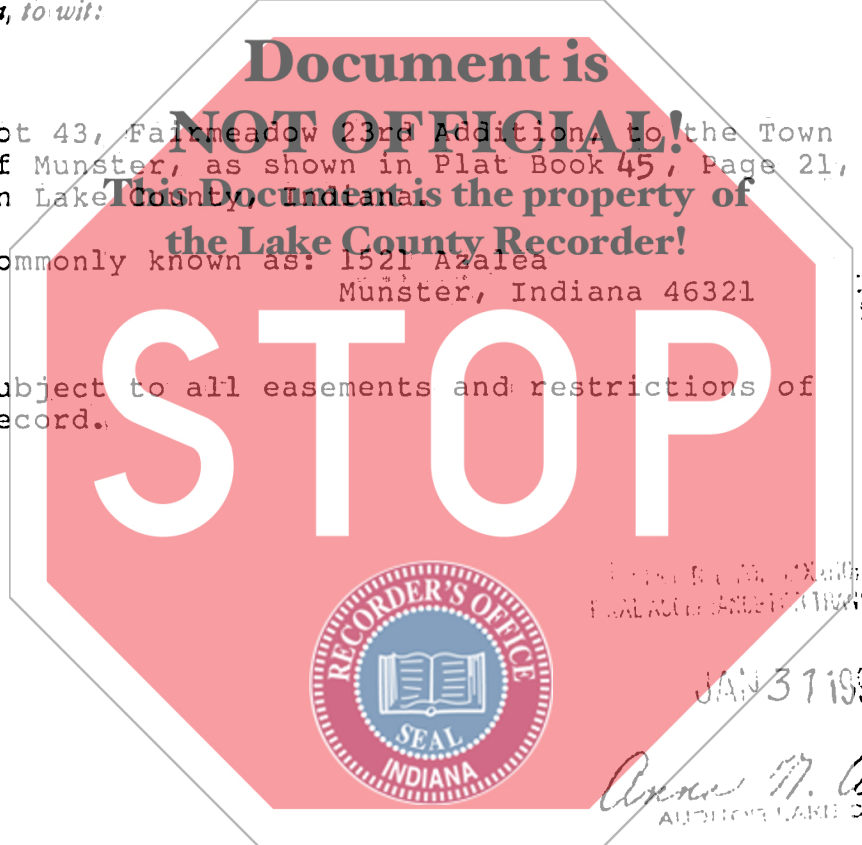

STATE CLERK OF INDIANA
FILED FOR RECORD
FEB 7 10 07 AM '92
ROBERT H. HARRIS, CLERK

EXEMPT FROM EXCISE TAX SUBJECT TO LOCAL AD VALOREM TAX TRANSFER.

JAN 31 1992

Anna M. Antoni
AUDITOR LAKE COUNTY

State of Indiana, Florida County, ss: Sarasota
Before me, the undersigned, a Notary Public in and for said County and State, this 17th day of JANUARY 1992 personally appeared:

WILLIAM J. LUTTRINGER
and
BETTY E. LUTTRINGER

Dated this 17th Day of JANUARY 19 92

William J. Luttringer
WILLIAM J. LUTTRINGER
Betty E. Luttringer
BETTY E. LUTTRINGER

And acknowledged the execution of the foregoing deed. In witness whereof, I have hereunto subscribed my name and affixed my official seal. My commission expires MY COMMISSION EXP. MAR 31, 1993

Notary Public
BONDED THRU GENERAL TRUST UND.

Resident of Sarasota County.

01535

700
CX

This instrument prepared by BARBARA M. SHAVER
905 Ridge Road
Munster, IN 46321

Attorney at Law

CHICAGO TITLE INSURANCE COMPANY
INDIANA DIVISION