

Mail: NATAF

45C01-9102-CP-0434

Mail: Alty Tille  
230 E Ohio St Ste 201  
Evansville 46204

92007394

This Indenture, made this 2nd day of August, A. D. 1991

between Stephen R. Stiglich, Sheriff of Lake County, in the State of Indiana, of the first part and R. F. Norman Corporation f/k/a RCR SERVICES, INC. D/B/A MORTGAGE DEFAULT SERVICES COMPANY

of the County of Lake and State of Indiana of the second part. WITNESSETH:

THAT WHEREAS, At the Continuous Term of the Lake Circuit Court A. D. 1991

R. F. Norman Corporation f/k/a RCR SERVICES, INC. D/B/A MORTGAGE DEFAULT SERVICES COMPANY

recovered by judgment of said Court, in a certain action therein against CRAIG M. LEAVY, JERI D. LEAVY and USA FINANCIAL SERVICES INC.

the sum of Thirty-Nine Thousand Seven Hundred Eighty Dollars and Forty-Three Cents, for its damages, together with the further sum of Thirteen Dollars and No Cents, for its costs in that behalf expended; and

a decree for the sale of all the interest, estate, right and title of the defendant CRAIG M. LEAVY, JERI D. LEAVY and USA FINANCIAL SERVICES INC.

in and to certain Real Estate, described therein as follows, to wit: LOTS 45 AND 46, BLOCK 18, GREAT GARY REALTY COMPANY'S FIRST ADDITION, CITY OF GARY, AS SHOWN IN PLAT BOOK 11, PAGE 8, LAKE COUNTY, INDIANA. (Commonly known as: 3802 Martin Luther King Drive, Gary, IN 46409)

2

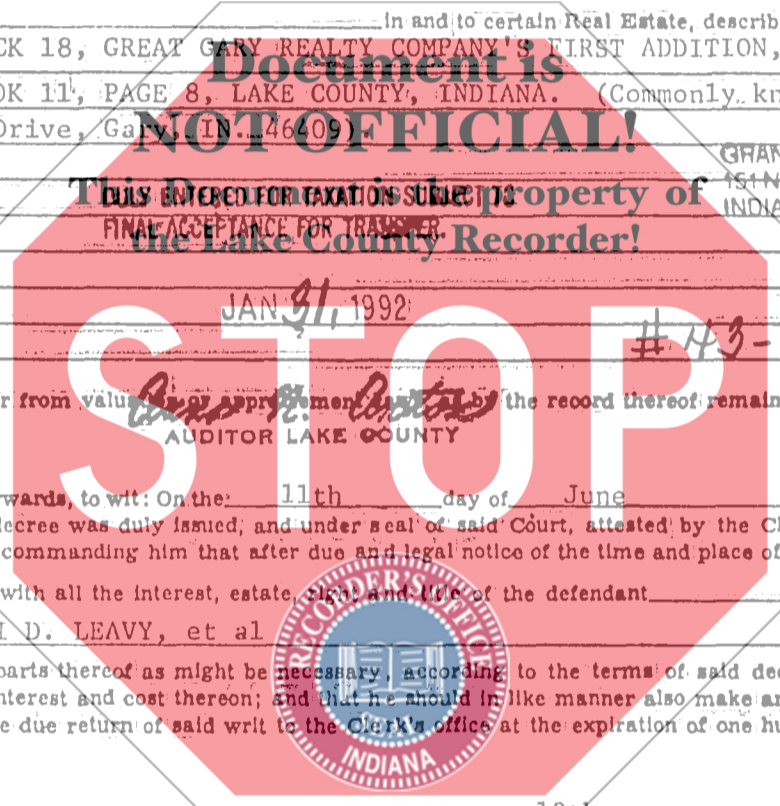

GRANTEE ADDRESS  
151 N DELAWARE  
INDIANAPOLIS IN 46204

All without any relief whatever from value, and the same to be recorded in said Court more fully appears.

AND WHEREAS, Afterwards, to wit: On the 11th day of June, A. D. 1991

a copy of said judgment and decree was duly issued, and under seal of said Court, attested by the Clerk thereof; directed to the Sheriff of the County of Lake, commanding him that after due and legal notice of the time and place of making the same, he should sell the land above described, with all the interest, estate, right and title of the defendant

CRAIG M. LEAVY, JERI D. LEAVY, et al

therein, or so much and such parts thereof as might be necessary, according to the terms of said decree, to pay and satisfy the judgment aforesaid, with the interest and cost thereon; and that he should in like manner also make and return all interest and accruing costs thereon, and make due return of said writ to the Clerk's office at the expiration of one hundred and eighty days from the date of the same.

AND WHEREAS Said copy of judgment and order of sale, on the 12th day of June, A. D. 1991

came to the hands of Stephen R. Stiglich then the Sheriff of said County, to be executed, and the said Stephen R. Stiglich as said Sheriff as aforesaid, having legally advertised the same, did on the 2nd

day of August, A. D. 1991, at the Court House door in Crown Point in the County aforesaid, between the hours prescribed by law, at public auction, expose to sale the rents, profits, issues and income, of said estate of CRAIG M. LEAVY, JERI D. LEAVY and USA FINANCIAL SERVICES INC.

together with all the rights, title and interest in fee simple of the said CRAIG M. LEAVY, JERI D. LEAVY, et al in and to said estate, and the said R. F. Norman Corporation f/k/a RCR SERVICES, INC. D/B/A MORTGAGE DEFAULT SERVICES COMPANY

did then and there bid the sum of Thirty-Nine Thousand Seven Hundred Ninety-Three Dollars and Forty-Three Cents, and no person bidding more, the same was in due form openly struck off and sold to the said R. F. Norman Corporation f/k/a RCR SERVICES, INC. D/B/A MORTGAGE DEFAULT SERVICES COMPANY

for the said sum of Thirty-Nine Thousand Seven Hundred Ninety-Three Dollars and Forty-Three Cents its being

the highest bidder, and that being the highest price bid for the same

01635  
900  
E

NOW THEREFORE, to confirm to said R. F. Norman Corporation f/k/a RCR SERVICES, INC.  
D/B/A MORTGAGE DEFAULT SERVICES COMPANY

the sale so made as aforesaid, the said Stephen R. Stiglich

as Sheriff as aforesaid, in consideration of said sum of Thirty-Nine Thousand Seven Hundred Ninety-Three  
Dollars and Forty-Three Cents, to him in hand paid by said

R. F. Norman Corporation f/k/a RCR SERVICES, INC., D/B/A MORTGAGE DEFAULT SERVICES  
COMPANY

the receipt whereof is hereby acknowledged, as

provided by law hath **GRANTED, BARGAINED AND SOLD**, and doth by these presents **GRANT, BARGAIN, SELL, CONVEY AND**  
**CONFIRM** to the said R. F. Norman Corporation f/k/a RCR SERVICES, INC. D/B/A MORTGAGE DEFAULT SERVICES heirs and assigns **FOREVER**, all the following

Real Estate situate in the County of Lake and State of Indiana, to wit:  
LOTS 45 AND 46, BLOCK 18, GREAT GARY REALTY COMPANY'S FIRST ADDITION, CITY OF GARY,  
AS SHOWN IN PLAT BOOK 11, PAGE 8, LAKE COUNTY, INDIANA. (Commonly known as: 3802  
Martin Luther King Drive, Gary, IN. 46409).



TO HAVE AND TO HOLD, All and singular, the premises aforesaid, with the privileges and appurtenances, to the said  
R. F. Norman Corporation f/k/a RCR SERVICES, INC. D/B/A MORTGAGE DEFAULT SERVICES COMPANY heirs and assigns, forever, in as full  
and ample a manner as the same was held by CRAIG M. LEAVY, JERI D. LEAVY, et al

Immediately before the execution of the mortgage mentioned in said decree, foreclosing the same.

IN WITNESS WHEREOF, The said Stephen R. Stiglich as Sheriff as aforesaid, has hereunto set  
his hand and seal, the day and year above written.

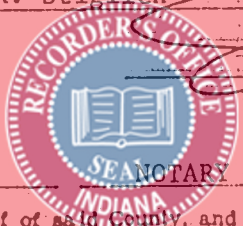

(Seal)  
Sheriff Lake County, Indiana.

State of Indiana, Lake County, ss:  
BEFORE ME, DONNA M. GILLAM Notary Public, in and for said County, personally  
came Stephen R. Stiglich Sheriff of said County, and acknowledged the foregoing conveyance to be his  
voluntary act and deed as such Sheriff.

IN WITNESS WHEREOF, I hereunto subscribe my name, and affix my official seal of office, this

2nd day of August A. D. 19 91

My Comm. Expires  
January 30, 1995.

Donna M. Gillam  
DONNA M. GILLAM - LAKE COUNTY

THIS INSTRUMENT PREPARED BY DONNA M. GILLAM

Stephen R. Stiglich Sheriff of Lake County	TO	R. F. Norman Corporation 151 N. Delaware Indianapolis, In. 46204	<b>DEED ON DECREE</b>	Received for Record	This _____ day of _____, at _____ o'clock _____ M.	and recorded in Record _____ page _____	Recorder for Lake County	Duly Entered for Taxation _____	Auditor _____
---	----	--	-----------------------	---------------------	--	---	--------------------------	---------------------------------	---------------

Return to: NMAF  
230 E. Ohio, # 201  
Indpls, IN 46204

B.0152-91