

*Nada*

92004814

# QUIT-CLAIM DEED

**This Indenture Witnesseth,** That Terry Buchmeier and Janice C. Buchmeier, husband and wife

of LAKE County, in the State of INDIANA

Release and Quit-Claim to the Board of County Commissioners

of LAKE County, in the State of INDIANA, for and in consideration of \$10.00-----Dollars,

and other valuable consideration, the receipt whereof is hereby acknowledged, the following described Real Estate in LAKE County in the State of INDIANA, to-wit:



ROBERT (BOB) STEWART  
RECORDER

JAN 24 10 15 AM '92

*In Witness Whereof.* The said Terry Buchmeier and Janice C. Buchmeier, husband and wife,

have hereunto set their hands and seals, this 23rd day of December 19 91

*Terry Buchmeier* (Seal) *Janice C. Buchmeier* (Seal)  
TERRY BUCHMEIER JANICE C. BUCHMEIER

\_\_\_\_ (Seal) \_\_\_\_\_ (Seal)

\_\_\_\_ (Seal) \_\_\_\_\_ (Seal)

STATE OF INDIANA, COUNTY, ss:

Before me, the undersigned, a Notary Public in and for said County, this 23rd day of December 1991, came

, and acknowledged the execution of the foregoing instrument.

Witness my hand and official seal.

My Commission expires January 6, 1993

*Charles F. Van Nada* Notary Public  
Charles F. Van Nada

This instrument prepared by: MARK THIRO, Resident of Lake County  
Asst. County Attorney

Terry Buchmeier and Janice C.  
Buchmeier

SPLIT FROM KEY 1-50-10 TO KEY 1-50-22.

A part of the Southeast quarter (¼) of Section thirty-six (36),  
Township thirty-three (33) North Range ten (10) West, further  
described as follows:

Beginning at a point two thousand nine hundred eighty-six and thirty-  
nine hundredths (2986.39) feet North ninety degrees zero minutes zero  
seconds (90°00'00") East (all bearings assumed) from the Southwest corner  
of the Southwest quarter (¼) of Section thirty-six (36), Township thirty-  
three (33) North, Range ten (10) West; thence North zero degrees eleven  
minutes fifty-six seconds (00°11'56") West for a distance of twenty and  
zero hundredths (20.00) feet; thence North eighty-one degrees seventeen  
minutes fifty-four seconds (81°17'54") East for a distance of fifty and  
fifty-eight hundredths (50.58) feet; thence North eighty-eight degrees  
zero minutes forty seconds (88°00'40") East for a distance of one hundred  
sixty and ten hundredths (160.10) feet; thence North eighty-one degrees  
sixteen minutes thirteen seconds (81°16'13") East for a distance of one  
hundred one and seventeen hundredths (101.17) feet; thence South eighty-  
six degrees thirty-seven minutes twenty-one seconds (86°37'21") East for  
a distance of two hundred forty and forty-two hundredths (240.42) feet;  
thence South seventy-eight degrees twenty-three minutes thirty-eight seconds  
(78°23'38") East for a distance of seventy-one and forty-six hundredths  
(71.46) feet; thence South zero degrees eleven minutes fifty-six seconds  
(00°11'56") East for a distance of twenty and zero hundredths (20.00) feet;  
thence South ninety degrees zero minutes zero seconds (90°00'00") West for  
a distance of six hundred twenty and zero hundredths (620.00) feet to the  
point of beginning and containing five hundred five thousandths (0.505)  
acres, more or less, in West Creek Township, Lake County, Indiana.



MINIMUM PAYMENT - TEMPORARY R/W

PROJECT: Lake Co. 76

PARCEL: 1A & 1B

ROAD: 197th Ave.

AGREEMENT

I, the undersigned property owner, agree to grant to Lake County, Indiana, temporary right of way as described on the attached legal description for Parcel 1A and 1B and/or other valuable considerations, without any undue coercive action of any nature.

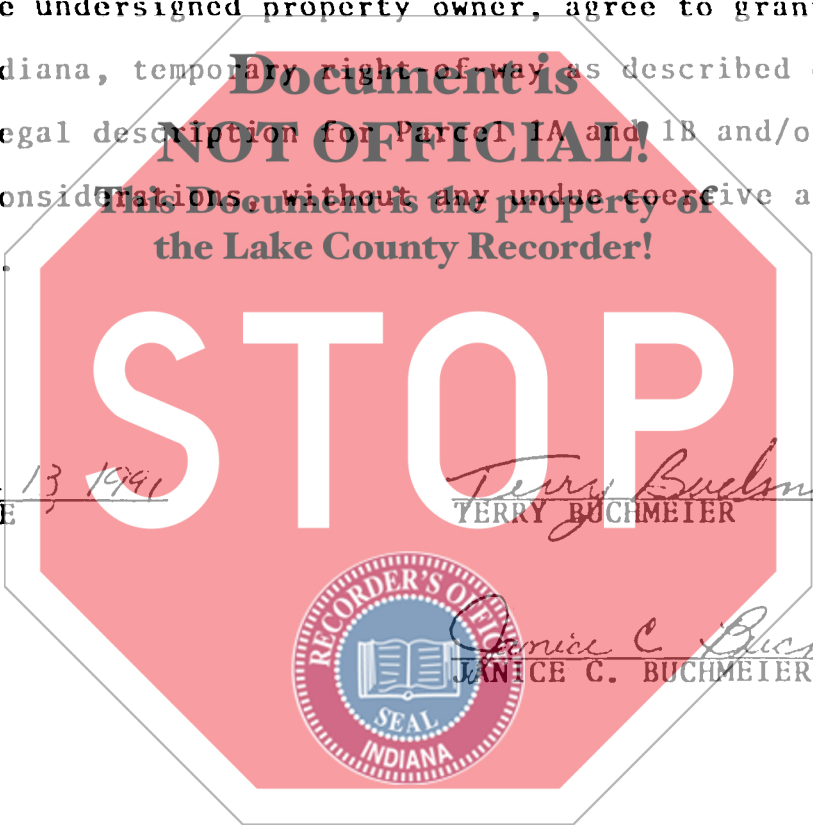

DECEMBER 13 1991  
DATE

Terry Buchmeier  
TERRY BUCHMEIER



Janice C. Buchmeier  
JANICE C. BUCHMEIER

Parcel 1A - Terry Buchmeier and Janice C. Buchmeier

Beginning at a point two thousand nine hundred eighty-six and thirty-nine hundredths (2986.39) feet North ninety degrees zero minutes zero seconds ( $90^{\circ}00'00''$ ) East and twenty and zero hundredths (20.00) feet North zero degrees eleven minutes fifty-six seconds ( $00^{\circ}11'56''$ ) West and fifty and fifty-eight hundredths (50.58) feet North eighty-one degrees seventeen minutes fifty-four seconds ( $81^{\circ}17'54''$ ) East and one hundred sixty and ten hundredths (160.10) feet North eighty-eight degrees zero minutes forty seconds ( $88^{\circ}00'40''$ ) East from the Southwest corner of the Southwest quarter of Section thirty-six (36), Township thirty-three (33) North, Range ten (10) West; thence North thirty-five degrees thirty-six minutes twenty-seven seconds ( $35^{\circ}36'27''$ ) East for a distance of forty-two and ninety-four hundredths (42.94) feet; thence North eighty-nine degrees forty-eight minutes four seconds ( $89^{\circ}48'04''$ ) East for a distance of twenty-five and zero hundredths (25.00) feet; thence South twenty-one degrees eleven minutes thirty-seven seconds ( $21^{\circ}11'37''$ ) East for a distance of twenty-seven and sixty-six hundredths (27.66) feet; thence South eighty-one degrees sixteen minutes thirteen seconds ( $81^{\circ}16'13''$ ) West for a distance sixty and seventy hundredths (60.70) feet to the point of beginning and containing twenty-nine thousandths (0.029) acres, more or less, in West Creek Township, Lake County, Indiana.



Parcel 1B - Terry Buchmeier and Janice C. Buchmeier

Beginning at a point three thousand six hundred six and thirty-nine hundredths (3606.39) feet North ninety degrees zero minutes zero seconds (90°00'00") East and North zero degrees eleven minutes fifty-six seconds (00°11'56") West and seventy-one nad forty-six hundredths (71.46) feet North seventy-eight degrees twenty-three minutes thirty-eight seconds (78°23'38") West and one hundred sixty-five and twenty-nine hundredths (165.29) feet North eighty-six degrees thirty-seven minutes twenty-one seconds (86°37'21") West from the Southwest corner of the Southwest quarter (¼) of Section thirty-six (36), Township thirty-three (33) North, Range ten (10) West; thence North eighty-six degrees thirty-seven minutes twenty-one seconds (86°37'21") West for a distance of forty-five and eight hundredths (45.08) feet; thence North twenty-eight degrees forty-six minutes twenty-four seconds (28°46'24") East for a distance of twenty and seventy-eight hundredths (20.78) feet; thence North eighty-nine degrees forty-eight minutes four seconds (89° 48'04") East for a distance of twenty-five and zero hundredths (25.00) feet; thence South twenty-five degrees thirty minutes twenty-one seconds (25°30'21") East for a distance of twenty-three and twenty-two hundredths (23.22) feet to the point of beginning and containing sixteen thousandths (0.016) acres, more or less, in West Creek Township, Lake County, Indiana.

