

FA-4716

THIS FORM HAS BEEN APPROVED BY THE INDIANA STATE BAR ASSOCIATION FOR USE BY LAWYERS ONLY. THE SELECTION OF A FORM OF INSTRUMENT, FILLING IN BLANK SPACES, STRIKING OUT PROVISIONS AND INSERTION OF SPECIAL CLAUSES, CONSTITUTES THE PRACTICE OF LAW AND MAY ONLY BE DONE BY A LAWYER.

Mail tax bills to: **92003593**

Tax Key No.: 33-41-18
33-41-19

1131 Truman Street
Hammond, Indiana 46320

WARRANTY DEED

This indenture witnesseth that DON A. WHITTMAN AND BRENDA C. WHITTMAN, husband and wife,
as Tenants by the entireties

Return to:
First American Title Insurance Company
5265 Commerce Drive
Crown Point, Indiana 46307

of _____ County in the State of _____

Convey and warrant to ROBERT M. GEE AND LOIS J. GEE, husband and wife

of _____ County in the State of _____
for and in consideration of TEN (\$10.00) DOLLARS and all other good and valuable consideration
the receipt whereof is hereby acknowledged, the following Real Estate in
in the State of Indiana, to wit:

STATE OF INDIANA
FILED
JAN 17 3 22 PM '92
ROBERT M. GEE AND LOIS J. GEE
RECORDED

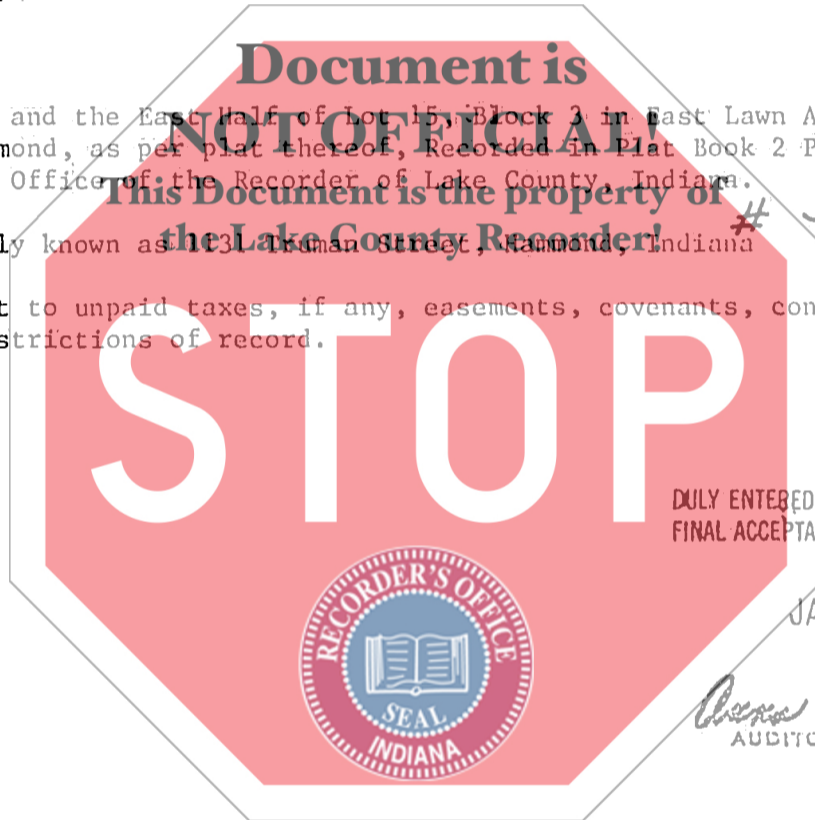

Lot 16 and the East Half of Lot 15, Block 3 in East Lawn Addition
to Hammond, as per plat thereof, Recorded in Plat Book 2 Page 75,
in the Office of the Recorder of Lake County, Indiana.

Commonly known as 1131 Truman Street, Hammond, Indiana

Subject to unpaid taxes, if any, easements, covenants, conditions
and restrictions of record.

33-41-18

DULY ENTERED FOR TAXATION; SUBJECT TO
FINAL ACCEPTANCE FOR TRANSFER.

JAN 13 1992

Gene M. Antos
AUDITOR LAKE COUNTY

State of ~~Indiana~~ South Carolina,
Anderson County, ss:
Before me, the undersigned, a Notary Public in and for said County
and State, this 2nd day of JANUARY 1992
personally appeared:

DON A. WHITTMAN AND BRENDA C. WHITTMAN

Dated this 2nd Day of JANUARY 1992

Don A. Whitman
DON A. WHITTMAN

Brenda C. Whitman
BRENDA C. WHITTMAN

And acknowledged the execution of the foregoing deed. In witness
whereof, I have hereunto subscribed my name and affixed my of-
ficial seal. My commission expires 6/19 1995

Jane T. Hamby
Jane T. Hamby
Notary Public
Resident of Anderson County, S.C.

This instrument prepared by William T. Enslin, ENSLEN, ENSLEN & MATTHEWS
142 Rimbach, Hammond, Indiana 46320 (219) 931-1700

00566
Attorney at Law