

92002324

1 Ronson Rd
Bldg 4027

62103321

ASSIGNMENT OF REAL ESTATE MORTGAGE

Iselin NJ

08830-9912

KNOW-ALL MEN BY THESE PRESENTS:
MARGARETTEN & COMPANY, INC.

a corporation organized and existing under and by virtue of the laws of the State of New Jersey and authorized to do business in Indiana and having its principal office and place of business in the City of Perth Amboy, State of New Jersey

party of the first part, for value received, has granted, bargained, sold, assigned, transferred, and set over, and by these presents does grant, sell, assign, bargain, transfer, and set over unto:

GE CAPITAL MORTGAGE SERVICES, INC.
2339 ROUTE 70, WEST, CHERRY HILL, NEW JERSEY 08034-0455

party of the second part, its successors and assigns, a certain indenture of mortgage dated the day of July 1991 made by:

22nd

STEVAN TODORCEVIC, AND IRENE M TODORCEVIC, HIS WIFE
2122 RIDGE RD, HIGHLAND, IN 46322

to it, securing the payment of one promissory note therein described for the sum of Seventy-Six Thousand, Seven Hundred Eight and 00/100 Dollars (\$ 76,708.00) and all right, title, and interest in and to the premises situated in the County of LAKE and State of Indiana and described in said mortgage as follows:
to wit: LOT 1 IN JANSEN'S ADDITION TO THE TOWN OF HIGHLAND, AS PER PLAT THEREOF, RECORDED IN PLAT BOOK 70 PAGE 35, IN THE OFFICE OF THE RECORDER OF LAKE COUNTY, INDIANA.

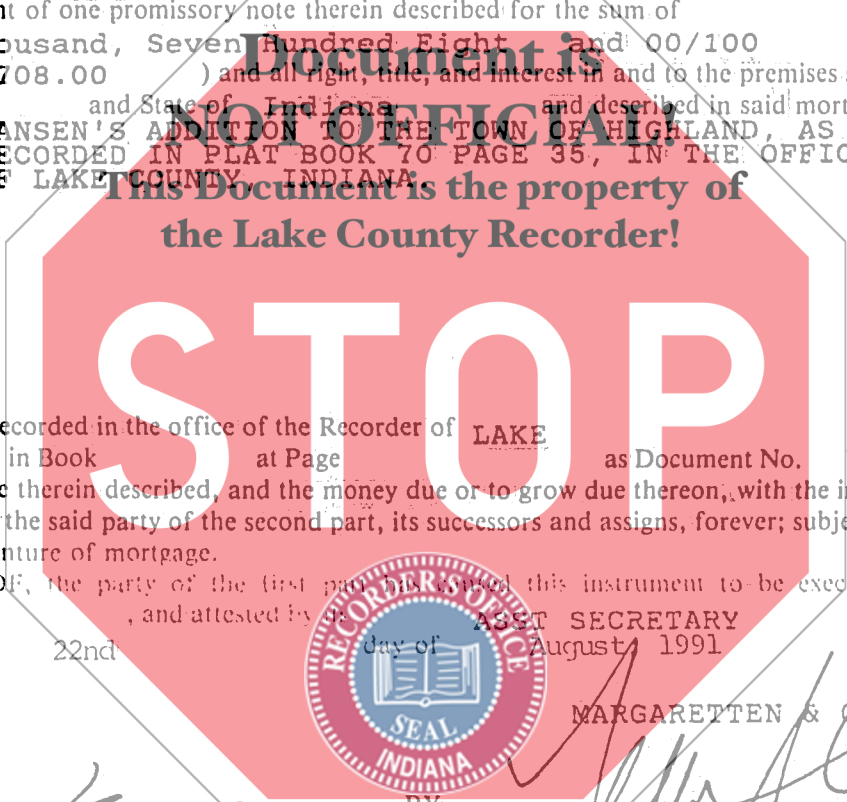

Which said mortgage is Recorded in the office of the Recorder of LAKE County, in the State of Indiana, in Book at Page as Document No. 91-037809 together with the said note therein described, and the money due or to grow due thereon, with the interest: TO HAVE AND TO HOLD the same unto the said party of the second part, its successors and assigns, forever; subject only to the provisions contained in the said indenture of mortgage.

IN WITNESS WHEREOF, the party of the first part has caused this instrument to be executed in its name by its ASST VICE PRESIDENT and attested by its ASST SECRETARY and its corporate seal to be hereunto affixed this 22nd day of August, 1991

ATTEST (SEAL)

Ann Martini
ASST SECRETARY
ANN MARTINI

ASSISTANT

Terry L. Gibbs
VICE PRESIDENT
TERRI L. GIBBS

STATE OF NEW JERSEY
COUNTY OF MIDDLESEX

ss:

I, the undersigned, a Notary Public in and for the County and State aforesaid, DO HEREBY CERTIFY that the persons whose names are subscribed to the foregoing instrument are personally known to me to be duly authorized officers of MARGARETTEN & COMPANY, INC. and personally known to me to be the same persons whose names are subscribed to the foregoing instrument as such officers, appeared before me this day in person and acknowledged that they signed and delivered the said instrument as their free and voluntary act and as the free and voluntary act of said corporation, for the uses and purposes therein set forth, and the said ASSISTANT SECRETARY did also then and there acknowledge that he/she/they as custodian of the seal of said corporation did affix the said corporate seal to said instrument as his/her/their own free and voluntary act and as the free and voluntary act of said corporation, for the uses and purposes therein set forth.

Given under my hand and notarial seal this 16th day of August, 1991

PREPARED BY: ANN MARTINI
MARGARETTEN & COMPANY, INC.
One Ronson Road
Iselin, New Jersey 08830

Teresa Garrander
NOTARY PUBLIC