

162312

Lucas - Highland

THIS FORM HAS BEEN APPROVED BY THE INDIANA STATE BAR ASSOCIATION FOR USE BY LAWYERS ONLY. THE SELECTION OF A FORM OF INSTRUMENT, FILLING IN BLANK SPACES, STRIKING OUT PROVISIONS AND INSERTION OF SPECIAL CLAUSES, CONSTITUTES THE PRACTICE OF LAW AND MAY ONLY BE DONE BY A LAWYER.

Mall tax bills to:

Tax Key No. \_\_\_\_\_

3448 Condit St  
Highland, IN 46322

# WARRANTY DEED

This indenture witnesseth that  
**91052579**

PHILIP E. WARNECKE, GREGORY W. WARNECKE, CURTIS W. WARNECKE, by their attorney-in-fact, Michelle N. Stephen a/k/a Michele M. Stephen, MICHELLE N. STEPHEN a/k/a MICHELE M. STEPHEN, and SHARON G. WARNECKE, as joint tenants with rights of survivorship  
County in the State of Indiana

of LAKE  
Convey and warrant to

MARK S. RICHWALSKI and SHIRLEY A. RICHWALSKI,  
Husband and Wife

of Lake County in the State of Indiana  
for and in consideration of Ten Dollars (\$10.00) and other good and valuable consideration the receipt whereof, is hereby acknowledged, the following Real Estate in Lake County in the State of Indiana, to wit:  
3448 Condit Street, Highland, IN 46322

Lot 1 in Block 2 in Douthett's Addition to Highland, as per plat thereof, recorded in Plat Book 11 page 27, in the Office of the Recorder of Lake County, Indiana.

This Document is the property of  
the Lake County Recorder

Subject to existing taxes, easements, covenants and restrictions of record.

Subject to any statements of fact or description on a mortgage location plat, legal survey or stake survey.

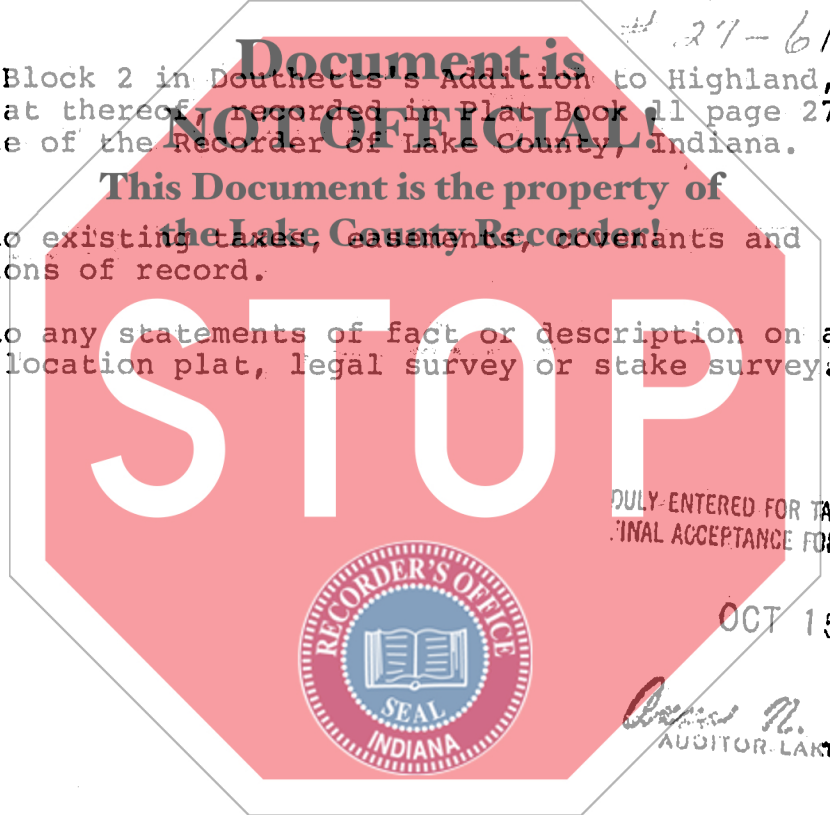

DULY ENTERED FOR TAXATION SUBJECT TO FINAL ACCEPTANCE FOR TRANSFER.

OCT 15 1991

Robert N. Antonio  
AUDITOR LAKE COUNTY

State of Indiana, Lake County, ss:  
Before me, the undersigned, a Notary Public in and for said County and State, this 30th day of September 1991 personally appeared:

PHILIP E. WARNECKE, GREGORY W. WARNECKE, CURTIS W. WARNECKE, by their attorney in fact Michelle N. Stephen a/k/a Michele M. Stephen, MICHELLE N. STEPHEN a/k/a MICHELE M. STEPHEN, and SHARON G. WARNECKE as joint tenants with rights of survivorship

And acknowledged the execution of the foregoing deed. In witness whereof, I have hereunto subscribed my name and affixed my official seal. My commission expires 1-24 1995

*Linda J. McBride*  
Linda J. McBride Notary Public

Resident of Lake County.

Dated this 30th Day of September 1991

*Philip E. Warnicke* *atly in fact*  
*Michelle N. Stephen* *atly in fact*  
Philip E. Warnicke, by Michelle N. Stephen a/k/a Michele M. Stephen  
*Gregory W. Warnicke* *atly in fact*  
*Michelle N. Stephen* *atly in fact*  
Gregory W. Warnicke, by Michelle N. Stephen a/k/a Michele M. Stephen  
*Curtis W. Warnicke* *atly in fact*  
*Michelle N. Stephen* *atly in fact*  
Curtis W. Warnicke by Michelle N. Stephen a/k/a Michele M. Stephen  
*Sharon G. Warnicke*  
Michelle N. Stephen a/k/a Michele M. Stephen  
Sharon G. Warnicke

This instrument prepared by JOHN M. RHAME, III, 2684 Willowcreek Road, Portage, IN Attorney at Law