

THIS FORM HAS BEEN APPROVED BY THE INDIANA STATE BAR ASSOCIATION FOR USE BY LAWYERS ONLY. THE SELECTION OF A FORM OF INSTRUMENT, FILLING IN BLANK SPACES, STRIKING OUT PROVISIONS AND INSERTION OF SPECIAL CLAUSES, CONSTITUTES THE PRACTICE OF LAW AND MAY ONLY BE DONE BY A LAWYER.

Mail tax bills to: 1801 West 58th Avenue, Merrillville, IN 46410

Tax Key No.: _____

91050655

WARRANTY DEED

STATE OF INDIANA
FILED
OCT 1 10 55 AM '91
ROBERT [unclear] AND

This indenture witnesseth that FREDERICK WHITWORTH

of Lake County in the State of Indiana

Convey and warrant to FREDERICK WHITWORTH, as Trustee under the provisions of a written trust agreement dated the 23rd day of September, 1991

of Lake County in the State of Indiana

for and in consideration of TEN DOLLARS (\$10.00) and other good and valuable consideration the receipt whereof is hereby acknowledged, the following Real Estate in Lake County in the State of Indiana, to wit:

Lot 36, in Block "A", as marked and laid down on the recorded plat of Country Club Addition to Gary Unit "A", being a subdivision in part of the East Half of the East Half of Section 5, Township 35 North, Range 8 West of the 2nd P.M., including a resubdivision of Country Club Addition of Gary, in Lake County, Indiana, as the same appears of record in Plat Book 24, page 59, in the Recorder's Office of Lake County, Indiana

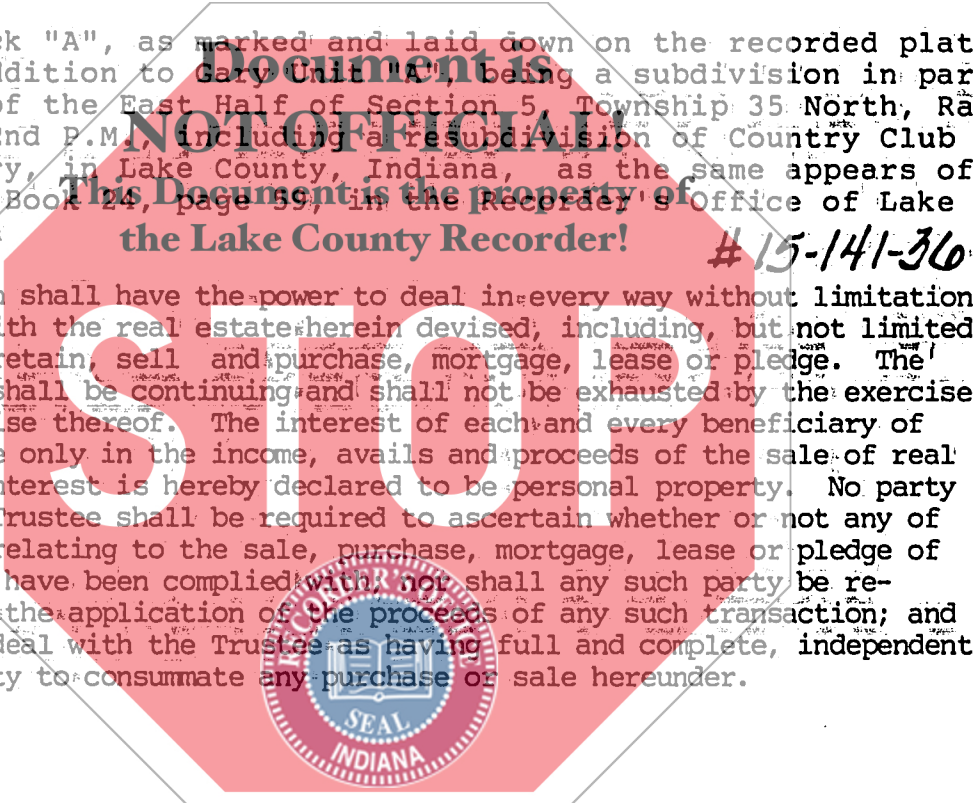

#15-141-36

The Grantee herein shall have the power to deal in every way without limitation or restriction with the real estate herein devised, including, but not limited to, the power to retain, sell and purchase, mortgage, lease or pledge. The foregoing powers shall be continuing and shall not be exhausted by the exercise or repeated exercise thereof. The interest of each and every beneficiary of the trust shall be only in the income, avails and proceeds of the sale of real estate and said interest is hereby declared to be personal property. No party dealing with the Trustee shall be required to ascertain whether or not any of the requirements relating to the sale, purchase, mortgage, lease or pledge of any real property have been complied with, nor shall any such party be required to look to the application of the proceeds of any such transaction; and such parties may deal with the Trustee as having full and complete, independent power and authority to consummate any purchase or sale hereunder.

State of Indiana, LAKE County, ss:
Before me, the undersigned, a Notary Public in and for said County and State, this 23rd day of September 19 91 personally appeared:
FREDERICK WHITWORTH

Dated this 23rd Day of September 1991

Fredrick Whitworth
FREDERICK WHITWORTH

DULY ENTERED FOR TAXATION SUBJECT TO FINAL ACCEPTANCE FOR TRANSFER.

OCT 3 1991

Robert R. [unclear]
ADDITION LAKE COUNTY

And acknowledged the execution of the foregoing deed. In witness whereof, I have hereunto subscribed my name and affixed my official seal. My commission expires December 28, 1992

Donald R. O'Dell
Donald R. O'Dell Notary Public

Resident of Lake County.

This instrument prepared by Donald R. O'Dell Attorney at Law
P.O. Box 128, Lowell, IN 46356

MAIL TO: