

THIS FORM HAS BEEN APPROVED BY THE INDIANA STATE BAR ASSOCIATION FOR USE BY LAWYERS ONLY. THE SELECTION OF A FORM OF INSTRUMENT, FILLING IN BLANK SPACES, STRIKING OUT PROVISIONS AND INSERTION OF SPECIAL CLAUSES, CONSTITUTES THE PRACTICE OF LAW AND MAY ONLY BE DONE BY A LAWYER.

MAIL TAX BILLS TO: 91041420

TAX KEY NO. 14-101-26

David A. Henry,
c/o The Henry Company, Inc.
P.O. Box 2045
Hammond, IN 46323

QUIT-CLAIM DEED

This indenture witnesseth that HOLLY N. VANVLECK

of LAKE County in the State of INDIANA

Releases and quit claims to DAVID A. HENRY

of LAKE County in the State of INDIANA
for and in consideration of Ten Dollars (\$10.00) and other good and valuable consideration
the receipt whereof is hereby acknowledged, the following Real Estate in Lake County
in the State of Indiana, to wit:

The East 200 feet of the West 400 feet of the North 145 feet of the West 655.74 feet, except the North 25 foot road easement, of that part of the Southeast Quarter of the Northeast Quarter lying North of the right of way of the M.C.R.R. in Section Seven (7), Township Thirty-Five (35) North, Range Nine (9) West of the 2nd Principal Meridian, all in Lake County, Indiana.

Commonly known as: 1420 - 215th Street
Dyer, Indiana 46311

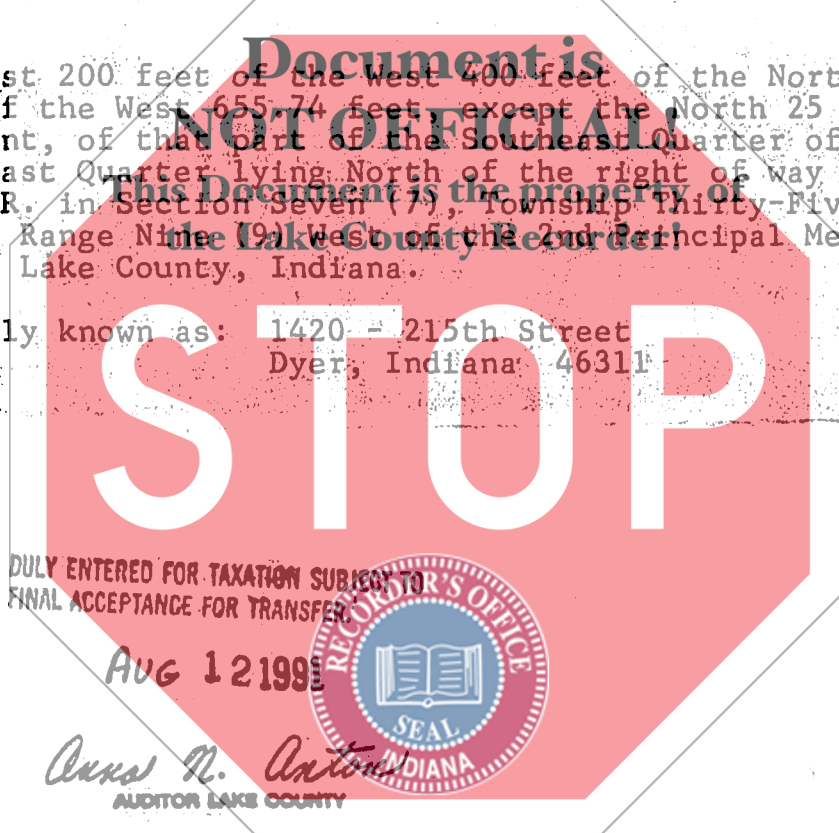

STATE OF INDIANA
LAKE COUNTY
FILED FOR RECORD
AUG 15 10:07 AM '91
ROBERT (BOB) FREELAND
RECORDER

Anna N. Anton
AUDITOR LAKE COUNTY

State of Indiana, Lake County, ss:
Before me, the undersigned, a Notary Public in and for said County and State, this 31st day of July 19 91
personally appeared:

HOLLY N. VANVLECK

Dated this 31st Day of July 19 91

Holly N. VanVleck
HOLLY N. VANVLECK

And acknowledged the execution of the foregoing deed. In witness whereof, I have hereunto subscribed my name and affixed my official seal. My commission expires 1-23-92 19

Sandra J. Reagan
Sandra J. Reagan
Notary Public

Resident of Lake County

This instrument prepared by Andrew J. Fetsch, Beckman, Kelly & Smit 00514 Attorney at Law
5900 Hohman Avenue, Hammond, IN 46320

MAIL TO:

1.00
CKE