

Mail tax bills to:
1115 169th Place
Hammond, Indiana

91040766

WARRANTY DEED

This Indenture Witnesseth that CLIFFORD W. ALLEY and BEVERLY L. ALLEY, husband and wife, of Lake County in the State of Indiana, CONVEY and WARRANT to STEPHEN F. LEA and ^{Aml} ANTONETTE M. LEA, husband and wife, of Lake County in the State of Indiana, for and in consideration of Ten (10.00) Dollars and other good and valuable consideration, the receipt whereof is hereby acknowledged, the following Real Estate in the State of Indiana, to-wit:

Lots 35 and 36, Block 1 Walters Addition to the City of Hammond, as shown in Plat Book 10, page 1, in Lake County, Indiana, commonly described as 1115 169th Place, Hammond, Indiana.

#36-294-36

This conveyance is subject to easements, covenants, rights of way, reservations, exceptions, encroachments, grants, building lines, and restrictions of record; and real estate taxes for the year 1991 payable in 1992.

Document is NOT OFFICIAL! This document is the property of the Lake County Recorder!

Dated this 6th day of August, 1991.

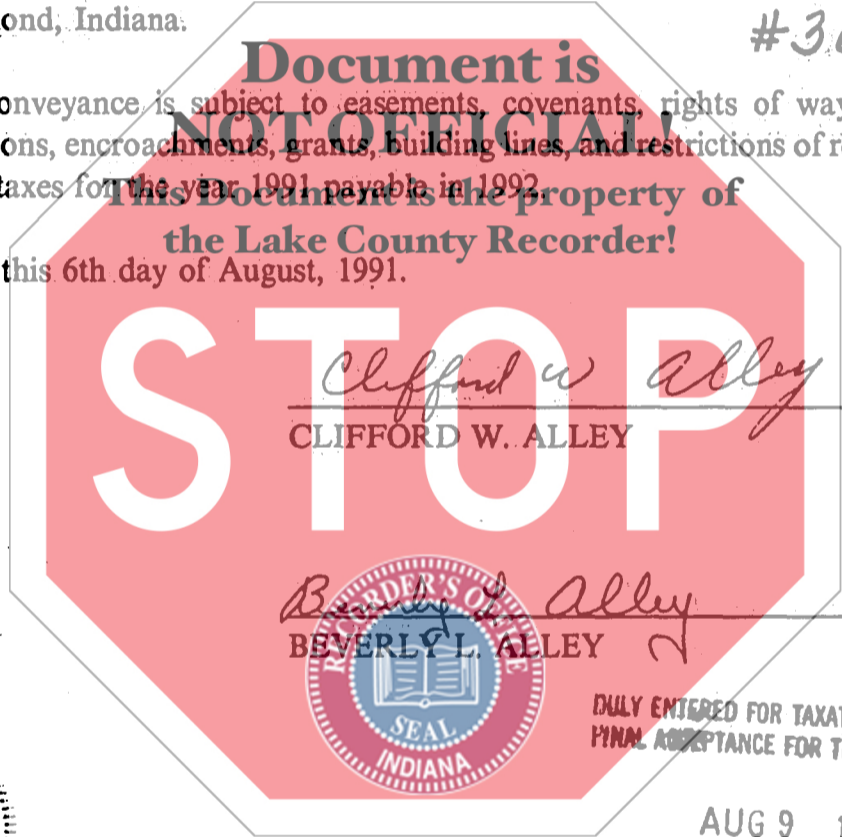

Clifford W. Alley
CLIFFORD W. ALLEY

Beverly L. Alley
BEVERLY L. ALLEY



Aug 9 (SEAL)
1 22 PM
ROBERT (BOB) FREELAND
RECORDER (SEAL)

STATE OF INDIANA/S.S.NO.
LAKE COUNTY
FILED FOR RECORD

INDIANA TITLE INSURANCE COMPANY
INDIANA DIVISION

DULY ENTERED FOR TAXATION SUBJECT TO FINAL ACCEPTANCE FOR TRANSFER.

AUG 9 1991

Quinn N. Anton
AUDITOR LAKE COUNTY

STATE OF INDIANA)
) SS:
COUNTY OF LAKE)

Before me, the undersigned, a Notary Public in and for said County and State, this 6th day of August, 1991, personally appeared CLIFFORD W. ALLEY and BEVERLY L. ALLEY, husband and wife, and acknowledged the execution of the foregoing deed.

In Witness whereof, I have hereunto subscribed my name and affixed my official seal.

Arlyne K. Royal

Arlyne K. Royal, Notary Public
Resident of Lake County, Indiana

My Commission Expires:

April 18, 1995

This Instrument Prepared By: Jason L. Horn, Attorney at Law
9337 Calumet Avenue, Munster, IN 46321

00521

100
A