



# TICOR TITLE INSURANCE

TICOR TITLE

Return To: \_\_\_\_\_

CROWN POINT OFFICE

81028303

## WARRANTY

## This Indenture Witnesseth

That THOMAS H. DURANT AND GEORGIA DURANT, HUSBAND AND WIFE

of Lake County, and State of Indiana

### CONVEY AND WARRANT

To JERRY W. STANLEY AND JOYCE D. STANLEY, HUSBAND AND WIFE

of Lake County, in the State of Indiana

for the sum of Ten Dollars and other valuable consideration Dollars

the following described REAL ESTATE in LAKE County, in the

State of Indiana, to-wit: \_\_\_\_\_

LOT 2 IN BLOCK 22 IN RAILROAD ADDITION TO CROWN POINT, AS PER PLAT THEREOF, RECORDED IN MISCELLANEOUS RECORD "A" PAGE 508, IN THE OFFICE OF THE RECORDER OF LAKE COUNTY, INDIANA.

Commonly known as: 540 N. THOMAS ST., CROWN POINT, IN 46307.

Subject to past and current year real estate taxes.

Subject to easements, restrictions and covenants of record, if any.

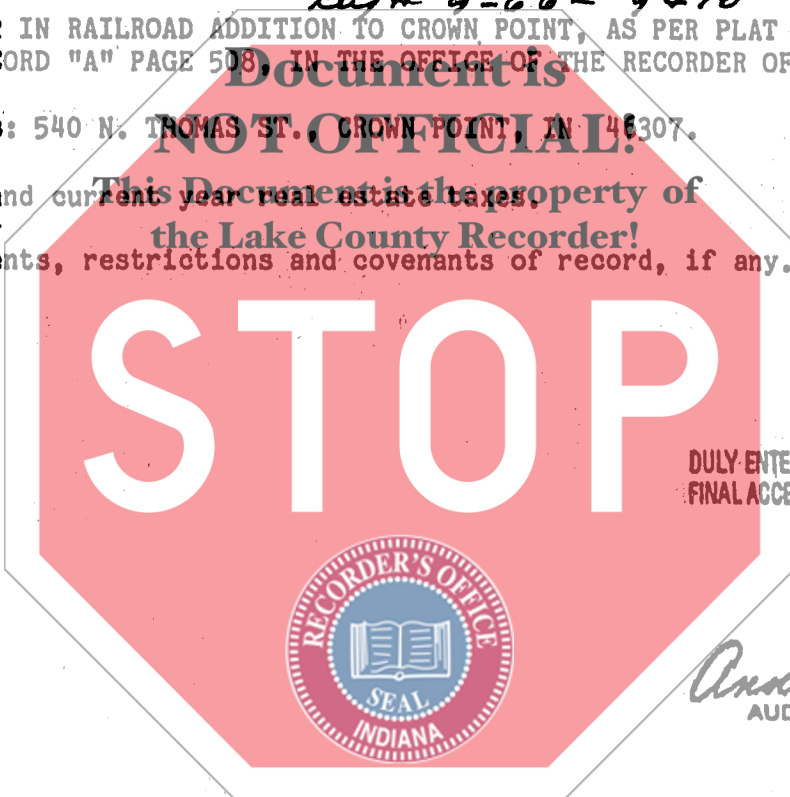

STATE OF INDIANA/S AND LAKE COUNTY FILED FOR RECORD JUN 10 10 07 AM 1991 ROBERT (BOB) FREELAND RECORDER

DULY ENTERED FOR TAXATION SUBJECT TO FINAL ACCEPTANCE FOR TRANSFER.

MAY 31 1991

*Anna N. Antone*  
AUDITOR LAKE COUNTY

THOMAS H. DURANT AND GEORGIA DURANT, HUSBAND AND WIFE

IN WITNESS WHEREOF, The said \_\_\_\_\_

Have hereunto set their Hands and seals this 15th day of May 19 91

THOMAS H. DURANT (SEAL) Georgia Durant (SEAL)

\_\_\_\_ (SEAL) \_\_\_\_\_ (SEAL)

\_\_\_\_ (SEAL) \_\_\_\_\_ (SEAL)

\_\_\_\_ (SEAL) \_\_\_\_\_ (SEAL)

STATE OF INDIANA, LAKE County, ss:

Before me, the undersigned, a Notary Public in and for said County and State, personally appeared the within named THOMAS H. DURANT AND GEORGIA DURANT, HUSBAND AND WIFE

who acknowledged the execution of the foregoing Deed to be their voluntary act and deed.

WITNESS, my hand and Seal this 15th day of May 19 91  
October 24 19 92

My commission expires \_\_\_\_\_ 19 \_\_\_\_\_  
GLORIA MILLER Notary Public

County of Residence LAKE

Mail Tax Statements to 500 N. THOMAS ST., CROWN POINT, IN 46307  
12413 Randolph St.

This instrument prepared by Atty. Thomas K. Hoffman

01157

700  
ti