

THIS FORM HAS BEEN APPROVED BY THE INDIANA STATE BAR ASSOCIATION FOR USE BY LAWYERS ONLY. THE SELECTION OF A FORM OF INSTRUMENT, FILLING IN BLANK SPACES, STRIKING OUT PROVISIONS AND INSERTION OF SPECIAL CLAUSES, CONSTITUTES THE PRACTICE OF LAW AND MAY ONLY BE DONE BY A LAWYER.

MAIL TAX BILLS TO: 91027650

TAX KEY NO: 36-415-10

Jean A. Lubarski  
7230 Knickerbocker Pkwy.  
Hammond, IN

# QUIT-CLAIM DEED

This indenture witnesseth that

JEAN A. LUBARSKI

of LAKE County in the State of INDIANA

Releases and quit claims to

MICHAEL S. LUBARSKI and JAMES DOUGLAS LUBARSKI  
as Tenants in Common

STATE OF INDIANA  
LAKE COUNTY  
FILED FOR RECORD  
JUN 6 9 31 AM '91  
ROBERT (BOB) FREELAND  
RECORDER

~~of~~ ~~XXXXXX~~ for and in consideration of Ten Dollars (\$10.00) and other good and valuable consideration the receipt whereof is hereby acknowledged, the following Real Estate in LAKE County in the State of Indiana, to wit:

Lots 11 and 12 in Block 35 in Unit 10 of Woodmar, Hammond, as per plat thereof, recorded in Plat Book 16 page 35, in the Office of the Recorder of Lake County, Indiana.

This Document is the property of the Lake County Recorder  
Commonly known as: 7230 Knickerbocker Parkway Hammond, Indiana

JEAN A. LUBARSKI reserves unto herself a life estate in and to the real estate herein described.

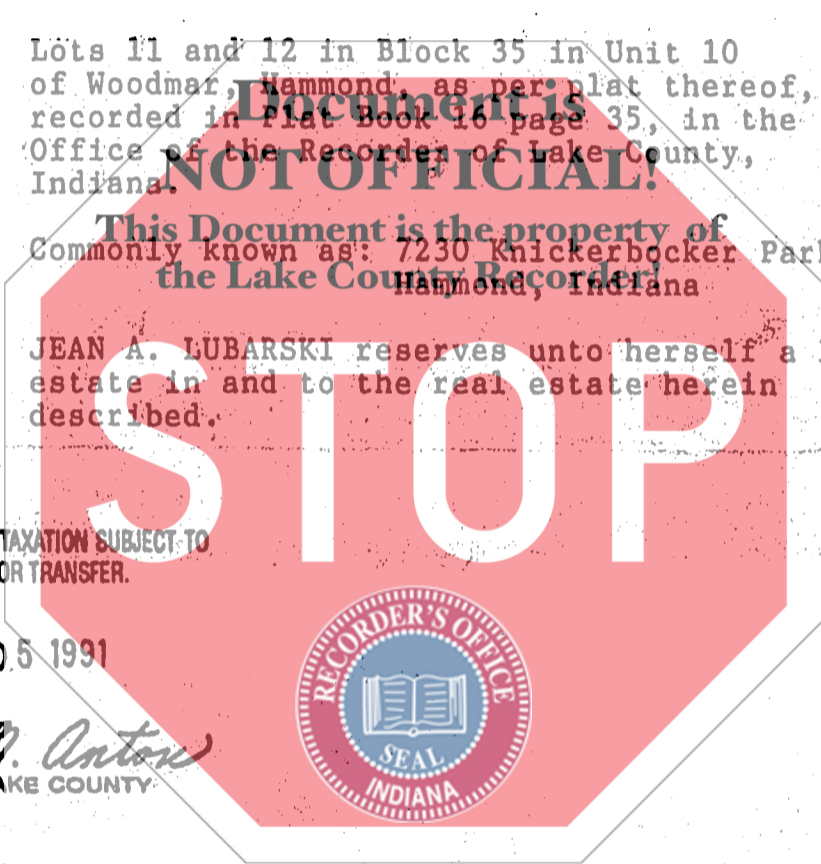

DULY ENTERED FOR TAXATION SUBJECT TO FINAL ACCEPTANCE FOR TRANSFER.

JUN 05 1991

Anna M. Antox  
AUDITOR LAKE COUNTY



State of Indiana, LAKE County, ss:  
Before me, the undersigned, a Notary Public in and for said County and State, this day of 19

Dated this 11 Day of April 1991

Jean A. Lubarski  
JEAN A. LUBARSKI

JEAN A. LUBARSKI

And acknowledged the execution of the foregoing deed. In witness whereof, I have hereunto subscribed my name and affixed my official seal. My commission expires April 1994

Felix S. Reed  
Notary Public

Resident of Lake County

This instrument prepared by BARBARA M. SHAVER, Attorney at Law  
905 Ridge Road, Munster, IN 46321

MAIL TO:

00016

700  
E