

THIS FORM HAS BEEN APPROVED BY THE INDIANA STATE BAR ASSOCIATION FOR USE BY LAWYERS ONLY. THE SELECTION OF A FORM OF INSTRUMENT, FILLING IN BLANK SPACES, STRIKING OUT PROVISIONS AND INSERTION OF SPECIAL CLAUSES, CONSTITUTES THE PRACTICE OF LAW AND MAY ONLY BE DONE BY A LAWYER.

Mall tax bills to:

Tax Key No. 13-424-2

# WARRANTY DEED

Richard C. Nader  
545 St. Andrews Drive East  
Schererville, IN

This indenture witnesseth that Cornel Vesa  
**91027501**

RETURN TO:  
FIRST AMERICAN TITLE INS. CO.  
6265 COMMERCE DR. SUITE 1  
CROWN POINT, IN 46307

of Lake County in the State of Indiana

Convey and warrant to Richard C. Nader and Ann C. Nader,  
husband and wife

of Lake County in the State of Indiana  
for and in consideration of \$10.00 and other good and valuable consideration  
the receipt whereof is hereby acknowledged, the following Real Estate in Lake County  
in the State of Indiana, to wit:

Lot 2 in Briar Ridge Country Club Addition, Block One of Unit 4, a planned unit development to the Town of Schererville, as per plat thereof, recorded in Plat Book 62, page 55, in the Office of the Recorder of Lake County, Indiana.

Commonly known as: 545 St. Andrews Drive East, Schererville, IN

Subject to past and current year real estate taxes.

Subject to easements, restrictions, and covenants of record, if any.

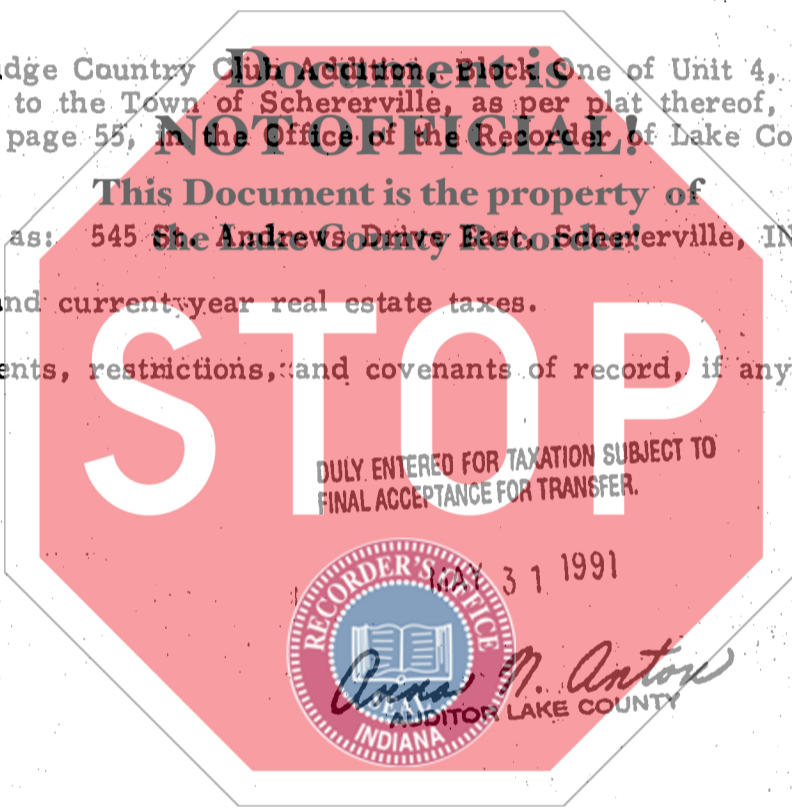

ROBERT (BOB) FREELAND  
RECORDER  
JUN 5 10 53 AM '91  
LAKE COUNTY  
FILED FOR RECORD

State of Indiana, Lake County, ss:

Dated this 17th Day of May 1991

Before me, the undersigned, a Notary Public in and for said County and State, this 17th day of May 1991 personally appeared:

Cornel Vesa

Cornel Vesa

Cornel Vesa

And acknowledged the execution of the foregoing deed. In witness whereof, I have hereunto subscribed my name and affixed my official seal. My commission expires 9-21-1992

Margaret E. Lawhead  
Margaret E. Lawhead  
Notary Public

Resident of Porter County.

This instrument prepared by Paul J. Giorgi 2100 N. Main, Crown Point, IN 46307 Attorney at Law

01507