

Kevin R. Kelly
6735 Waveland
Hm 46323

91026120

AFFIDAVIT OF SURVIVORSHIP

Comes now THOMAS L. KELLY and, being first duly sworn upon his oath, deposes and says:

1. That he is the widower of Laverne B. Kelly, who departed this life on the 17th day of July, 1986.

2. That this Affiant and the said Laverne B. Kelly were duly married on the 11th day of April, 1942 and lived together as husband and wife continuously up until the date of said Laverne B. Kelly's death.

3. That the said Laverne B. Kelly died testate and that there were no assets which required probate or federal or state estate taxation.

4. That the Affiant makes this Affidavit for the purpose of showing by operation of law that he is the owner of the following described real estate, to-wit:

Lot Eighteen (18), in Block Five (5), Eastgate Subdivision, as shown in Plat Book 30, page 16, in Lake County, Indiana.
Commonly known as 6329 Maryland, Hammond, Indiana.

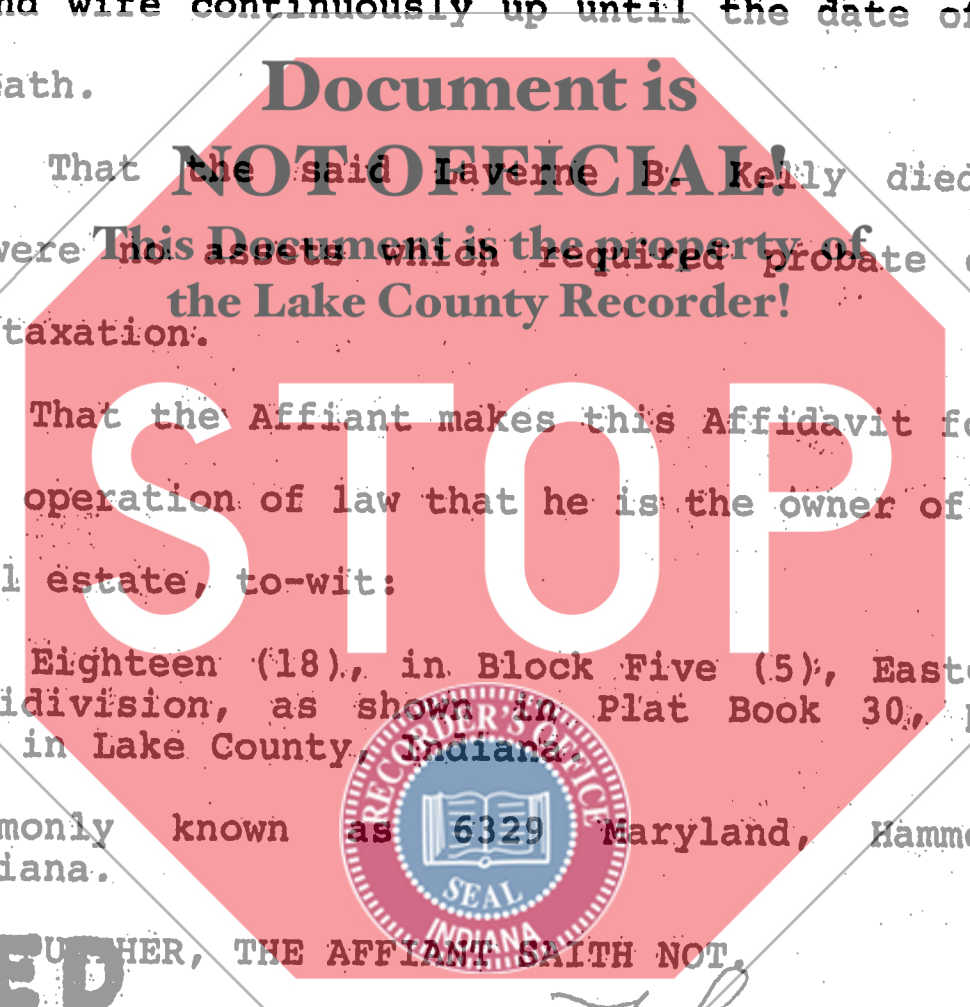

ROBERT (BOB) FRELAND
RECORDER

MAY 29 1 38 PM '91

STATE OF INDIANA/S.S.N.D.
LAKE COUNTY
FILED FOR RECORD

FILED AND NUMBER, THE AFFIANT SAITH NOT.

MAY 29 1991

Thomas L. Kelly
THOMAS L. KELLY

SUBSCRIBED AND SWORN TO BEFORE ME, a Notary Public, this 29th day of May, 1991.

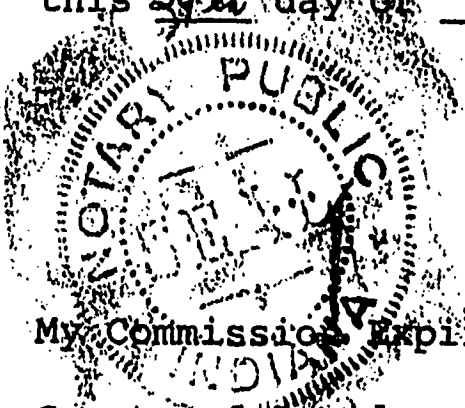

Christina Green
NOTARY PUBLIC (Written)

CHRISTINA GREEN
NOTARY PUBLIC (Printed)

My Commission Expires: 2-5-1993

County of Residence: Lake

01628 600