

91024900

Lake MTG Co.  
P.O. Box 10768  
4000 W Lincoln Highway  
Merr. In. 46410

SATISFACTION OF MORTGAGE

This certifies that a certain mortgage executed by Robert Gaffney and Bonita J. Gaffney, Husband & Wife assigned to CAPITAL FEDERAL SAVINGS AND LOAN ASSOCIATION, n/k/a FIRST FEDERAL SAVINGS BANK OF INDIANA, from LAKE MORTGAGE COMPANY, on the day of 3TH August, 19 71, calling for \$ 14,250.00, and recorded in Mortgage Record No. \_\_\_\_\_, Page \_\_\_\_\_, as Document No. 111337 of the records of Lake County, State of Indiana, has been fully paid and satisfied, and the same is hereby released.

IN WITNESS WHEREOF, said FIRST FEDERAL SAVINGS BANK OF INDIANA, a United States Corporation, has caused this instrument to be executed by its duly authorized officers and its corporate seal to be affixed hereunto, this 9TH day of MAY, 19 1991

Lot 5, except the North 17 1/2 feet thereof, and the North 22 1/2 feet of Lot 6 in Block 14 in Resubdivision of Gary Land Company's Thirteenth Subdivision, in the City of Gary, as per plat thereof, recorded in Plat Book 19 page 10, in the Office of the Recorder of Lake County, Indiana.

STATE OF INDIANA  
LAKE COUNTY  
FILED FOR RE  
MAY 23 11 58 AM '91  
ROBERT H. BOGUE  
RECORDER

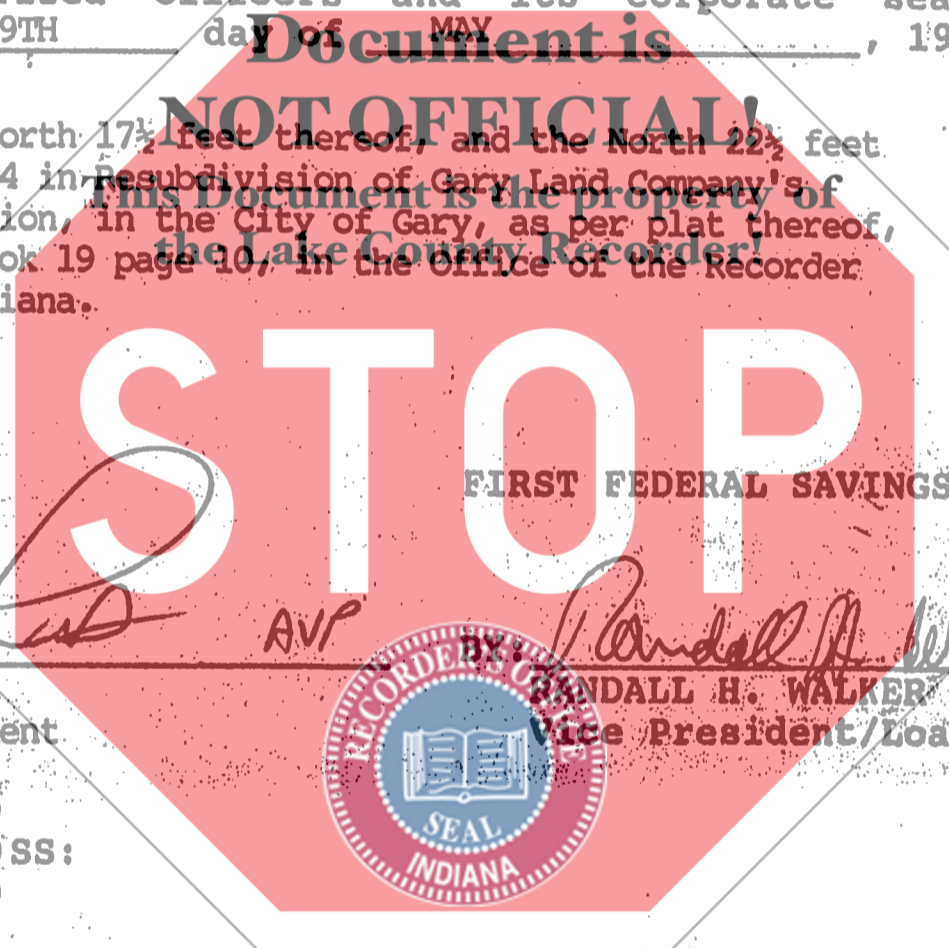

BY: [Signature]  
Craig S. Pratt  
Asst. Vice-President

BY: [Signature]  
RANDALL H. WALKER  
Vice President/Loan Administration

STATE OF INDIANA )  
                          ) SS:  
COUNTY OF LAKE )

Before me, the undersigned, a Notary Public in and for said County and State, this 9TH day of MAY, 19 91, FIRST FEDERAL SAVINGS BANK OF INDIANA, a United States Corporation by RANDALL H. WALKER, Vice President, and Craig S. Pratt, and who are such officers, for and on behalf of and as the act of said Association, acknowledged the execution of the annexed Satisfaction of Mortgage.

Witness my hand and notarial seal.

My Commission Expires:  
May 10, 1994

[Signature]  
Margarita Thompson, Notary Public

Lake County Resident

Prepared by: First Federal Savings Bank of Indiana

5.00  
E