

THIS FORM HAS BEEN APPROVED BY THE INDIANA STATE BAR ASSOCIATION FOR USE BY LAWYERS ONLY. THE SELECTION OF A FORM OF INSTRUMENT, FILLING IN BLANK SPACES, STRIKING OUT PROVISIONS AND INSERTION OF SPECIAL CLAUSES, CONSTITUTES THE PRACTICE OF LAW AND MAY ONLY BE DONE BY A LAWYER.

Mail tax bills to: **91024818**

Tax Key No. _____

533 Britton
Schererville, IN
46375

WARRANTY DEED

This indenture witnesseth that

STEVE G. MICHALEC AND MARY A. MICHALEC, HUSBAND AND WIFE

of Lake County in the State of Indiana

Convey and warrant to

JOSEPH E. KRUPA AND MARY E. KRUPA, HUSBAND AND WIFE

of Lake County in the State of Indiana
for and in consideration of Ten Dollars and other good and valuable consideration
the receipt whereof is hereby acknowledged, the following Real Estate in LAKE County
in the State of Indiana, to wit:

13-463-10

LOT 10 IN SAND OAK ESTATES, AN ADDITION TO THE TOWN OF SCHERERVILLE, AS PER PLAT THEREOF, RECORDED IN PLAT BOOK 66 PAGE 18, IN THE OFFICE OF THE RECORDER OF LAKE COUNTY, INDIANA.

Commonly known as: 533 Britton Drive, Schererville, IN 46375

Subject to past and current year real estate taxes.
Subject to easements, restrictions and covenants of record, if any.

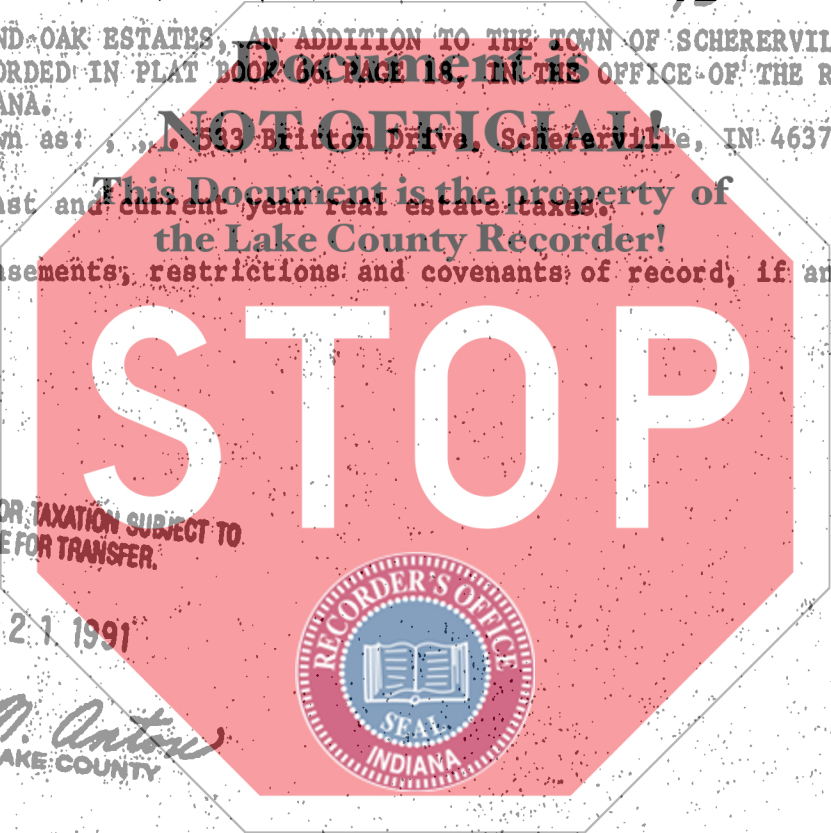

DULY ENTERED FOR TAXATION SUBJECT TO FINAL ACCEPTANCE FOR TRANSFER.

MAY 21 1991

Anna N. Antone
AUDITOR LAKE COUNTY



STATE OF INDIANA'S SMO.
LAKE COUNTY
FILED
MAY 23 10 21 AM '91
ROBERT DOUGLASS FREELAND
RECORDER

State of Indiana, Lake County, ss:

Before me, the undersigned, a Notary Public in and for said County and State, this 9th day of April 1991 personally appeared:

STEVE G. MICHALEC AND MARY A. MICHALEC,
HUSBAND AND WIFE

Dated this 9th Day of April 1991

Steve G. Michalec
STEVE G. MICHALEC

Mary A. Michalec
MARY A. MICHALEC

And acknowledged the execution of the foregoing deed. In witness whereof, I have hereunto subscribed my name and affixed my official seal. My commission expires December 3 1993

Jean Henderson
JEAN HENDERSON
Notary Public

Resident of Lake County

00875

700
w

This instrument prepared by JOHN D. BRECLAW Attorney at Law
735 West Glen Park Avenue
Griffith, Indiana 46319
(219) 924-8750