

THIS FORM HAS BEEN APPROVED BY THE INDIANA STATE BAR ASSOCIATION FOR USE BY LAWYERS ONLY. THE SELECTION OF A FORM OF INSTRUMENT, FILLING IN BLANK SPACES, STRIKING OUT PROVISIONS AND INSERTION OF SPECIAL CLAUSES, CONSTITUTES THE PRACTICE OF LAW AND MAY ONLY BE DONE BY A LAWYER.

91024721 REAL ESTATE MORTGAGE

This indenture witnesseth that HUGO MAGISTRELLI and ARLENE MAGISTRELLI

of Lake County, Indiana

as MORTGAGOR

Mortgage and warrant to CAROL A. SCHWEITZER

of Lake County,

Indiana, as MORTGAGEE

the following real estate in State of Indiana, to wit:

Lake

County

The South 39.0 feet of Lot 21, as laid off parallel with the South line of said Lot 21, in Deerpath Townhomes Addition to the Town of Schererville, as per plat thereof, recorded in Plat Book 65, page 48, in the Office of the Recorder of Lake County, Indiana.

Commonly known as 2307 Barbara Jean Drive, Schererville, IN 46375.

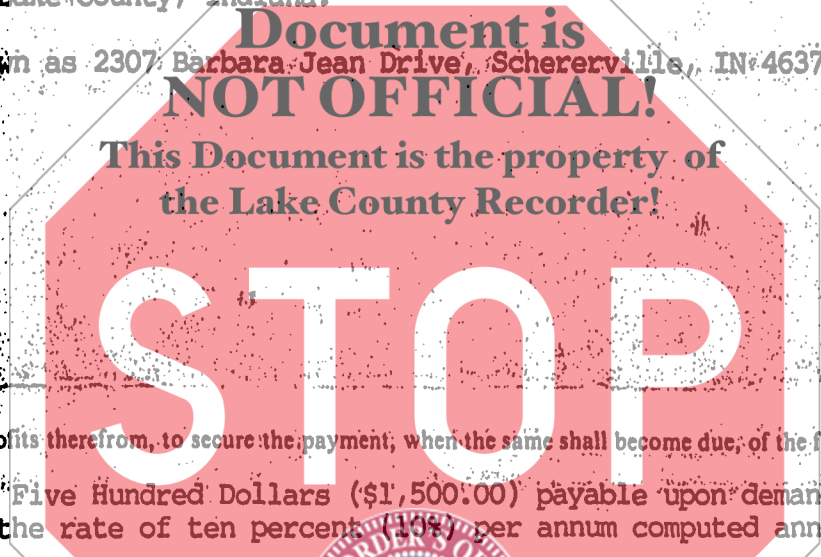

STATE OF INDIANA / S. H. ROBERT MASON / RECORDER / MAY 23 9 00 AM '91 / LAKE COUNTY

and the rents and profits therefrom, to secure the payment, when the same shall become due, of the following indebtedness:

One Thousand Five Hundred Dollars (\$1,500.00) payable upon demand together with interest at the rate of ten percent (10%) per annum computed annually.

Upon failure to pay said indebtedness as it becomes due, or any part thereof at maturity, or the taxes or insurance hereinafter stipulated, then said indebtedness shall be due and collectible, and this mortgage may be foreclosed accordingly. It is further expressly agreed that, until said indebtedness is paid, the Mortgagor will keep all legal taxes and charges against the real estate paid as they become due, and will keep the buildings thereon insured against fire and other casualties in an amount at least equal to the indebtedness from time to time owing, with loss payable clause in favor of the Mortgagee, and will, upon request, furnish evidence of such insurance to the Mortgagee; and, failing to do so, the Mortgagee may pay said taxes or insurance, and the amount so paid, with 10 percent interest thereon, shall become a part of the indebtedness secured by this mortgage.

Additional Covenants: None

State of Indiana, Lake County, ss:

Dated this 22nd Day of May 19 91

Before me, the undersigned, a Notary Public in and for said County and State, this 22nd day of May 19 91

personally appeared: Hugo Magistrelli and Arlene Magistrelli and acknowledged the execution of the foregoing mortgage. In witness whereof, I have hereunto subscribed my name and affixed my official seal.

My commission expires May 5 19 95

C. Donald Emery, III
Signature
C. Donald Emery, III
Printed Name

Resident of Lake County

Hugo Magistrelli Seal
HUGO MAGISTRELLI
Arlene Magistrelli Seal
ARLENE MAGISTRELLI
Seal

This instrument prepared by C. Donald Emery, III, Suite 200, 9245 Calumet Ave. Attorney at Law

Munster, IN 46321

MAIL TO: Singleton, Crist, Patterson, Austgen & Lyman, Suite 200, 9245 Calumet Ave.,

Munster, IN 46321.