

91024501

# Warranty Deed

THIS INDENTURE WITNESSETH, That Conley Construction and Engineering Corp  
Terrence C. Conley

of Lake County, in the State of Indiana Convey and Warrant  
to Eliseo and Lilibet Espinosa  
Husband and Wife  
\*Espinosa  
of Lake County, in the State of Indiana, for and in consideration of the sum of  
Ten (10.00) Dollars and other good and valuable considerations

the receipt whereof is hereby acknowledged, the following described Real Estate in Lake County,  
in the State of Indiana, to-wit:

Key # 32-250-7

Lot 7 in Parrish Park Third Subdivision, in the city of Hammond, as per plat  
thereof, recorded in Plat Book 65 page 28, in the Office of the Recorder of  
Lake County, Indiana, except a triangular portion described as follows:  
Commencing at the Southeast corner of aforesaid Lot #7; thence North 0° 47'  
East on the East line a distance 20.00 ft; thence south 61° 02' West 40.31  
feet to the South line; thence South 89° 13' East a distance of 35.00 feet  
to the place of beginning; and also except that part of vacated Kansas Avenue  
lying East of and adjacent to said lot.

Subject to the following:

1. Taxes for the year 1991 due and payable in May and November of 1992 and  
taxes for all subsequent years.
2. Easements, Restrictions, Covenants, Rights of Way and all other matters of  
Public Record.

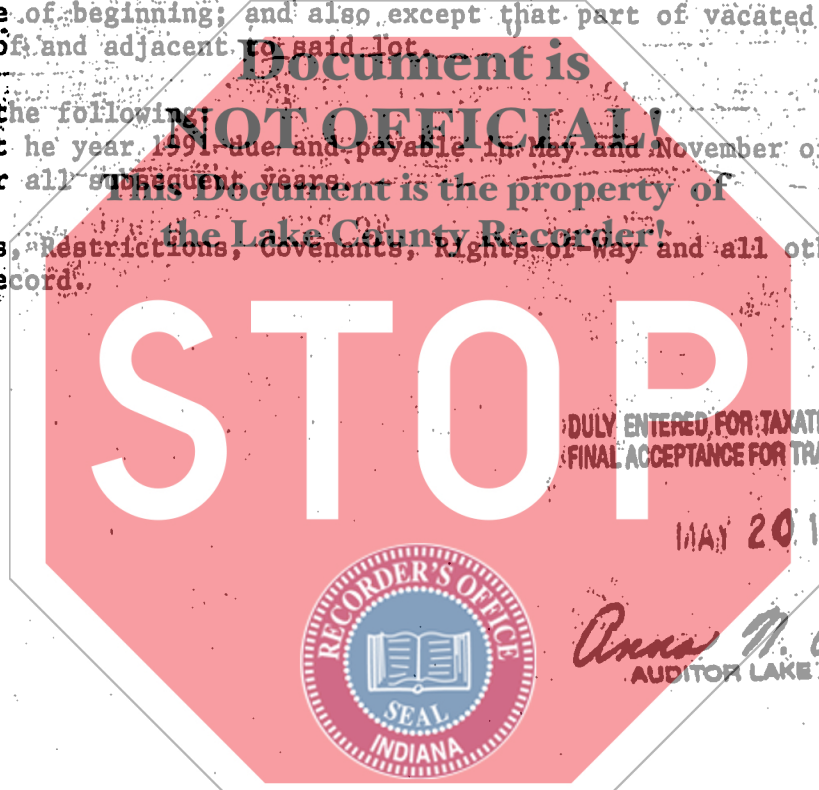

In Witness Whereof, The said Conley Construction and Engineering Corp.  
Terrence C. Conley

has hereunto set hand and seal, this 30th day of April

*Terrence C. Conley* (Seal)  
 \_\_\_\_\_ (Seal)  
 \_\_\_\_\_ (Seal)

MAY 22 10 25 AM '91  
 ROBERT [Seal]  
 RECORDER  
 ILLINOIS

STATE OF INDIANA, Lake COUNTY, as:

Before me, the undersigned, a Notary Public in and for said County, this  
30th day of April 1991, came

, and acknowledged the execution of the foregoing instrument.

Witness my hand and official seal.

My Commission expires 2-26-94

*Patricia M. Conley* Notary Public  
 Patricia M. Conley  
 Resident of Lake County

This instrument prepared by:  
Terrence C. Conley

00403