

Use of this form constitutes practice of law and is limited to practicing lawyers.
©Copyright, 1986, by Indianapolis Bar Association.

Rev. 10/86

KEY
Form No. 46-405-1 & 43-280-20

91024067

WARRANTY DEED

STATE OF INDIANA/S.S. NO.
FILED
LAKE COUNTY
MAY 21 9 48 AM '91
ROBERT R. DODDER, CLERK

THIS INDENTURE WITNESSETH, That MINNIE LEE CHERRY and HATTIE COWART, joint tenants (Grantor)

of Lake County, in the State of Indiana, CONVEY AND WARRANT to EUNICE M. DAVIS (Grantee)

of Lake County, in the State of Indiana, for the sum of Ten and 00/100 Dollars (\$ 10.00) and other

valuable consideration, the receipt and sufficiency of which is hereby acknowledged; the following described real estate in Lake County, State of Indiana:

Lot "A" as marked and laid down on the recorded plat of Reissing Park Resubdivision, a subdivision of Lot 41, Block 1, and Lot 17, Block 2, part of Glen Park Addition, and that part of plot of ground designated as Reissing Park in Glen Park Addition; and the South 10 feet of Lot No. Sixteen (16), in Block No. Two (2), as marked and laid down on the recorded plat of Glen Park, a subdivision of Blocks 1, 2 and 4, of the North Half of the Northeast Quarter of the Southeast Quarter of Section 28, Township 36 North, Range 8 West of the Second Principal Meridian, all in the City of Gary, Lake County, Indiana.

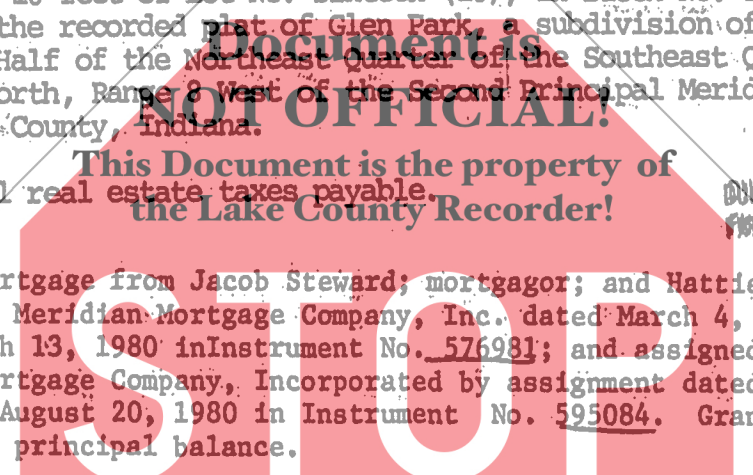

Subject to all real estate taxes payable. **ONLY INTENDED FOR TAXATION; SUBJECT TO FINAL ACCEPTANCE FOR TRANSFER.**

Subject to Mortgage from Jacob Steward; mortgagor; and Hattie Cowart, mortgagor, to Meridian Mortgage Company, Inc. dated March 4, 1980 and recorded March 13, 1980 in Instrument No. 576981; and assigned to Waterfield Mortgage Company, Incorporated by assignment dated August 6, 1980 and recorded August 20, 1980 in Instrument No. 595084. Grantee assumes unpaid principal balance. *Robert M. Antonio*
AUDITOR LAKE COUNTY

Subject to any and all easements, agreements and restrictions of record. The address of such real estate is commonly known as 4165 Jefferson Street, Gary, Indiana 46408

Tax bills should be sent to Grantee at such address unless otherwise indicated below.

IN WITNESS WHEREOF, Grantor has executed this deed this 17th day of May, 1991.

Grantor: (SEAL)
Signature: *Minnie Lee Cherry*
Printed: MINNIE LEE CHERRY

Grantor: (SEAL)
Signature: *Hattie Cowart*
Printed: HATTIE COWART

STATE OF Indiana } SS: ACKNOWLEDGMENT
COUNTY OF Lake

Before me, a Notary Public in and for said County and State, personally appeared Minnie Lee Cherry and Hattie Cowart, joint tenants who acknowledged the execution of the foregoing Warranty Deed, and who, having been duly sworn, stated that any representations therein contained are true.

Witness my hand and Notarial Seal this 17th day of May, 1991.
My commission expires: 9-17-93 Signature: *Andrea A Plasencia*
Printed: Andrea A Plasencia, Notary Public

Resident of Lake County, Indiana.
This instrument prepared by MARK A. PSIMOS, 7887 Broadway, Merrillville, IN 46410, Attorney at Law.

Return deed to Waterfield Mortgage Co 200 East Berry Street
Send tax bills to Fort Wayne, IN 46802

01193 *900*