

THIS FORM HAS BEEN APPROVED BY THE INDIANA STATE BAR ASSOCIATION FOR USE BY LAWYERS ONLY. THE SELECTION OF A FORM OF INSTRUMENT, FILLING IN BLANK SPACES, STRIKING OUT PROVISIONS AND INSERTION OF SPECIAL CLAUSES, CONSTITUTES THE PRACTICE OF LAW AND MAY ONLY BE DONE BY A LAWYER.

Mail tax bills to: 91024043

Tax Key No. 29-116-66

6322 Moraine
Hammond, IN. 46324

WARRANTY DEED

RECORDED
TITLE INSTRUMENT
INDIANAPOLIS, INDIANA
MAY 20 1 24 PM '91
ROBERT REESER
RECORDER
LAKE COUNTY

This indenture witnesseth that EDWARD J. BENUS and DONNA LEE BENUS,
Husband and Wife

of Lake County in the State of Indiana

Convey and warrant to MARTIN R. DEL RIO and CYNTHIA L. DEL RIO,
Husband and Wife.

of Lake County in the State of Indiana

for and in consideration of Ten Dollars and other good and valuable consideration
the receipt whereof is hereby acknowledged, the following Real Estate in Lake County
in the State of Indiana, to wit:

Lot 113, Whittings, a subdivision of that part of the Southwest Quarter of the
Northeast Quarter of Section 7, Township 37 North, Range 9 West of the 2nd P.M.,
lying North of the Highway known as Indiana Boulevard in the City of Whiting, as
shown in Plat Book 2, Page 52, in Lake County, Indiana.

This Document is the property of

Commonly known as: 1937 Clark Street
Whiting, Indiana 46394

29-116-66

Subject to past and current year real estate taxes.

Subject to easements, restrictions and covenants of record, if any.

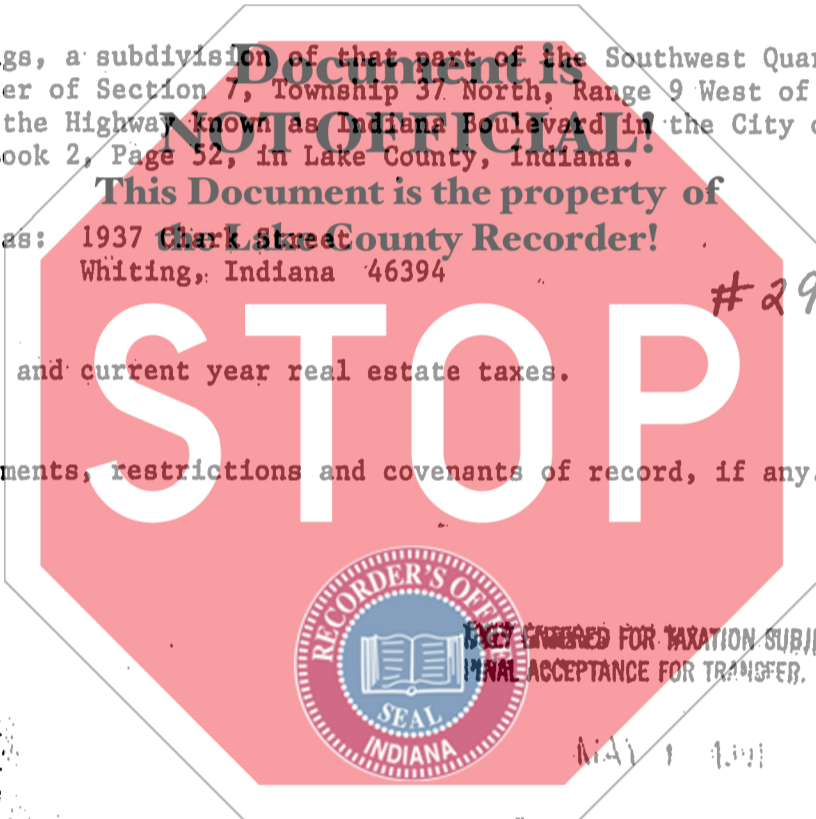

State of Indiana, Lake County, ss:
Before me, the undersigned, a Notary Public in and for said County
and State, this 9th day of May 19 91
personally appeared:

EDWARD J. BENUS and DONNA LEE BENUS,
Husband and Wife

Dated this 9th Day of May 19 91

Edward J. Benus
EDWARD J. BENUS

Donna Lee Benus
DONNA LEE BENUS

And acknowledged the execution of the foregoing deed. In witness
whereof, I have hereunto subscribed my name and affixed my of-
ficial seal. My commission expires April 18 19 95

Arlyne K. Royal
Notary Public

Resident of Lake County.

This instrument prepared by JOHN D. BRECLAW, JOHN D. BRECLAW & ASSOCIATES Attorney at Law
735 West Glen Park Avenue, Griffith, Indiana 46319

00756 100
OK