

THIS FORM HAS BEEN APPROVED BY THE INDIANA STATE BAR ASSOCIATION FOR USE BY LAWYERS ONLY. THE SELECTION OF A FORM OF INSTRUMENT, FILLING IN BLANK SPACES, STRIKING OUT PROVISIONS AND INSERTION OF SPECIAL CLAUSES, CONSTITUTES THE PRACTICE OF LAW AND MAY ONLY BE DONE BY A LAWYER.

MAIL TAX BILLS TO: \$1024042

TAX KEY NO: 29-116-66

6322 Moraine
Hammond, IN. 46324

QUIT-CLAIM DEED

This indenture witnesseth that ANNA BENUS

6322 Moraine
Hammond, IN. 46324

INDIANA TITLE INSURANCE COMPANY
INDIANA DIVISION
STATE OF INDIANA
LAKE COUNTY
FILED
MAY 20 1 24 PM '91
ROBERT RECORDER
BEEBE AND

of Lake County in the State of Indiana

Releases and quit claims to EDWARD J. BENUS and DONNA LEE BENUS,
Husband and Wife

of Lake County in the State of Indiana

for and in consideration of Ten Dollars and other good and valuable consideration the receipt whereof is hereby acknowledged, the following Real Estate in the State of Indiana, to wit:

County

Lot 113, Whittings, a subdivision of that part of the Southwest Quarter of the Northeast Quarter of Section 7, Township 37 North, Range 9 West of the 2nd P.M., lying North of the Highway known as Indiana Boulevard in the City of Whiting, as shown in Plat Book 2, Page 52, in Lake County, Indiana.
(1937 Clark Whiting, IN.)

Commonly known as: 1937 Clark Street
Whiting, Indiana 46394

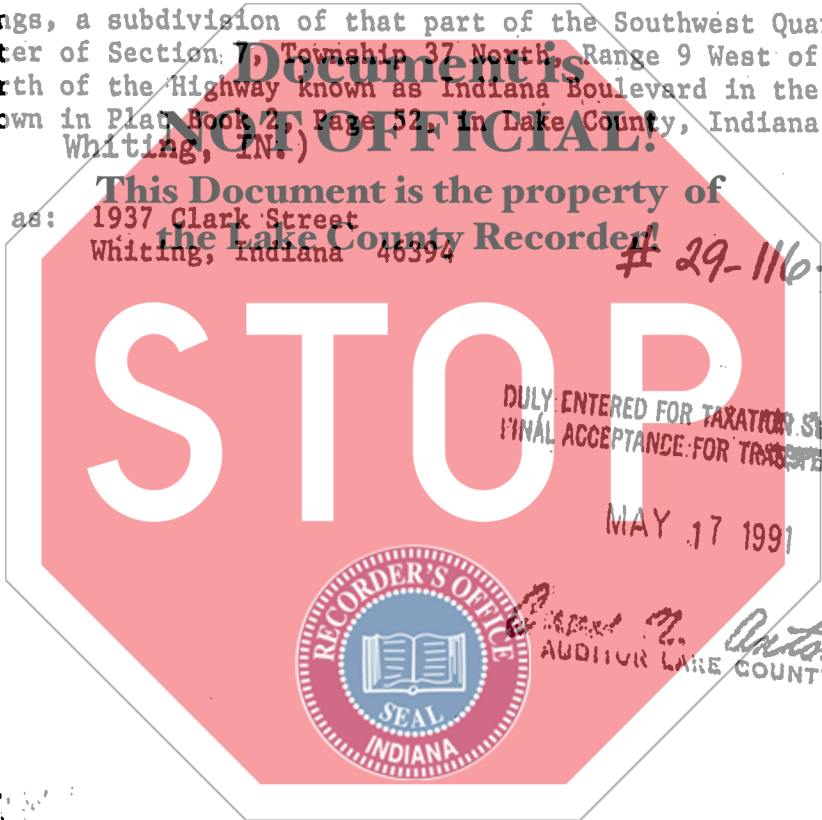

State of Indiana, Lake County, ss:
Before me, the undersigned, a Notary Public in and for said County and State, this 9th day of May 1991 personally appeared:

ANNA BENUS BY EDWARD J. BENUS, per
Power of Attorney as Attorney in fact

Dated this 9th Day of May 19 91
Anna Benus, BY Edward J. Benus

ANNA BENUS BY EDWARD J. BENUS, per
Power of Attorney as Attorney in fact

And acknowledged the execution of the foregoing deed. In witness whereof, I have hereunto subscribed my name and affixed my official seal. My commission expires April 18 1995

Arlyne K. Royal
Arlyne K. Royal Notary Public

Resident of Lake County

This instrument prepared by JOHN D. BRECLAW, Attorney at Law

735 West Glen Park Avenue
Griffith, Indiana 46319
(219) 924-8750

MAIL TO:

00755 700 OK