

THIS FORM HAS BEEN APPROVED BY THE INDIANA STATE BAR ASSOCIATION FOR USE BY LAWYERS ONLY. THE SELECTION OF A FORM OF INSTRUMENT, FILLING IN BLANK SPACES, STRIKING OUT PROVISIONS AND INSERTION OF SPECIAL CLAUSES, CONSTITUTES THE PRACTICE OF LAW AND MAY ONLY BE DONE BY A LAWYER.

Mail tax bills to:

Tax Key No.:

710 DARCY LANE
GRIFFITH, IN 46319

91023568 WARRANTY DEED

This indenture witnesseth that

LAWRENCE PIENING AND HELEN PIENING, HUSBAND AND WIFE

of LAKE County in the State of INDIANA

Convey and warrant to

DAVID L. COOK AND CAROL A. COOK, HUSBAND AND WIFE

of LAKE County in the State of INDIANA

for and in consideration of Ten Dollars and other good and valuable consideration the receipt whereof is hereby acknowledged, the following Real Estate in LAKE County in the State of Indiana, to wit:

STATE OF INDIANA
LAKE COUNTY
FILED
MAY 17 9 35 AM '91
ROBERT RECORDER

Key 26-272-56

LOT 151 IN THE PARK 3RD ADDITION TO THE TOWN OF GRIFFITH, AS PER PLAT THEREOF, RECORDED IN PLAT BOOK 36 PAGE 85 IN THE OFFICE OF THE RECORDER OF LAKE COUNTY INDIANA.

Commonly known as: 710 DARCY LANE, GRIFFITH, IN 46319.

Subject to past and current year real estate taxes.

Subject to easements, restrictions and covenants of record, if any.

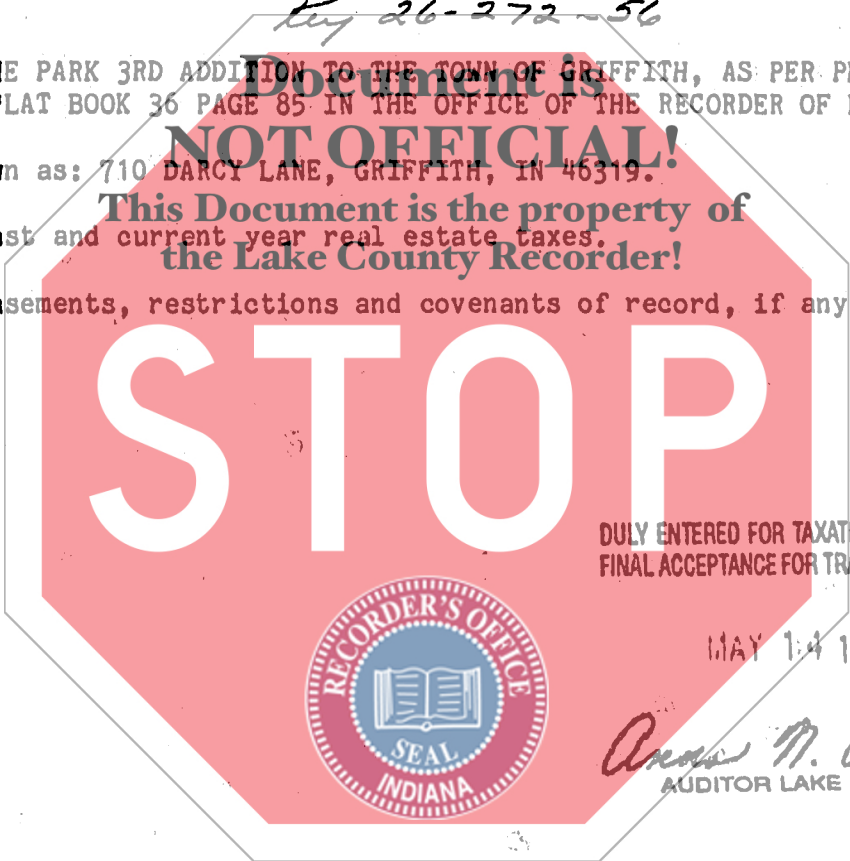

DULY ENTERED FOR TAXATION SUBJECT TO FINAL ACCEPTANCE FOR TRANSFER.

MAY 14 1991



Anna M. Antow
AUDITOR LAKE COUNTY

State of Indiana, Lake County, ss:
Before me, the undersigned, a Notary Public in and for said County and State, this 29th day of April 1991 personally appeared:

Dated this 29th Day of April 1991

Lawrence Piening

LAWRENCE PIENING

Helen Piening

HELEN PIENING

LAWRENCE PIENING AND HELEN PIENING,
HUSBAND AND WIFE

And acknowledged the execution of the foregoing deed. In witness whereof, I have hereunto subscribed my name and affixed my official seal. My commission expires: 1994

Linda S. Wood
LINDA S. WOOD
Notary Public

Resident of Lake County.

This instrument prepared by: JOHN D. BRECLAW Attorney at Law

735 West Glen Park Avenue
Griffith, Indiana 46319
(219) 924-8750

00099

700 K