

91023238

THIS FORM HAS BEEN APPROVED BY THE INDIANA STATE BAR ASSOCIATION FOR USE BY LAWYERS ONLY. THE SELECTION OF A FORM OF INSTRUMENT, FILLING IN BLANK SPACES, STRIKING OUT PROVISIONS AND INSERTION OF SPECIAL CLAUSES, CONSTITUTES THE PRACTICE OF LAW AND MAY ONLY BE DONE BY A LAWYER.

Bank One, Trustee

Tax Key No. _____

Mail tax bills to: /

91017306

DEED OF PERSONAL REPRESENTATIVE

1000E 80th Pl,
~~PO Box 10122~~, Suite 427D
Merrillville, IN
46410

Barbara Jean Traficanti, as Personal Representative,
of the Estate of Steven Traficanti, deceased,

STATE OF INDIANA/S.S. NO. _____
LAKE COUNTY
FILED FOR RECORD
APR 12 11 13 AM '91
ROBERT "BOB" FREELAND
RECORDER

conveys to Bank One, as Trustee under the testamentary trust of Steven Traficanti, dated February 19, 1976,
of the County of Lake, State of Indiana, the following described real estate
in Lake County, State of Indiana, more particularly described as follows, to-wit:

(see attached legal description)

This deed is being re-recorded to correct the name of the grantee.

DULY ENTERED FOR TAXATION SUBJECT TO FINAL ACCEPTANCE FOR TRANSFER.
APR 11 1991
Debra N. Antox
AUDITOR LAKE COUNTY

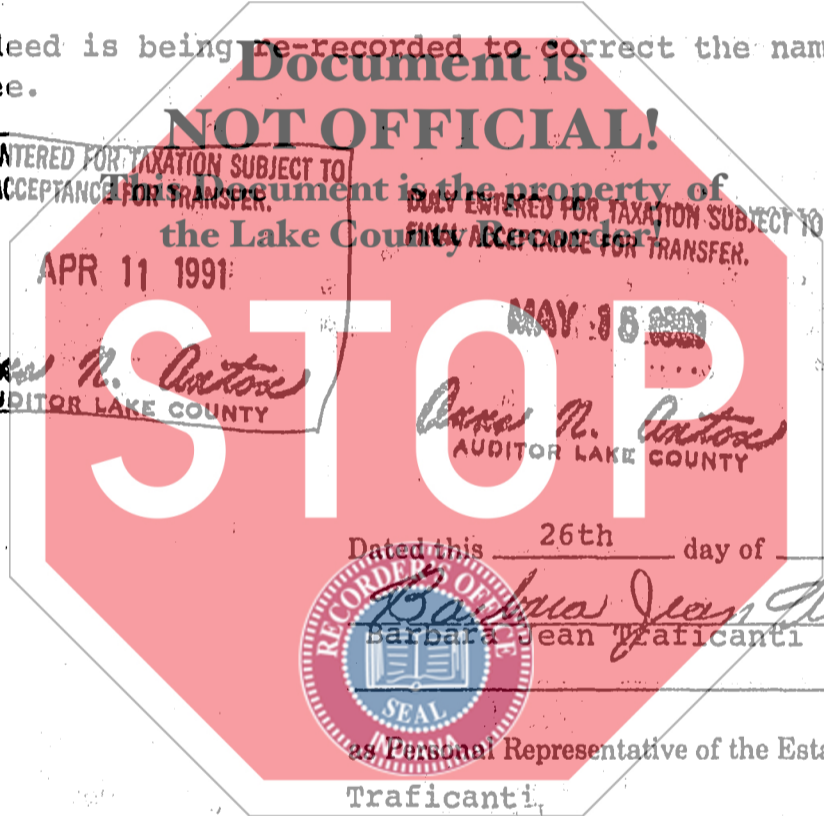

DULY ENTERED FOR TAXATION SUBJECT TO FINAL ACCEPTANCE FOR TRANSFER.
MAY 15 1991
Debra N. Antox
AUDITOR LAKE COUNTY

STATE OF INDIANA/S.S. NO. _____
LAKE COUNTY
FILED FOR RECORD
MAY 15 2 24 PM '91
ROBERT "BOB" FREELAND
RECORDER

Dated this 26th day of March, 19 91

Barbara Jean Traficanti
Barbara Jean Traficanti
as Personal Representative of the Estate of Steven Traficanti, deceased

STATE OF INDIANA)
COUNTY OF LAKE)

SS:

Before me, the undersigned, a Notary Public, in and for said County and State, personally appeared Barbara Jean Traficanti

as Personal Representative of the Estate of _____

deceased, and acknowledged the execution of this deed.

WITNESS MY HAND AND SEAL THIS 26th day of March, 19 91

My Commission Expires: January 6, 1993
Charles E. Van Nada Notary Public
Resident of Lake County

This instrument prepared by Charles E. Van Nada Attorney at Law.
313 E. Commercial Ave., Lowell, IN 46356

Mail to: _____

00942 900

00533

The South Half of the Northwest Quarter; the North Half of Southeast Quarter; the North Half of Northeast Quarter of Southwest Quarter, all in Section 1, Township 33 North, Range 10 West of the Second Principal Meridian, in Lake County, Indiana. Key Nos. 1-84-3, 6 and 7.

The Northwest Quarter of the Southwest Quarter; That part of the South Half of Southeast Quarter of the Northwest Quarter; and of the Northeast Quarter of Southwest Quarter lying West of Swamp Land Ditch, in Section 6, Township 33 North, Range 9 West of the Second Principal Meridian, in Lake County, Indiana. Key Nos. 1-51-6, 11 and 12.

The fractional Northwest Quarter of Southwest Quarter of Section 1, Township 33 North, Range 10 West of the Second Principal Meridian, Lake County, Indiana. Key No. 1-84-5.

A part of the East Half of Southeast Quarter of Section 20, Township 34 North, Range 9 West of Second Principal Meridian, more particularly described as follows: Commencing at a point on the East line of the East Half of the Southeast Quarter of said Section 20, which is 1145 feet North of the Southeast corner thereof, running thence West 263 feet; thence North 75 feet; thence East 263 feet; thence South 75 feet to the point of beginning, in Lake County, Indiana. Key No. 24-2-24.

Part of the East Half of the Southeast Quarter of Section 20, Township 34 North, Range 9 West of Second Principal Meridian, in Lake County, Indiana, described as follows: Commencing 1220 feet North of the Southeast corner of said Southeast Quarter; thence North 108.9 feet; thence West 263 feet; thence South 108.9 feet; thence East 263 feet to the place of beginning. Key No. 24-2-23.

Part of the Southeast Quarter of the Southeast Quarter of Section 20, Township 34 North, Range 9 West of the Second Principal Meridian, in Lake County, Indiana, described as follows: Commencing at a point 1070 feet North and 263 feet West of the Southeast corner of said Section; thence West 63 feet, North 258.9 feet; thence East 63 feet; thence South 258.9 feet to the place of beginning, containing .398 acres, more or less. Key No. 24-2-26.