

THIS FORM HAS BEEN APPROVED BY THE INDIANA STATE BAR ASSOCIATION FOR USE BY LAWYERS ONLY. THE SELECTION OF A FORM OF INSTRUMENT, FILLING IN BLANK SPACES, STRIKING OUT PROVISIONS AND INSERTION OF SPECIAL CLAUSES, CONSTITUTES THE PRACTICE OF LAW AND MAY ONLY BE DONE BY A LAWYER.

# 91023130 REAL ESTATE MORTGAGE

This indenture witnesseth that **THOMAS L. KIRSCH and PATRICIA K. KIRSCH,**  
Husband and Wife

of Lake County, Indiana , as **MORTGAGOR** ,

Mortgage and warrant to **THOMAS L. KIRSCH II**

of Lake County, Indiana **Indiana, as MORTGAGEE** ,

the following real estate in LAKE County  
State of Indiana, to wit:

Lot 1, Thomas L. Kirsch Addition to the  
Town of Munster, Lake County, Indiana,  
as shown in Plat Book 59, page 7, in  
Lake County, Indiana.

(Commonly known as 131 Ridge Road, Munster, IN)

**This Document is the property of  
the Lake County Recorder!**

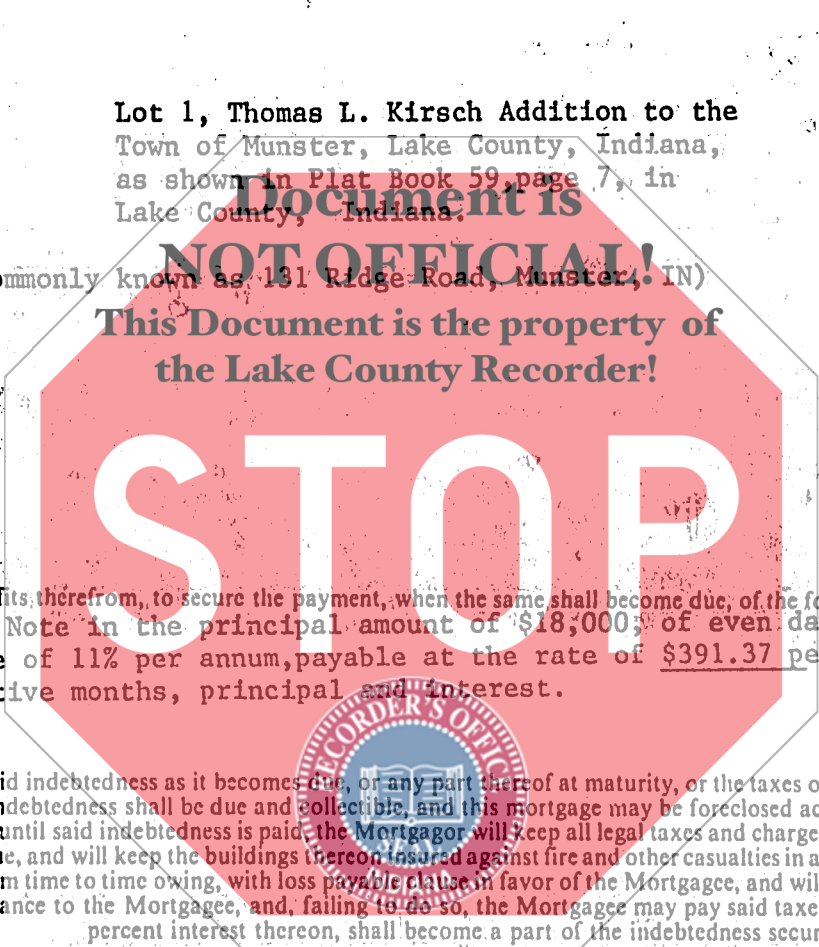

STATE OF INDIANA, S. NO.  
LAKE COUNTY  
FILED  
MAY 15 12 51 PM '91  
ROBERT W. ROSS  
RECORDER

and the rents and profits therefrom, to secure the payment, when the same shall become due, of the following indebtedness:  
Promissory Note in the principal amount of \$18,000, of even date, with interest  
at the rate of 11% per annum, payable at the rate of \$391.37 per month, for  
60 consecutive months, principal and interest.

Upon failure to pay said indebtedness as it becomes due, or any part thereof at maturity, or the taxes or insurance hereinafter stipulated, then said indebtedness shall be due and collectible, and this mortgage may be foreclosed accordingly. It is further expressly agreed that, until said indebtedness is paid, the Mortgagor will keep all legal taxes and charges against the real estate paid as they become due, and will keep the buildings thereon insured against fire and other casualties in an amount at least equal to the indebtedness from time to time owing, with loss payable clause in favor of the Mortgagee, and will, upon request, furnish evidence of such insurance to the Mortgagee, and, failing to do so, the Mortgagee may pay said taxes or insurance, and the amount so paid, with \_\_\_\_\_ percent interest thereon, shall become a part of the indebtedness secured by this mortgage.

### Additional Covenants:

State of Indiana, LAKE County, ss: Dated this 3rd Day of May 1991

Before me, the undersigned, a Notary Public in and for said County and State, this 3rd day of May 1991 personally appeared: Thomas L. Kirsch and Patricia K. Kirsch, Husband and Wife

and acknowledged the execution of the foregoing mortgage. In witness whereof, I have hereunto subscribed my name and affixed my official seal.

My Commission expires 3/20 1992

Judith A. Osinski Signature

JUDITH A. OSINSKI Printed Name

Resident of LAKE County

This instrument prepared by Thomas L. Kirsch, 131 Ridge Road, Munster, IN 46321 Attorney at Law

MAIL TO:

6.00