

91023129

REAL ESTATE MORTGAGE

This indenture witnesseth that: **THOMAS L. KIRSCH and PATRICIA K. KIRSCH,**
Husband and Wife

of Lake County, Indiana, as **MORTGAGOR**,

Mortgage and warrant to **THOMAS L. KIRSCH, for the benefit of TRACY N. KIRSCH,**
a minor

of Lake County, Indiana **Indiana, as MORTGAGEE**,

the following real estate in LAKE County
State of Indiana, to wit:

Lot 1, Thomas L. Kirsch Addition to the
Town of Munster, Lake County, Indiana,
as shown in Plat Book 59, page 7, in
Lake County, Indiana.

(Commonly known as 131 Ridge Road, Munster, IN)
This Document is the property of
the Lake County Recorder!

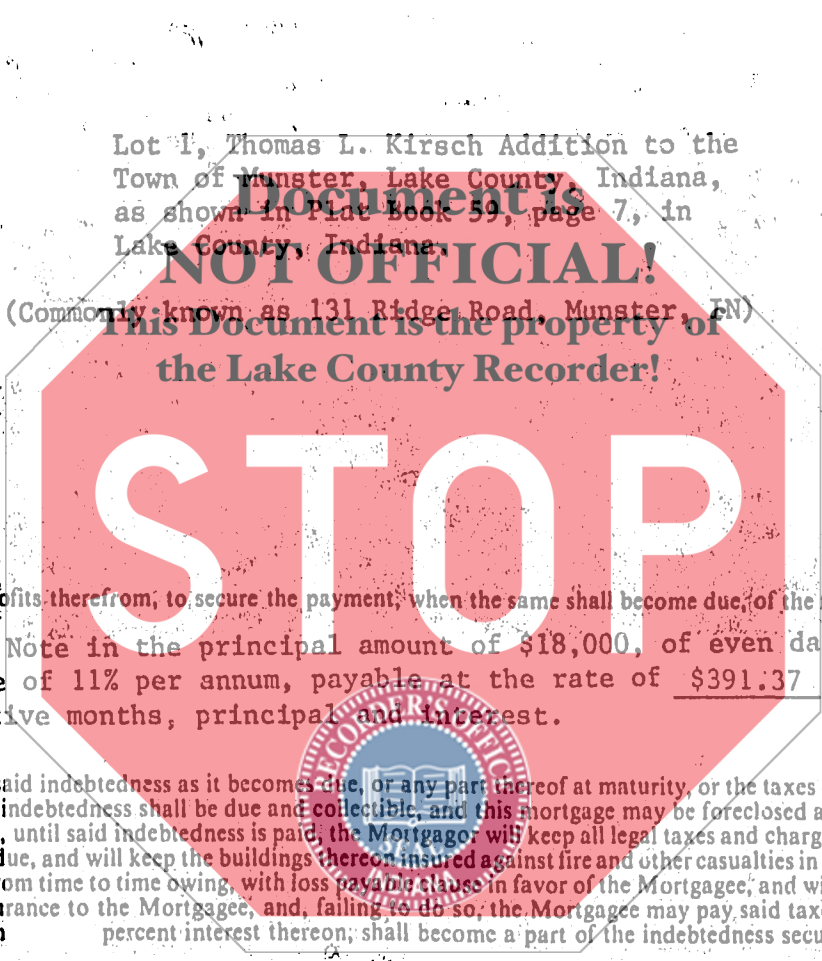

INDIANA STATE BAR
LAKE COUNTY
FILED FOR RECORD
MAY 15 12 51 PM '91
ROBERT BOE FARELAND
RECORDER

and the rents and profits therefrom, to secure the payment, when the same shall become due, of the following indebtedness:
Promissory Note in the principal amount of \$18,000, of even date, with interest
at the rate of 11% per annum, payable at the rate of \$391.37 per month, for
60 consecutive months, principal and interest.

Upon failure to pay said indebtedness as it becomes due, or any part thereof at maturity, or the taxes or insurance hereinafter stipulated, then said indebtedness shall be due and collectible, and this mortgage may be foreclosed accordingly. It is further expressly agreed that, until said indebtedness is paid, the Mortgagor will keep all legal taxes and charges against the real estate paid as they become due, and will keep the buildings thereon insured against fire and other casualties in an amount at least equal to the indebtedness from time to time owing, with loss payable clause in favor of the Mortgagee; and will, upon request, furnish evidence of such insurance to the Mortgagee, and, failing to do so, the Mortgagee may pay said taxes or insurance, and the amount so paid, with percent interest thereon, shall become a part of the indebtedness secured by this mortgage.

Additional Covenants:

State of Indiana, LAKE County, ss: Dated this 3rd Day of May 19 91

Before me, the undersigned, a Notary Public in and for said County and State, this 3rd day of May 19 91 personally appeared: **Thomas L. Kirsch and Patricia K. Kirsch, Husband and Wife**

and acknowledged the execution of the foregoing mortgage. In witness whereof, I have hereunto subscribed my name and affixed my official seal.
My commission expires 3/20 19 92

Judith A. Losinski
Signature
JUDITH A. LOSINSKI
Printed Name
Resident of LAKE County

[Signature] Seal
THOMAS L. KIRSCH
[Signature] Seal
PATRICIA K. KIRSCH
Seal

This instrument prepared by THOMAS L. KIRSCH, 131 Ridge Road, Munster, IN 46321 Attorney at Law

MAIL TO: _____ 600