

THIS FORM HAS BEEN APPROVED BY THE INDIANA STATE BAR ASSOCIATION FOR USE BY LAWYERS ONLY. THE SELECTION OF A FORM OF INSTRUMENT, FILLING IN BLANK SPACES, STRIKING OUT PROVISIONS AND INSERTION OF SPECIAL CLAUSES, CONSTITUTES THE PRACTICE OF LAW AND MAY ONLY BE DONE BY A LAWYER.

MAIL TAX BILLS TO: Morline Moxley, 20026 Enslow Drive, Carson, CA 90746 TAX KEY NO: \_\_\_\_\_

91022882

# QUIT-CLAIM DEED

This indenture witnesseth that Morline Moxley, James Edward Moxley, III, and Karen X. Barnes

of Los Angeles County in the State of California

Releases and quit claims to Morline Moxley  
20026 Enslow Drive  
Carson, CA 90746

of Los Angeles County in the State of California  
for and in consideration of One (1) Dollar and other good and valuable consideration,  
the receipt whereof is hereby acknowledged, the following Real Estate in Lake County  
in the State of Indiana, to wit:

STATE OF INDIANA/S.S. H  
LAKE COUNTY  
FILED  
MAY 15 9 16 AM '91  
ROBERT HOOVER, RECORDER

Key # 43-419-31

Lot 30, Block 1, Georgetown Addition,  
City of Gary, Indiana, Plat Book 30,  
Page 17, Lake County, Indiana

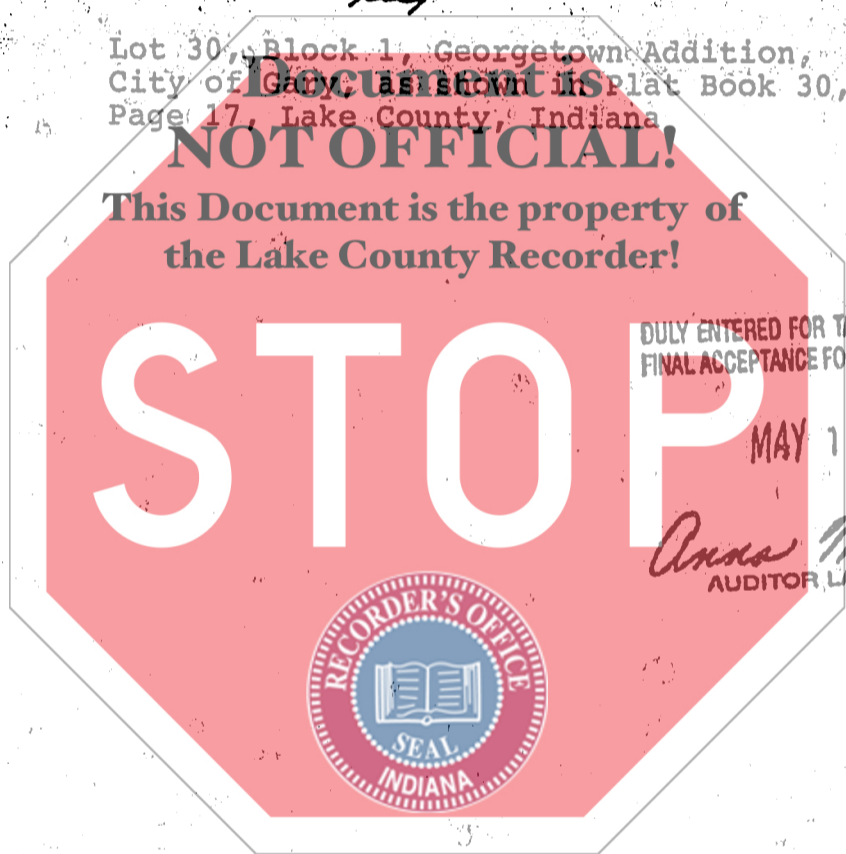

DULY ENTERED FOR TAXATION SUBJECT TO FINAL ACCEPTANCE FOR TRANSFER.

MAY 13 1991

Anna M. Anton  
AUDITOR LAKE COUNTY



California  
State of Indiana, Los Angeles County, ss:

Before me, the undersigned, a Notary Public in and for said County and State, this 19TH day of APRIL 19 91 personally appeared:

MORLINE MOXLEY  
JAMES EDWARD MOXLEY, III  
KAREN X. BARNES

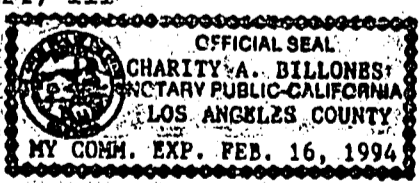

Dated this 19TH Day of APRIL 19 91

Morline Moxley  
Morline Moxley  
James Edward Moxley, III  
James Edward Moxley, III  
Karen X. Barnes  
Karen X. Barnes

And acknowledged the execution of the foregoing deed. In witness whereof, I have hereunto subscribed my name and affixed my official seal. My commission expires FEB. 16, 1994

Charity A. Billones  
Notary Public

Resident of LOS ANGELES County

This instrument prepared by Luci L. Horton, Attorney at Law

4445 Broadway, Gary, IN 46409

MAIL TO:

00081  
700