

91022862

*Galum, Galum + Leoney
Calumet Bldg. 5231 Hohmann*

THIS FORM HAS BEEN APPROVED BY THE INDIANA STATE BAR ASSOCIATION FOR USE BY LAWYERS ONLY. THE SELECTION OF A FORM OF INSTRUMENT, FILLING IN BLANK SPACES, STRIKING OUT PROVISIONS AND INSERTION OF SPECIAL CLAUSES, CONSTITUTES THE PRACTICE OF LAW AND MAY ONLY BE DONE BY A LAWYER.

RELEASE OF MECHANIC'S LIEN

For a valuable consideration, the receipt whereof is hereby acknowledged, a certain Mechanic's Lien existing in favor of HUBINGER LANDSCAPING CORPORATION and against TOWNE SQUARE ASSOCIATES LTD on the following real estate, to-wit:

See attached Exhibit A.

STATE OF INDIANA/S.S. NO. LAKE COUNTY FILED FOR RECORD MAY 15 8 45 AM '91 ROBERT J. BOSE FREELAND RECORDER

a written notice of an intention to hold which lien was filed in the office of the Recorder of Lake County, State of Indiana and recorded ~~copy~~ as ~~an~~ ~~Instrument~~ ~~Record~~ No. 068088 in said county is hereby declared fully satisfied and released this 25th day of April, 1991. **Document is NOT OFFICIAL! This Document is the property of the Lake County Recorder!**

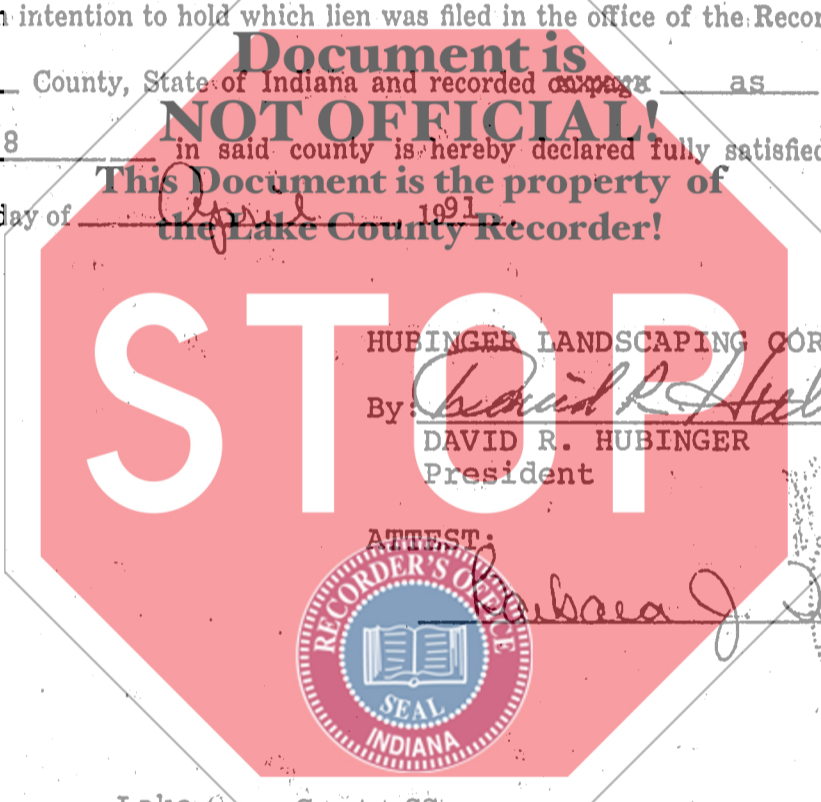

HUBINGER LANDSCAPING CORPORATION
By: David R. Hubinger (Seal)
DAVID R. HUBINGER
President



State of Indiana Lake County, SS:
Before me Thelma K. Urberski a Notary Public in and for said County and State, this 25th day of April, 1991. Personally appeared DAVID R. HUBINGER and acknowledged the execution of the above and foregoing release.

Witness my hand and official seal. Thelma K. Urberski Notary Public.
Resident of Lake County.
My commission expires: 8-4-93
This instrument was prepared by JOHN E. CHEVIGNY, Attorney at Law.

700

Part of the South Half of the Northeast Quarter of Section 17,
Township 35 North, Range 8 West of the Second Principal Meridian,
In Lake County, Indiana, more particularly described as follows:

Commencing at the Northeast corner of said Section 17, thence
South 00 degrees 04 minutes 02 seconds West 2643.58 feet along
the East line of said Section 17 to the Southeast corner of the
South Half of the Northeast Quarter of said Section 17; thence
North 89 degrees 46 minutes 13 seconds West 600.00 feet along the
South line of the South Half of the Northeast Quarter of said
Section 17 to the Point of Beginning; thence continuing along
said last mentioned course 1446.82 feet to a point that is 600.00
feet East of the Southwest corner of the Northeast Quarter of
said Section 17; thence North 00 degrees 00 minutes 00 seconds
West 1236.42 feet to the South line of the North 5 rods of the
West 60 rods of the said South Half; thence South 89 degrees 50
minutes 37 seconds East 720.00 feet; thence North 00 degrees 00
minutes 00 seconds West 82.50 feet along the East line of the
North 5 rods of the West 80 rods; thence South 89 degrees 50
minutes 37 seconds East 1008.32 feet along the North line of the
South Half of the Northeast Quarter of said Section 17; thence
South 40 degrees 00 minutes 00 seconds West 907.81 feet; thence
South 39 degrees 00 minutes 00 seconds East 353.23 feet; thence
South 28 degrees 00 minutes 00 seconds East 170.25 feet; thence
South 00 degrees 04 minutes 02 seconds West 200.00 feet to the
Point of Beginning, containing 40.975 acres, more or less.

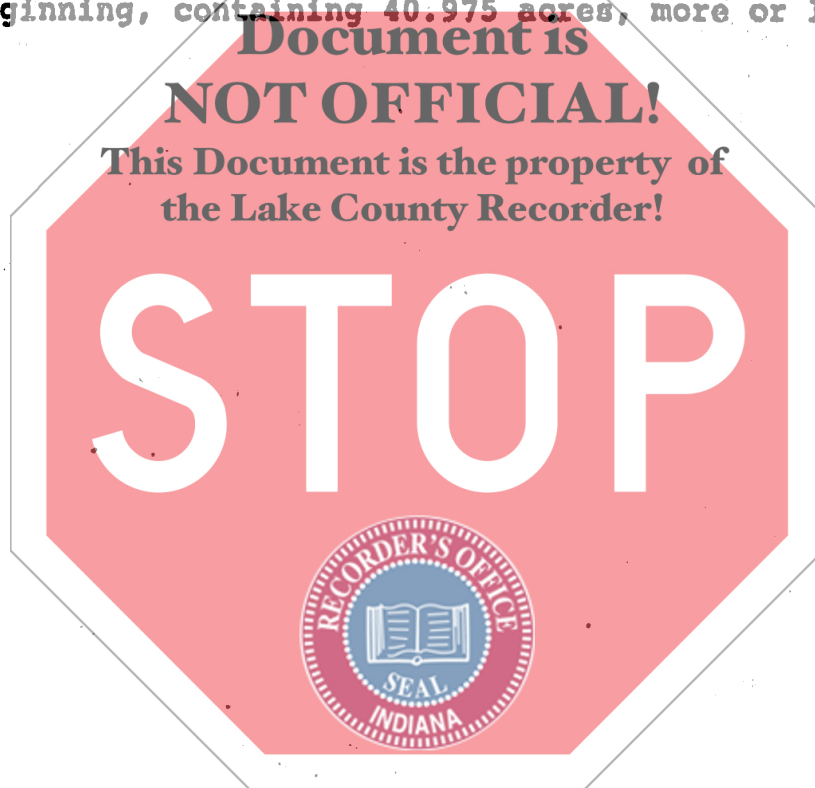

Document is
NOT OFFICIAL!

This Document is the property of
the Lake County Recorder!

EXHIBIT "A"