

159283

John H

91022718

Assignment of Mortgage

THIS INSTRUMENT of writing by and between LAPORTE BANK AND TRUST COMPANY hereinafter referred to as the party of the first part, and SECURITY FEDERAL BANK, a F.S.B. hereinafter referred to as the party of the second part, WITNESSETH:

That, for value received, the said party of the first part does hereby sell, assign, transfer and set over, unto the said party of the second part, its successors and assigns, that certain mortgage hereinafter described, together with the note secured thereby and described herein, and all sums of money due and to become due thereon.

Said mortgage was executed to LAPORTE BANK AND TRUST COMPANY by JAMES J. RUDASKI AND KATHLEEN A. RUDASKI, HUSBAND AND WIFE to secure one promissory note for NINETY FIVE THOUSAND SEVEN HUNDRED FIFTY AND 00/100----- Dollars and was recorded on the 2nd day of May, 19 91, in the office of the Recorder of Lake County Indiana. as Document Number 91020884

LOT 12 IN WOODLAND ESTATES 5TH ADDITION, BLOCK 3, IN THE TOWN OF GRIFFITH, AS PER PLAT THEREOF, RECORDED IN PLAT BOOK 64 PAGE 57, IN THE OFFICE OF THE RECORDER OF LAKE COUNTY, INDIANA.

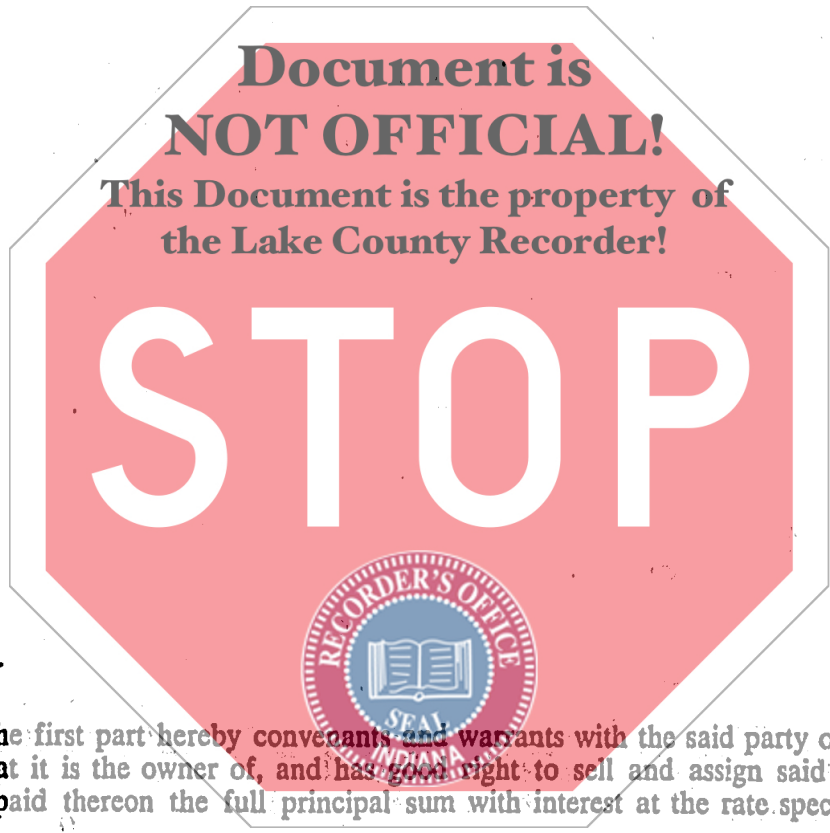

STATE OF INDIANA/S.S. NO. LAKE COUNTY FILED FOR RECORD MAY 14 10 04 AM '91 ROBERT WOODRUFF BELAND RECORDER

Said party of the first part hereby conveys and warrants with the said party of the second part, its successors and assigns, that it is the owner of, and has good right to sell and assign said note and mortgage, and that there remains unpaid thereon the full principal sum with interest at the rate specified in the said note.

IN TESTIMONY WHEREOF, witness the signature and corporate seal of the party of the first part by and through its proper officers this 3rd day of May, 19 91

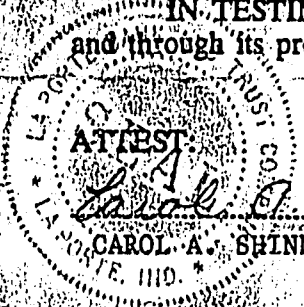

ATTEST: Carol A. Shinn CAROL A. SHINN, ASST. VICE PRESIDENT

LAPORTE BANK AND TRUST COMPANY BY D. Eugene Christian D. EUGENE CHRISTIAN, VICE President

STATE OF INDIANA COUNTY OF LA PORTE SS:

Before me, the undersigned, a Notary Public, personally appeared D. EUGENE CHRISTIAN AND CAROL A. SHINN who as VICE President and ASST. VICE PRESIDENT respectively, acknowledged the execution of the foregoing assignment to be the act and deed of LAPORTE BANK AND TRUST COMPANY a corporation, for the uses and purposes therein named.

WITNESS my hand and notarial seal this 3rd day of May, 1991

My Commission expires: AUGUST 12, 1994 PREPARED BY: D. EUGENE CHRISTIAN

JUDITH L. BAYSINGER Notary Public RESIDENT OF LAPORTE COUNTY

500 K