

THIS FORM HAS BEEN APPROVED BY THE INDIANA STATE BAR ASSOCIATION FOR USE BY LAWYERS ONLY. THE SELECTION OF A FORM OF INSTRUMENT, FILLING IN BLANK SPACES, STRIKING OUT PROVISIONS AND INSERTION OF SPECIAL CLAUSES, CONSTITUTES THE PRACTICE OF LAW AND MAY ONLY BE DONE BY A LAWYER.

Mail tax bills to: 81022415

Tax Key No. _____

1951 CHIPPEWA DRIVE
SCHERERVILLE, IN 46375

WARRANTY DEED

This indenture witnesseth that

DANIEL F. SULLIVAN AND JUDITH E. SULLIVAN, HUSBAND AND WIFE

of LAKE County in the State of INDIANA

Convey and warrant to

MARILYN S. QUALLS

of LAKE County in the State of INDIANA

for and in consideration of Ten Dollars and other good and valuable consideration the receipt whereof is hereby acknowledged, the following Real Estate in LAKE in the State of Indiana, to wit:

STATE OF INDIANA/S.S. N
LAKE COUNTY
FILED
MAY 13 10 02 AM '91
ROBERT G. COOPER, RECORDER

LOT 34 IN BOHLING'S SHAWNEE TRAILS SECOND ADDITION TO THE TOWN OF SCHERERVILLE, AS PER PLAT THEREOF, RECORDED IN PLAT BOOK 37 PAGE 64 IN THE OFFICE OF THE RECORDER OF LAKE COUNTY, INDIANA.
Commonly known as: 1951 CHIPPEWA DRIVE, SCHERERVILLE, IN 46375.

Subject to past and current year real estate taxes.
Subject to easements, restrictions and covenants of record, if any.

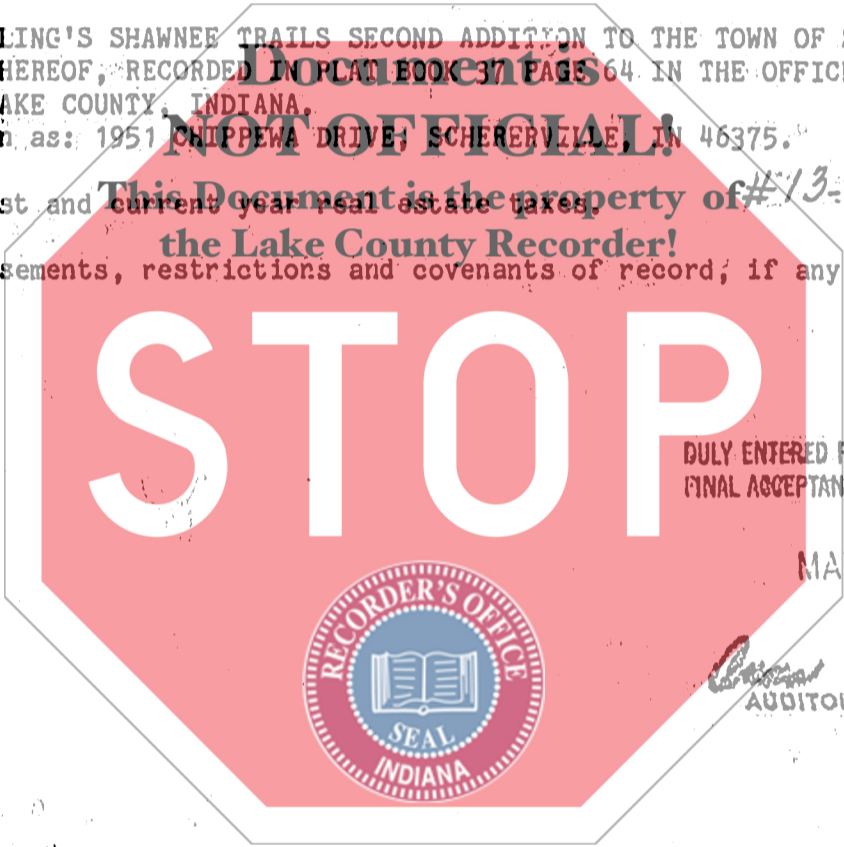

DULY ENTERED FOR TAXATION SUBJECT TO FINAL ACCEPTANCE FOR TRANSFER.

MAY 8 1991

Carroll N. Antos
AUDITOR LAKE COUNTY

State of Indiana, Lake County, ss:

Before me, the undersigned, a Notary Public in and for said County and State, this 26th day of April 1991 personally appeared:

DANIEL F. SULLIVAN AND JUDITH E. SULLIVAN,
HUSBAND AND WIFE

Dated: this 26th day of April 1991

Daniel F. Sullivan
DANIEL F. SULLIVAN

Judith E. Sullivan
JUDITH E. SULLIVAN

And acknowledged the execution of the foregoing deed. In witness whereof, I have hereunto subscribed my name and affixed my official seal. My commission expires October 17, 1994

Linda S. Wood
LINDA S. WOOD Notary Public

Resident of Lake County.

This instrument prepared by JOHN D. BRECLAW Attorney at Law

735 West Glen Park Avenue
Griffith, Indiana 46319
(219) 924-8750

00005-A