

THIS FORM HAS BEEN APPROVED BY THE INDIANA STATE BAR ASSOCIATION FOR USE BY LAWYERS ONLY. THE SELECTION OF A FORM OF INSTRUMENT, FILLING IN BLANK SPACES, STRIKING OUT PROVISIONS AND INSERTION OF SPECIAL CLAUSES, CONSTITUTES THE PRACTICE OF LAW AND MAY ONLY BE DONE BY A LAWYER.

Mail tax bills to: 91021598

Tax Key No.: 10-51-53

2615 Castlewood
Dyer, IN. 46311

WARRANTY DEED

L3508

This indenture witnesseth that SCOTT E. BLUE and CAROL BLUE,
Husband and Wife

of Will County in the State of Illinois

Convey and warrant to JERRY T. CHRIST

of Lake County in the State of Indiana

for and in consideration of \$10.00 and other good and valuable consideration the receipt whereof is hereby acknowledged, the following Real Estate in Lake County in the State of Indiana, to wit:

STATE OF INDIANA / S.S. NO. 1
FILED
MAY 8 8 50 AM '91
ROBERT RECORDER
LAKELAND

Lot 951 in Lakes of the Four Seasons, Unit No. 5, as per plat thereof, recorded December 27, 1967 in Plat Book 38 page 62, in the Office of the Recorder of Lake County, Indiana.

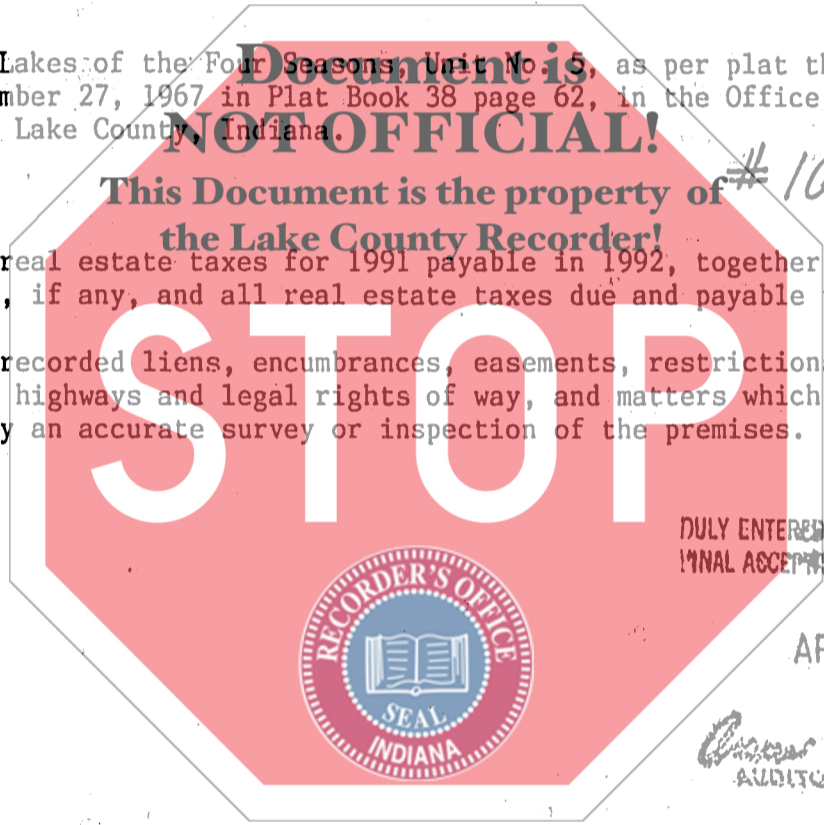

Subject to real estate taxes for 1991 payable in 1992, together with delinquency and penalty, if any, and all real estate taxes due and payable thereafter.

Subject to recorded liens, encumbrances, easements, restrictions, ditches and drains, highways and legal rights of way, and matters which would be disclosed by an accurate survey or inspection of the premises.

State of Indiana, Lake County, ss:
Before me, the undersigned, a Notary Public in and for said County and State, this 26th day of April 19 91 personally appeared:

Scott E. Blue
Carol Blue

Dated this 26th Day of April 19 91

Scott E. Blue
Scott E. Blue

Carol Blue
Carol Blue

And acknowledged the execution of the foregoing deed. In witness whereof, I have hereunto subscribed my name and affixed my official seal. My commission expires 12-17-19 93

Roberta S. Tate
Roberta S. Tate Notary Public

Resident of Lake County.

This instrument prepared by RICHARD A. PARKS
Crown Point, IN

01687
Attorney at Law CM