

THIS FORM HAS BEEN APPROVED BY THE INDIANA STATE BAR ASSOCIATION FOR USE BY LAWYERS ONLY. THE SELECTION OF A FORM OF INSTRUMENT, FILLING IN BLANK SPACES, STRIKING OUT PROVISIONS AND INSERTION OF SPECIAL CLAUSES, CONSTITUTES THE PRACTICE OF LAW AND MAY ONLY BE DONE BY A LAWYER.

Mall tax bills to: 91021091

Tax Key No. \_\_\_\_\_

8820 JACKSON AVENUE  
MUNSTER, IN 46321

# WARRANTY DEED

This indenture witnesseth that

ROBERT P. THORNTON AND THERESA C. THORNTON, HUSBAND AND WIFE

of LAKE County in the State of INDIANA

Convey and warrant to

ANTHONY F. TAVITAS AND ELIZABETH THOMAS TAVITAS, HUSBAND AND WIFE

of LAKE County in the State of INDIANA  
for and in consideration of Ten Dollars and other good and valuable consideration  
the receipt whereof is hereby acknowledged, the following Real Estate in LAKE County  
in the State of Indiana, to wit:

LOT 3 IN RUETH ESTATES 2ND ADDITION, BLOCK 9, TO THE TOWN OF MUNSTER, AS PER  
PLAT THEREOF, RECORDED IN PLAT BOOK 43 PAGE 5 IN THE OFFICE OF THE RECORDER OF  
LAKE COUNTY, INDIANA.  
Commonly known as: 8820 JACKSON AVENUE, MUNSTER, IN 46321. # 28-360-3

Subject to past and current year real estate taxes of  
the Lake County Recorder!  
Subject to easements, restrictions and covenants of record, if any.

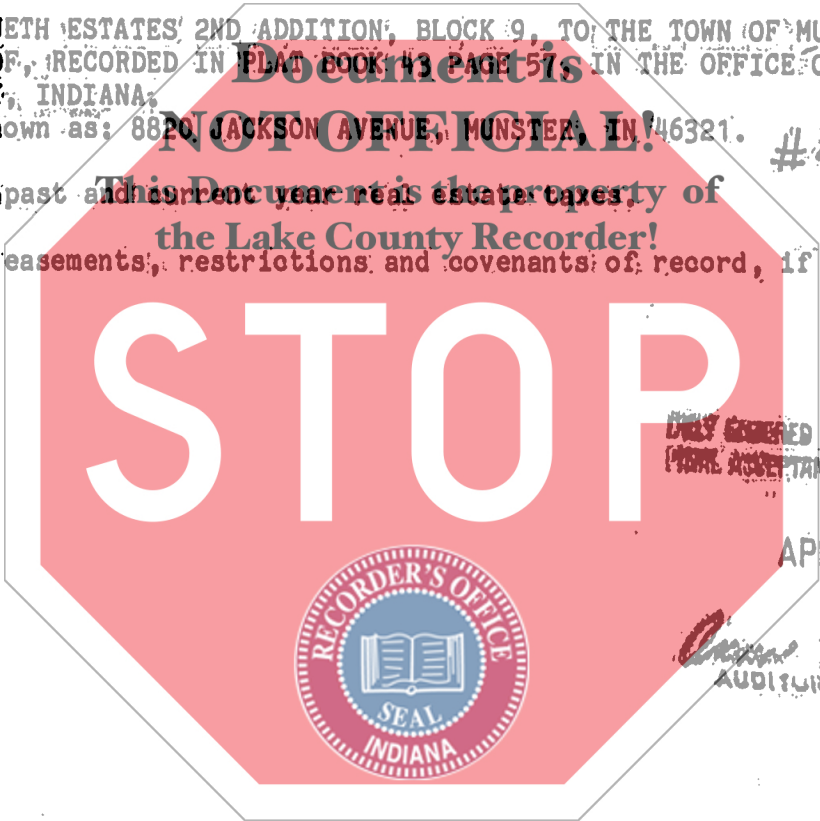

State of Indiana, Lake County, ss:  
Before me, the undersigned, a Notary Public in and for said County  
and State, this 19th day of April 1991  
personally appeared:

Dated this 19th day of April 1991

ROBERT P. THORNTON AND THERESA C.  
THORNTON, HUSBAND AND WIFE

*Robert P. Thornton*  
ROBERT P. THORNTON  
*Theresa C. Thornton*  
THERESA C. THORNTON

And acknowledged the execution of the foregoing deed. In witness  
whereof, I have hereunto subscribed my name and affixed my of-  
ficial seal. My commission expires October 1994

*Linda S. Wood*  
LINDA S. WOOD Notary Public  
Resident of Lake County.

This instrument prepared by JOHN D. BRECLAW  
735 West Glen Park Avenue  
Griffith, Indiana 46319  
(219) 924-8750

01418 700  
Attorney at Law