

THIS FORM HAS BEEN APPROVED BY THE INDIANA STATE BAR ASSOCIATION FOR USE BY LAWYERS ONLY; THE SELECTION OF A FORM OF INSTRUMENT, FILLING IN BLANK SPACES, STRIKING OUT PROVISIONS AND INSERTION OF SPECIAL CLAUSES, CONSTITUTES THE PRACTICE OF LAW AND MAY ONLY BE DONE BY A LAWYER.

Mail tax bills to: 91020170

Tax Key No.:

9225 PARK DRIVE
ST. JOHN, INDIANA 46373

WARRANTY DEED

STATE OF INDIANA/S.S. NO.
LAKE COUNTY
FILED IN PLAT BOOK
APR 29 10 09 AM '91
ROBERT WOOD FREELAND
RECORDER

This indenture witnesseth that

DAVID E. WELCH AND JEANETTE WELCH, HUSBAND AND WIFE

of Lake County in the State of Indiana

Convey and warrant to

JAMES J. MULLINS AND DIANA MULLINS, HUSBAND AND WIFE

of Lake County in the State of Indiana
for and in consideration of Ten Dollars and other good and valuable consideration
the receipt whereof is hereby acknowledged, the following Real Estate in LAKE County
in the State of Indiana, to wit:

LOT 10 IN SECOND SPRING HILL ADDITION TO ST. JOHN, AS PER PLAT THEREOF, RECORDED
IN PLAT BOOK 30 PAGE 94, IN THE OFFICE OF THE RECORDER OF LAKE COUNTY, INDIANA.
Commonly known as: 9225 PARK DRIVE, ST. JOHN, INDIANA 46373.

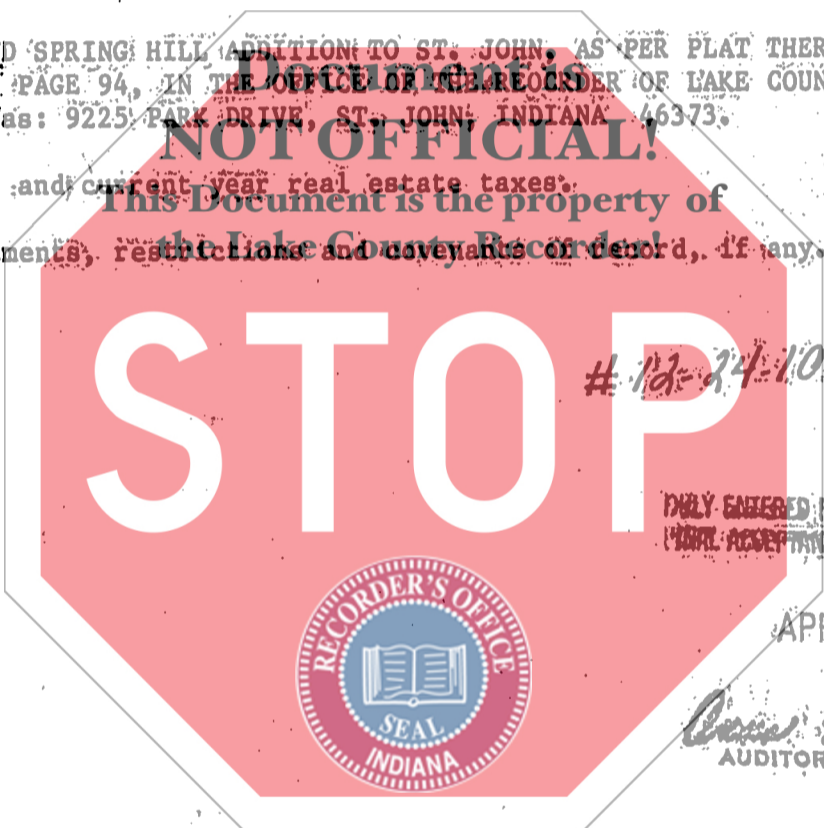

Subject to past and current year real estate taxes.
Subject to easements, restrictions and covenants of record, if any.

DULY ENTERED FOR TAXATION SUBJECT TO
FORM ACCEPTANCE FOR TRACER.

APR 25 1991

David N. Anton
AUDITOR LAKE COUNTY

State of Indiana, Lake County, ss:
Before me, the undersigned, a Notary Public in and for said County
and State, this 18th day of April 1991
personally appeared:

Dated this 18th Day of April 1991

DAVID E. WELCH AND JEANETTE WELCH, HUSBAND
AND WIFE

David E. Welch
DAVID E. WELCH

Jeanette Welch
JEANETTE WELCH

And acknowledged the execution of the foregoing deed. In witness
whereof, I have hereunto subscribed my name and affixed my of-
ficial seal. My commission expires December 3 1993.

Jean Henderson
JEAN HENDERSON
Notary Public

Resident of Lake County.

This instrument prepared by JOHN D. BRECLAW Attorney at Law.
735 West Glen Park Avenue
Griffith, Indiana 46319
(219) 924-8750

01317

700
te