

91018554

# RELEASE OF MECHANIC'S LIEN

For a valuable consideration, the receipt whereof is hereby acknowledged, a certain Mechanic's Lien existing in favor of FRANK T. COWGILL, d/b/a COWGILL CONSTRUCTION and against TOWNE SQUARE ASSOCIATES, LTD

on the following real estate, to-wit:  
See attached Exhibit A

STATE OF INDIANA, S.S. NO. LAKE COUNTY  
APR 19 8 50 AM '91  
RECORDS SECTION

a written notice of an intention to hold which lien was filed in the office of the Recorder of Lake County, State of Indiana and recorded as Instrument No. 048355 in said county is hereby declared fully satisfied and released this 26th day of December, 1990.

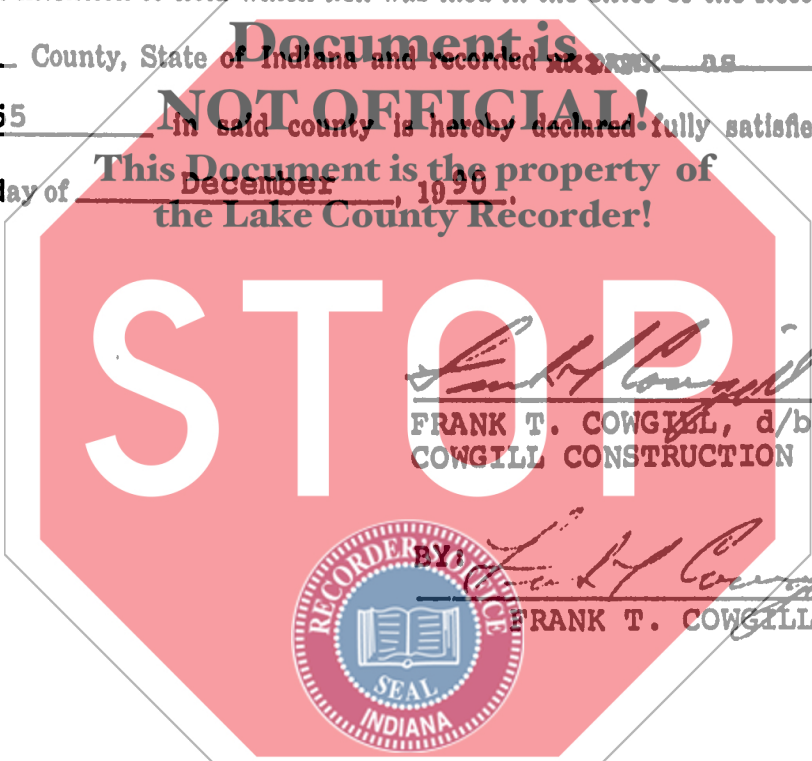

Frank T. Cowgill (Seal)  
FRANK T. COWGILL, d/b/a  
COWGILL CONSTRUCTION

Frank T. Cowgill (Seal)  
FRANK T. COWGILL

State of Indiana LAKE County, SS:  
Before me Carolyn H. Grabowski a Notary Public in and for said County and State, this 26th day of December, 1990. Personally appeared FRANK T. COWGILL and acknowledged the execution of the above and foregoing release.

Witness my hand and official seal. Carolyn H. Grabowski Notary Public.  
CAROLYN/H. GRABOWSKI  
Resident of LAKE County.

My commission expires: February 17, 1991

This instrument was prepared by JOHN E. CHEVIGNY, Attorney at Law.  
5231 Hobman  
Hm 46320

700

**Parcel "II A"**

Part of the South Half of the Northeast Quarter of Section 17, Township 35 North, Range 8 West of the Second Principal Meridian in Lake County, Indiana, more particularly described as follows: Commencing at the Northeast corner of said Section 17; thence South 0 degrees 04 minutes 02 seconds West along the East line of said Northeast Quarter, a distance of 1321.79 feet; thence North 89 degrees 50 minutes 37 seconds West along the North line of the South Half of said Northeast Quarter, a distance of 320.00 feet to the point of beginning; thence South 40 degrees 00 minutes 00 seconds West, a distance of 971.70 feet; thence Northwesterly along a curve concave to the Southwest and having a radius of 276.27 feet (the chord of which curve bears North 78 degrees 24 minutes 42 seconds West a distance of 166.96 feet), an arc distance of 169.61 feet; thence South 84 degrees 00 minutes 00 seconds West, a distance of 115.00 feet; thence South 55 degrees 33 minutes 00 seconds West, a distance of 110.00 feet; thence South 28 degrees 30 minutes 00 seconds West, a distance of 289.87 feet; thence South 21 degrees 00 minutes 00 seconds West, a distance of 240.96 feet; thence South 0 degrees 13 minutes 47 seconds West, a distance of 50.00 feet; thence North 89 degrees 46 minutes 13 seconds West along the South line of said Northeast Quarter, a distance of 508.97 feet; thence North 0 degrees 00 minutes 00 seconds East, a distance of 1236.42 feet; thence South 89 degrees 50 minutes 37 seconds East, a distance of 720.00 feet; thence North 0 degrees 00 minutes 00 seconds East, a distance of 82.50 feet; thence South 89 degrees 50 minutes 37 seconds East, a distance of 1008.32 feet to the point of beginning, all in Merrillville, Lake County, Indiana;

**Parcel "II B"**

Part of the South Half of the Northeast Quarter of Section 17, Township 35 North, Range 8 West of the Second Principal Meridian in Lake County, Indiana, more particularly described as follows: Commencing at the Northeast corner of said Section 17; thence South 0 degrees 04 minutes 02 seconds West along the East line of the Northeast Quarter of said Section 17, a distance of 264.96 feet; thence North 89 degrees 46 minutes 13 seconds West, a distance of 645.00 feet to the point of beginning; thence North 0 degrees 01 minute 13 seconds West, a distance of 892.85 feet; thence North 0 degrees 13 minutes 47 seconds East, a distance of 50.00 feet; thence North 21 degrees 00 minutes 00 seconds East, a distance of 240.96 feet; thence North 28 degrees 30 minutes 00 seconds East, a distance of 289.87 feet; thence North 55 degrees 33 minutes 00 seconds East, a distance of 110.00 feet; thence North 84 degrees 00 minutes 00 seconds East, a distance of 115.00 feet to a point of curve; thence Southeasterly along a curve concave to the Southwest and having a radius of 276.27 feet an arc distance of 274.84 feet; thence South 39 degrees 00 minutes 00 seconds East, a distance of 250.00 feet to a point of curve; thence Southeasterly along a curve concave to the Southwest and having a radius of 280.60 feet an arc distance of 192.13 feet; thence South 0 degrees 13 minutes 47 seconds West, a distance of 134.63 feet to the point of beginning, all in Merrillville, Lake County, Indiana;

