

158524

THIS FORM HAS BEEN APPROVED BY THE INDIANA STATE BAR ASSOCIATION FOR USE BY LAWYERS ONLY. THE SELECTION OF A FORM OF INSTRUMENT, FILLING IN BLANK SPACES, STRIKING OUT PROVISIONS AND INSERTION OF SPECIAL CLAUSES, CONSTITUTES THE PRACTICE OF LAW AND MAY ONLY BE DONE BY A LAWYER.

Mail tax bills to: 91016754  
6535 Illinois  
Hammond, IN 46323

Tax Key No.: 32-4-37

# WARRANTY DEED

This indenture witnesseth that SHIRLEY MCKENZIE SNYDER

of Lake County in the State of Indiana

Convey and warrant to JAMES W. REED and ALICE L. REED,  
Husband and Wife

STATE OF INDIANA, S.S. NO.  
FILED  
LAKE COUNTY  
APR 10 8 58 AM '91  
ROBERT RECORDER  
ELAND

of Lake County in the State of Indiana

for and in consideration of Ten Dollars and other good and valuable consideration, the receipt whereof is hereby acknowledged, the following Real Estate in Lake County in the State of Indiana, to wit:

32-4-37

Lot 37, 38 and the South 5 feet of Lot 39 in Block 2 in The Baldwin Addition to Gary, in the City of Hammond, as per plat thereof, recorded in Plat Book 10 page 35, in the Office of the Recorder of Lake County, Indiana.

Commonly known as: 6535 Illinois, Hammond, Indiana 46323  
the Lake County Recorder!

Subject to past and current year real estate taxes.

Subject to easements, restrictions and covenants of record, if any.

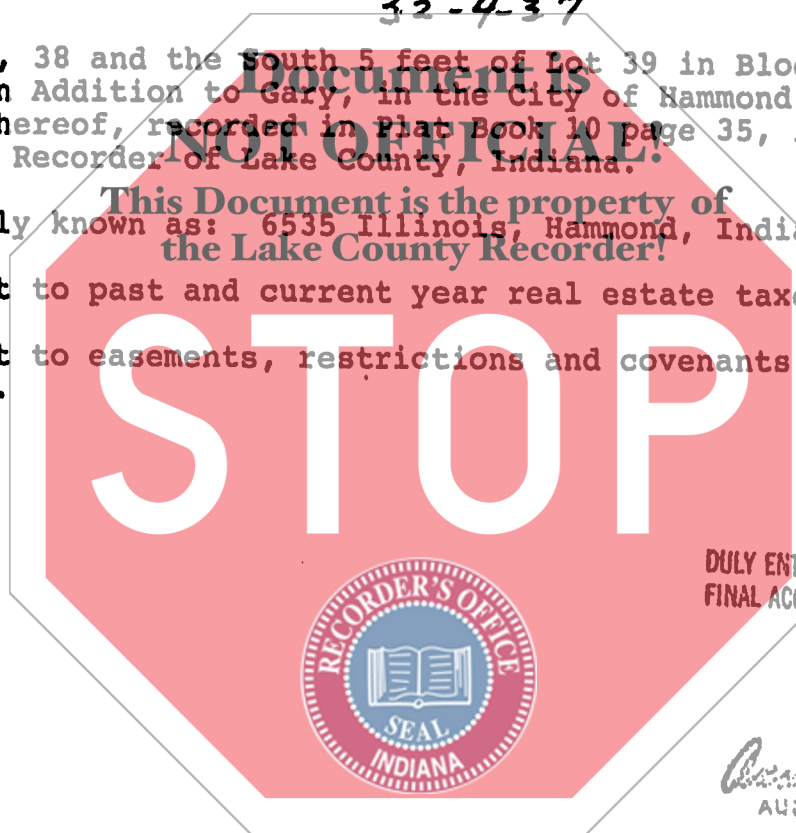

DULY ENTERED FOR TAXATION SUBJECT TO FINAL ACCEPTANCE FOR TRANSFER.

APR 8 1991

*Robert R. Bostrom*  
AUDITOR LAKE COUNTY

TICOR TITLE INSURANCE  
Crown Point, Indiana

State of Indiana, Lake County, ss:

Before me, the undersigned, a Notary Public in and for said County and State, this 27<sup>th</sup> day of March 1991 personally appeared:

SHIRLEY MCKENZIE SNYDER

Dated this 27<sup>th</sup> Day of March 1991

*Shirley McKenzie Snyder*  
SHIRLEY MCKENZIE SNYDER

And acknowledged the execution of the foregoing deed. In witness whereof, I have hereunto subscribed my name and affixed my official seal. My commission expires Feb 12 1992

*James R. Bloom*  
JAMES R. BLOOM Notary Public

Resident of \_\_\_\_\_ County.

This instrument prepared by JOHN D. BRECLAW  
735 West Glen Park Avenue  
Griffith, Indiana 46319  
(219) 924-8750

00298  
700  
K

Attorney at Law

MAIL TO: