

LOT 140 IN SHERWOOD FOREST ELEVENTH ADDITION TO THE TOWN OF SCHERERVILLE, AS PER PLAT THEREOF, RECORDED IN PLAT BOOK 43 PAGE 150, IN THE OFFICE OF THE RECORDER OF LAKE COUNTY, IN

LAWYERS TITLE INS. CORP.
ONE PROFESSIONAL CENTER
SUITE 215
CROWN POINT, IN 46037 51317

91016486 SATISFACTION OF MORTGAGE

This Certifies, That a certain Mortgage executed by FELTEN R. MARSHALL AND JUDITH A. MARSHALL HUSBAND AND WIFE

to BANK OF HIGHLAND
2611 HIGHWAY AVE. HIGHLAND, IN 46322

on 1ST day of APRIL 1987, calling for \$ 15,000.00 and recorded in Mortgage Record No. 911283, page 1, Document is the property of LAKE County, State of Indiana, has been fully paid and satisfied, and the same is hereby released.

WITNESS MY hand and seal, this 3RD day of APRIL 1991

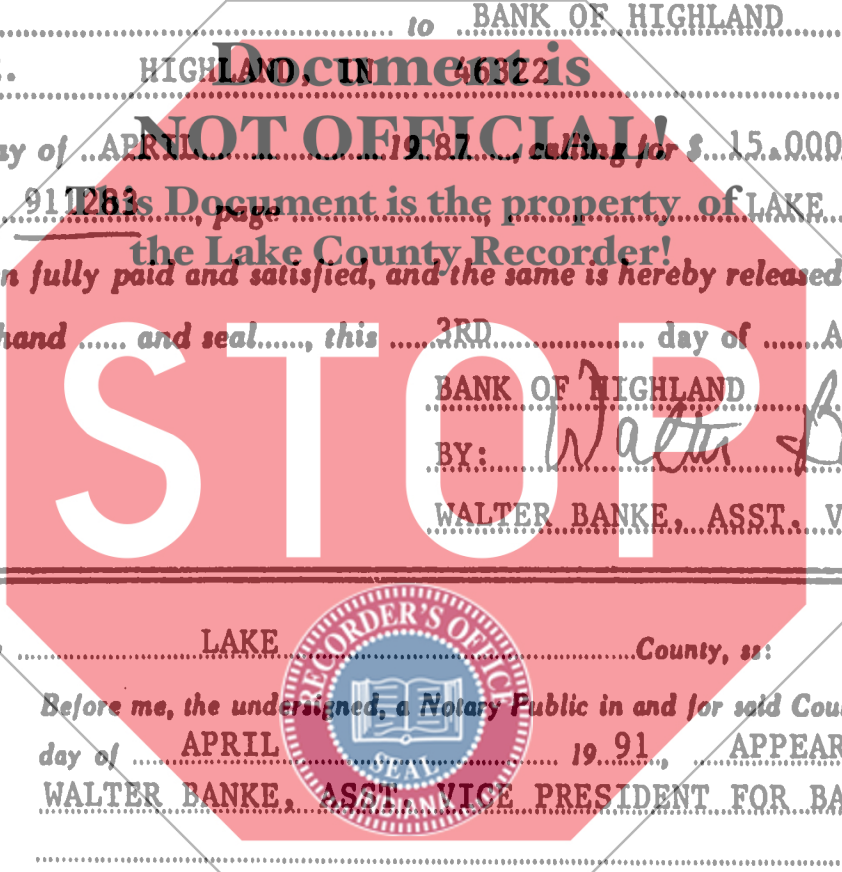

BANK OF HIGHLAND
BY: *Walter Banke*
WALTER BANKE, ASST. VICE PRESIDENT

State of Indiana, LAKE County, ss:

Before me, the undersigned, a Notary Public in and for said County, this 3RD day of APRIL 1991, APPEARED WALTER BANKE, ASST. VICE PRESIDENT FOR BANK OF HIGHLAND AND

acknowledged the execution of the annexed satisfaction of mortgage.

Witness my Hand and official seal.

COUNTY OF RESIDENCE: LAKE My Commission expires 1-27-95 BETTY L. STAMMIS Notary Public

This instrument prepared by: WALTER BANKE, ASST. VICE PRESIDENT

APR 9 9 55 AM '91
ROBERT J. BEEBE
NOTARY PUBLIC
LAKE COUNTY
INDIANA

500
ly