

THIS FORM HAS BEEN APPROVED BY THE INDIANA STATE BAR ASSOCIATION FOR USE BY LAWYERS ONLY. THE SELECTION OF A FORM OF INSTRUMENT, FILLING IN BLANK SPACES, STRIKING OUT PROVISIONS AND INSERTION OF SPECIAL CLAUSES, CONSTITUTES THE PRACTICE OF LAW AND MAY ONLY BE DONE BY A LAWYER.

Mail tax bills to:

Tax Key No.:

46-122-7

91016410

# WARRANTY DEED

COMMUNITY TITLE CO.  
421 W. 81st Avenue  
Merrillville, IN 46410

This indenture witnesseth that ROSEMARY HILL

of LAKE County in the State of INDIANA

Convey and warrant to THOMAS A. BRITTON

STATE OF INDIANA, S.S. NO. LAKE COUNTY REC. FILED APR 8 2 30 PM 1991 ROBERT W. REELAND RECORDER

of LAKE County in the State of INDIANA  
for and in consideration of Ten Dollars and other good and valuable consideration the receipt whereof is hereby acknowledged, the following Real Estate in LAKE County in the State of Indiana, to wit:

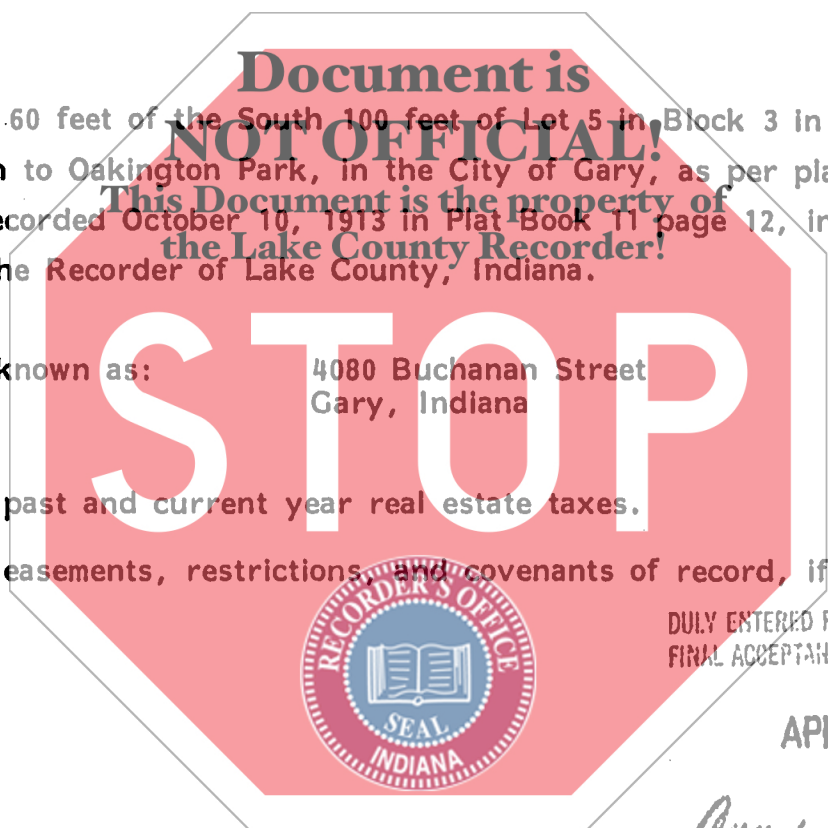

The North 60 feet of the South 100 feet of Lot 5 in Block 3 in First Subdivision to Oakington Park, in the City of Gary, as per plat thereof, recorded October 10, 1913 in Plat Book 11 page 12, in the Office of the Recorder of Lake County, Indiana.

Commonly known as: 4080 Buchanan Street Gary, Indiana

Subject to past and current year real estate taxes.

Subject to easements, restrictions, and covenants of record, if any.

DULY ENTERED FOR TAXATION SUBJECT TO FINAL ACCEPTANCE FOR TRANSFER.

APR 3 1991

*Barbara J. Hall*  
AUDITOR

State of Indiana, Lake County, ss:  
Before me, the undersigned, a Notary Public in and for said County and State, this 27th day of March 19 91 personally appeared:

ROSEMARY HILL

Dated this 27th Day of March 19 91

*Rosemary Hill*  
Rosemary Hill

And acknowledged the execution of the foregoing deed. In witness whereof, I have hereunto subscribed my name and affixed my official seal. My commission expires 1-21-95 19

*Barbara J. Hall*  
Barbara J. Hall Notary Public

Resident of Porter County.

This instrument prepared by Paul J. Giorgi, 2100 N. Main St., Crown Point, IN Attorney at Law

00035

700 CM