

THIS FORM HAS BEEN APPROVED BY THE INDIANA STATE BAR ASSOCIATION FOR USE BY LAWYERS ONLY. THE SELECTION OF A FORM OF INSTRUMENT, FILLING IN BLANK SPACES, STRIKING OUT PROVISIONS AND INSERTION OF SPECIAL CLAUSES, CONSTITUTES THE PRACTICE OF LAW AND MAY ONLY BE DONE BY A LAWYER.

Mail tax bills to: **91016372**
1221 W. 54th Avenue
Merrillville, IN 46410

Tax Key No.: _____

WARRANTY DEED

This indenture witnesseth that **MARY L. EMIG**

of Lake County in the State of Indiana

Convey and warrant to **DOLLIE A. HARDY**

of Lake County in the State of Indiana
for and in consideration of Ten (\$10) Dollars and for other good and valuable consideration
the receipt whereof is hereby acknowledged, the following Real Estate in LAKE County
in the State of Indiana, to wit:

Lot 2, Block 11, Meadowdale Subdivision, as shown in Plat Book 31, page 52, in Lake County, Indiana, and more commonly known as 1221 W. 54th Avenue, Merrillville, IN 46410.

Subject to:

1. Taxes and assessments;
2. Zoning and building ordinances;
3. Ditches and drains, if any,
4. Covenants, easements and restrictions of record; and,
5. Highways and public right-of-ways.

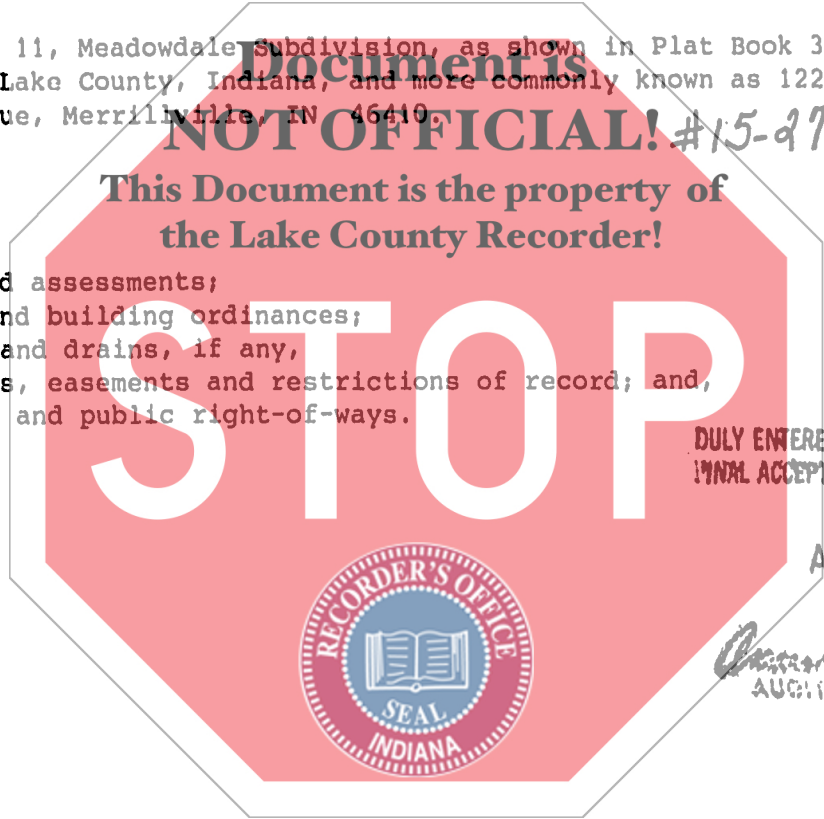

DULY ENTERED FOR TAXATION SUBJECT TO FINAL ACCEPTANCE FOR TRANSFER.

APR 5 1991

James M. Poston
AUCTIONEER LAKE COUNTY

State of Indiana, Lake County, ss:

Before me, the undersigned, a Notary Public in and for said County and State, this 28th day of March 19 91 personally appeared:

MARY L. EMIG

Dated this 28th Day of March 19 91

Mary L. Emig
MARY L. EMIG

And acknowledged the execution of the foregoing deed. In witness whereof, I have hereunto subscribed my name and affixed my official seal. My commission expires January 7, 19 94

Stacey Gray
Stacey Gray Notary Public

Resident of Lake County.

This instrument prepared by Timothy S. Schafer, 5875 Broadway, Merrillville, IN 46410 Attorney at Law

00262

700
OK

RECORDS TITLE INSURANCE COMPANY
INDIANA DIVISION
STATE OF INDIANA, S.S. NO.
LAKE COUNTY
FILED
APR 8 1 17 PM '91
ROBERT W. EISENBERG
RECORDER