

014 157639

TIGER 410.

THIS FORM HAS BEEN APPROVED BY THE INDIANA STATE BAR ASSOCIATION FOR USE BY LAWYERS ONLY. THE SELECTION OF A FORM OF INSTRUMENT, FILLING IN BLANK SPACES, STRIKING OUT PROVISIONS AND INSERTION OF SPECIAL CLAUSES, CONSTITUTES THE PRACTICE OF LAW AND MAY ONLY BE DONE BY A LAWYER.

MAIL TAX BILLS TO:

TAX KEY NO: \_\_\_\_\_

7637 MARSHALL PLACE  
MERRILLVILLE, IN 46410

# QUIT-CLAIM DEED

91016253

This indenture witnesseth that **KAREN L. MADER, now known as Karen L. Kansfield**

of **LAKE** County in the State of **INDIANA**

Releases and quit claims to **MARENIS J. KANSFIELD, III AND KAREN L. KANSFIELD, HUSBAND AND WIFE**

of **LAKE** County in the State of **INDIANA**  
for and in consideration of **TEN DOLLARS AND OTHER GOOD AND VALUABLE CONSIDERATION**  
the receipt whereof is hereby acknowledged, the following Real Estate in **LAKE** County  
in the State of Indiana, to wit:

The real estate and premises commonly known as 7637 Marshall Place, in the Town of Merrillville, County of Lake, State of Indiana, and more particularly described as follows, to-wit:

Lot 85 in Lincoln Gardens Fourth Subdivision, in the Town of Merrillville, as per plat thereof, recorded in Plat Book 35 page 90, in the Office of the Recorder of Lake County, Indiana.

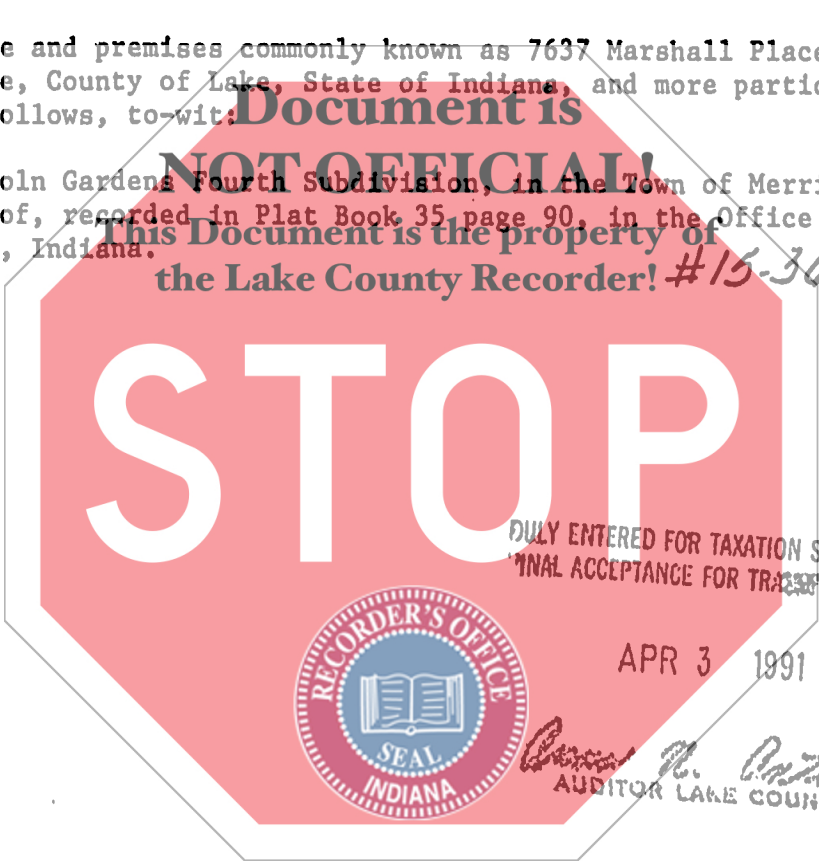

State of Indiana, Lake County, ss:  
Before me, the undersigned, a Notary Public in and for said County and State, this 25th day of March 19 91 personally appeared:

**KAREN L. MADER, now known as Karen L. Kansfield**

Dated this 25th Day of March 19 91

*Karen L. Mader (Kansfield)*  
**KAREN L. MADER, now known as KAREN L. KANSFIELD**

And acknowledged the execution of the foregoing deed. In witness whereof, I have hereunto subscribed my name and affixed my official seal. My commission expires 1-21-19 95

*Barbara J. Hall*  
**BARBARA J. HALL** Notary Public

Resident of **PORTER** County

00106

This instrument prepared by **THOMAS K. HOFFMAN, ONE PROFESSIONAL CENTER, CROWN POINT, INDIANA 46307**, Attorney at Law

MAIL TO:

700  
zi