

*File will Associate
P.O. Box 44141
Indpls. IN 46204*

91616229

This Indenture, Made this 22nd day of February A. D. 19 91
between Stephen R. Stiglich Sheriff of Lake County, in the State of Indiana, of the first part
and MIDLAND MORTGAGE CORPORATION

of the County of Lake and State of Indiana of the second part. WITNESSETH:
THAT WHEREAS, At the Continuous Term of the Lake Circuit Court A.D. 19 90
MIDLAND MORTGAGE CORPORATION

recovered by judgment of said Court, in a certain action therein against
RUSSELL L. MOBLEY, SR., a/k/a RUSSELL MOBLEY, a/k/a RUSSELL L. MOBLEY, EULA M. MOBLEY
a/k/a EULA MOBLEY, NORWOOD FEDERAL SAVINGS AND LOAN ASSOCIATION, UNION MORTGAGE COMPANY,
INC., and the UNITED STATE OF AMERICA

the sum of Forty-Four Thousand Ten Dollars and
Forty-Two Cents, for its damages, together with the further sum of Thirteen
Dollars and No Cents, for its costs in that behalf expended; and

a decree for the sale of all the interest, estate, right and title of the defendant
RUSSELL L. MOBLEY, SR., a/k/a RUSSELL MOBLEY, a/k/a RUSSELL L. MOBLEY, EULA M. MOBLEY,
et al

Key # 30-391-12 in and to certain Real Estate, described therein as follows, to wit:
Lot 12 in the Resubdivision of Lots 1 to 20, inclusive, Block 10 and Lots 25 to
44, both inclusive, Block 11, except the North 19 feet of Lot 39 and the South 14
feet of Lot 40, Block 11, of the Fourth Addition to Indiana Harbor, in the City of
East Chicago, as per plat thereof, recorded in Plat Book 8, page 21, in the Office
of the Recorder of Lake County, Indiana.
More commonly known as: 3823 Drummond Avenue, East Chicago, IN. 46312.

154420-3

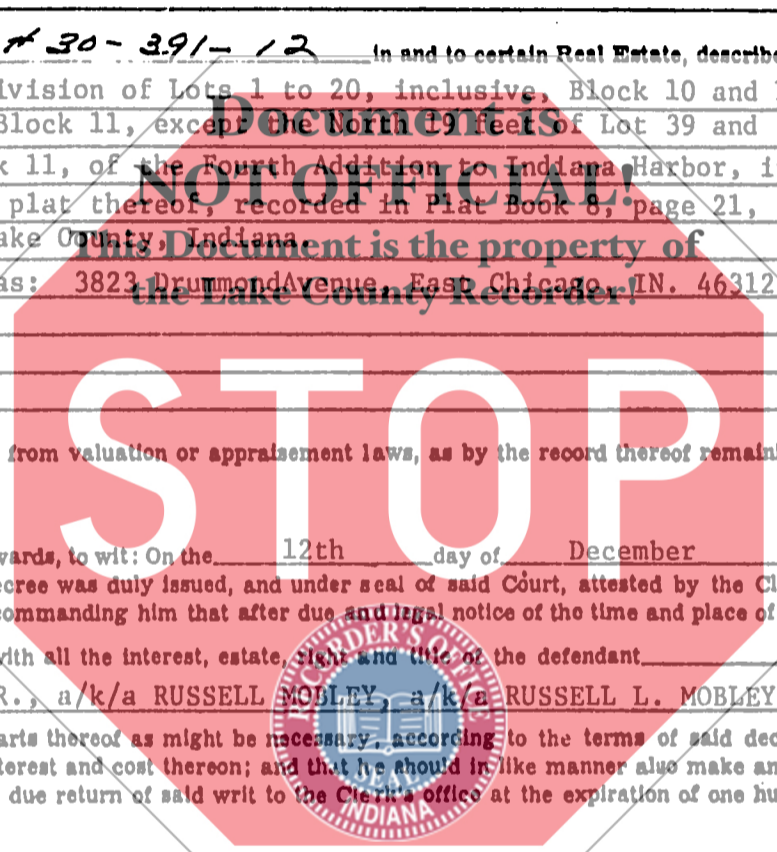

STATE OF INDIANA S.S. NO. 90
LAFAYETTE COUNTY
APR 8 8 55 AM '91
ROBERT J. ...
RECORDED

TICOR TITLE INSURANCE
Crown Point, Indiana

All without any relief whatever from valuation or appraisal laws, as by the record thereof remaining in said Court more fully appears.

AND WHEREAS, Afterwards, to wit: On the 12th day of December
a copy of said judgment and decree was duly issued, and under seal of said Court, attested by the Clerk thereof, directed to the
Sheriff of the County of Lake, commanding him that after due and legal notice of the time and place of making the same, he should
sell the land above described, with all the interest, estate, right and title of the defendant

RUSSELL L. MOBLEY, SR., a/k/a RUSSELL MOBLEY, a/k/a RUSSELL L. MOBLEY, et al
therein, or so much and such parts thereof as might be necessary, according to the terms of said decree, to pay and satisfy the
judgment aforesaid, with the interest and cost thereon; and that he should in like manner also make and return all interest and ac-
cruing costs thereon, and make due return of said writ to the Clerk's office at the expiration of one hundred and eighty days from
the date of the same.

AND WHEREAS Said copy of judgment and order of sale, on the 13th day of December A.D. 19 90
came to the hands of Stephen R. Stiglich then the Sheriff of said County, to be executed, and the said
Stephen R. Stiglich as said Sheriff as aforesaid, having legally advertised the same, did on the 22nd
day of February A.D. 19 91, at the Court House door in Crown Point in the County aforesaid, between
the hours prescribed by law, at public auction, expose to sale the rents, profits, issues and income, of said estate of
RUSSELL L. MOBLEY, SR., a/k/a RUSSELL MOBLEY, et al

together with all the rights, title and interest in fee simple of the said RUSSELL L. MOBLEY, SR., a/k/a RUSSELL MOBLEY,
in and to said estate, and the said MIDLAND MORTGAGE CORPORATION

did then and there bid the sum of Forty-Three Thousand Dollars and No
Cents, and no person g more, the same was in due form openly struck off and sold to the said
MIDLAND MORTGAGE CORPORATION

for the said sum of Forty-Three Thousand
Dollars and No Cents its being

the highest bidder, and that being the highest price bid for the same.
DULY ENTERED FOR TAXATION SUBJECT TO
FINAL ACCEPTANCE FOR TRANSFER.

APR 3 1991

00053

James M. ...
AUDITOR LAKE COUNTY

900/2

NOW THEREFORE, to confirm to said MIDLAND MORTGAGE CORPORATION

the sale so made as aforesaid, the said Stephen R. Stiglich
as Sheriff as aforesaid, in consideration of said sum of Forty-Three Thousand
Dollars and No Cents, to him in hand paid by said
MIDLAND MORTGAGE CORPORATION

the receipt whereof is hereby acknowledged, as
provided by law hath GRANTED, BARGAINED AND SOLD, and doth by these presents GRANT, BARGAIN, SELL, CONVEY AND
CONFIRM to the said MIDLAND MORTGAGE CORPORATION heirs and assigns FOREVER, all the following

Real Estate situate in the County of Lake and State of Indiana, to wit:

Lot 12 in the Resubdivision of Lots 1 to 20, inclusive, Block 10 and Lots 25 to
44, both inclusive, Block 11, except the North 19 feet of Lot 39 and the South 14
feet of Lot 40, Block 11, of the Fourth Addition to Indiana Harbor, in the City of
East Chicago, as per plat thereof, recorded in Plat Book 8, page 21, in the Office
of the Recorder of Lake County, Indiana.

More commonly known as 3823 Drummond Avenue, East Chicago, Indiana 46312.

Document is NOT OFFICIAL!
This Document is the property of
the Lake County Recorder!

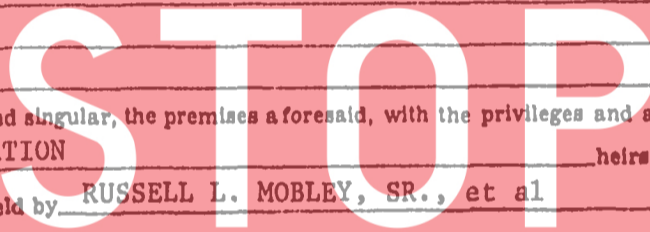

TO HAVE AND TO HOLD, All and singular, the premises aforesaid, with the privileges and appurtenances, to the said
MIDLAND MORTGAGE CORPORATION heirs and assigns, forever, in as full
and ample a manner as the same was held by RUSSELL L. MOBLEY, SR., et al

Immediately before the execution of the mortgage mentioned in said decree, foreclosing the same.

IN WITNESS WHEREOF, The said Stephen R. Stiglich as Sheriff as aforesaid, has hereunto set
his hand and seal, the day and year above written.



(Seal)
Sheriff Lake County, Indiana.

State of Indiana, Lake County, ss:

BEFORE ME, DONNA M. GILLAM NOTARY PUBLIC, in and for said County, personally

came Stephen R. Stiglich Sheriff of said County, and acknowledged the foregoing conveyance to be his
voluntary act and deed as such sheriff.

My Comm. Expires
1-30-95

IN WITNESS WHEREOF, I hereunto subscribe my name, and affix my official seal of office, this
22ND day of February A. D. 19 91

Donna M. Gillam
DONNA M. GILLAM - LAKE COUNTY

THIS INSTRUMENT PREPARED BY DONNA M. GILLAM

Stephen R. Stiglich
Sheriff of Lake County

TO

MIDLAND MORTGAGE CORPORATION
Midland Center
P.O. Box 26648
Oklahoma City, Oklahoma 73126

DEED ON DECREE

Received for Record

This _____ day of _____

A.D. 19____, at _____ o'clock _____ M.

and recorded in Record _____

page _____

Recorder for Lake County

Duly Entered for Taxation

_____ 19____

Auditor