

B451682 Pg 4042 A/C 70,797-3

600
P2

THIS FORM HAS BEEN APPROVED BY THE INDIANA STATE BAR ASSOCIATION FOR USE BY LAWYERS ONLY. THE SELECTION OF A FORM OF INSTRUMENT, FILLING IN BLANK SPACES, STRIKING OUT PROVISIONS AND INSERTION OF SPECIAL CLAUSES, CONSTITUTES THE PRACTICE OF LAW AND MAY ONLY BE DONE BY A LAWYER.

Mail tax bills to: 2453 HOBART ST., GARY, IN 46406

Tax Key No.: 49-295-33

91009509

WARRANTY DEED

This indenture witnesseth that SOPHIE GRIFFIN

of Lake County in the State of Indiana

Convey and warrant to ROBERT W. ROGERS and CAROLYN S. ROGERS, Husband and Wife, as tenants by the entireties

of Lake County in the State of Indiana for and in consideration of TEN (\$10.00) DOLLARS and other good and valuable consideration the receipt whereof is hereby acknowledged, the following Real Estate in Lake County in the State of Indiana, to wit:

LOTS 33 and 34, BLOCK 14, OAK RIDGE PARK ADDITION TO GARY, AS SHOWN IN PLAT BOOK 9, PAGE 1, IN LAKE COUNTY, INDIANA.

More commonly known as 2453 Hobart Street, Gary, Indiana 46406.

SUBJECT TO: Unpaid taxes if any, covenants, easements, conditions and restrictions of record.

44-295-33

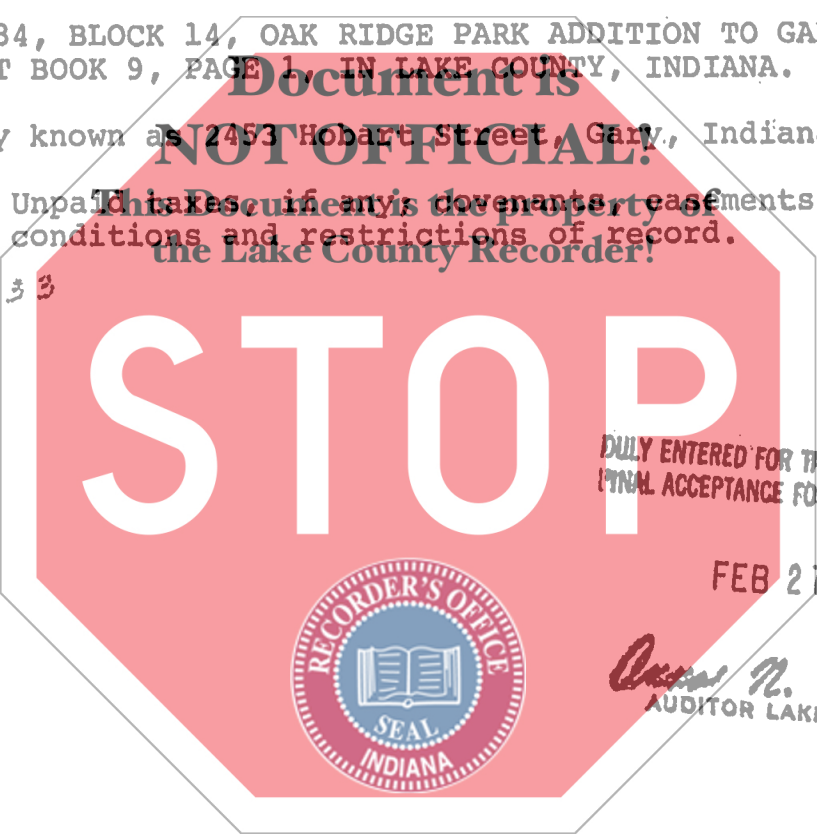

State of Indiana, LAKE County, ss:

Before me, the undersigned, a Notary Public in and for said County and State, this 19TH day of FEBRUARY 19 91 personally appeared:

SOPHIE GRIFFIN

Dated this 30TH Day of JANUARY 19 91

SOPHIE GRIFFIN	REC'D	FEB 28	FILED	STATE OF INDIANA
	RECORDED	1 31		FILED
		16 PM '91		

And acknowledged the execution of the foregoing deed. In witness whereof, I have hereunto subscribed my name and affixed my official seal. My commission expires FEBRUARY 1, 1993

Karen M. Sulek
KAREN M. SULEK
Notary Public

Resident of LAKE County.

This instrument prepared by LOWELL E. ENSLEN Attorney at Law
142 Rimbach, Hammond, Indiana 46320

01680

100
CK

CHICAGO TITLE INSURANCE COMPANY
INDIANA DIVISION