

Com 157678

*Juon/cpbm*

THIS FORM HAS BEEN APPROVED BY THE INDIANA STATE BAR ASSOCIATION FOR USE BY LAWYERS ONLY. THE SELECTION OF A FORM OF INSTRUMENT, FILLING IN BLANK SPACES, STRIKING OUT PROVISIONS AND INSERTION OF SPECIAL CLAUSES, CONSTITUTES THE PRACTICE OF LAW AND MAY ONLY BE DONE BY A LAWYER.

Mail tax bills to: **91009281**

Tax Key No. \_\_\_\_\_

Lori A. Fuchs  
247 Maxwell Street  
Crown Point, IN 46307

# WARRANTY DEED

This indenture witnesseth that **JUDY A. BOERSMA** formerly **JUDY A. MAYNARD**,

STATE OF INDIANA / S.S. NO. \_\_\_\_\_  
FILED \_\_\_\_\_  
FEB 29 9 02 AM '91

of Lake County in the State of Indiana,

Convey and warrant to **LORI Ann FUCHS**,

of Lake County in the State of Indiana,  
for and in consideration of Ten (\$10.00) Dollars and other good valuable considerations,  
the receipt whereof is hereby acknowledged, the following Real Estate in Lake County  
in the State of Indiana, to wit:

Lot 10 in Sunny-Side Addition to Crown Point, as per plat thereof, recorded in Plat Book 17 page 29, in the Office of the Recorder of Lake County, Indiana.

**This Document is the property of the Lake County Recorder!**

**SUBJECT TO:**

1. Real estate taxes for the year 1990, payable in 1991, and thereafter.
2. All covenants, easements, building lines, zoning ordinances and restrictions of record, if any.

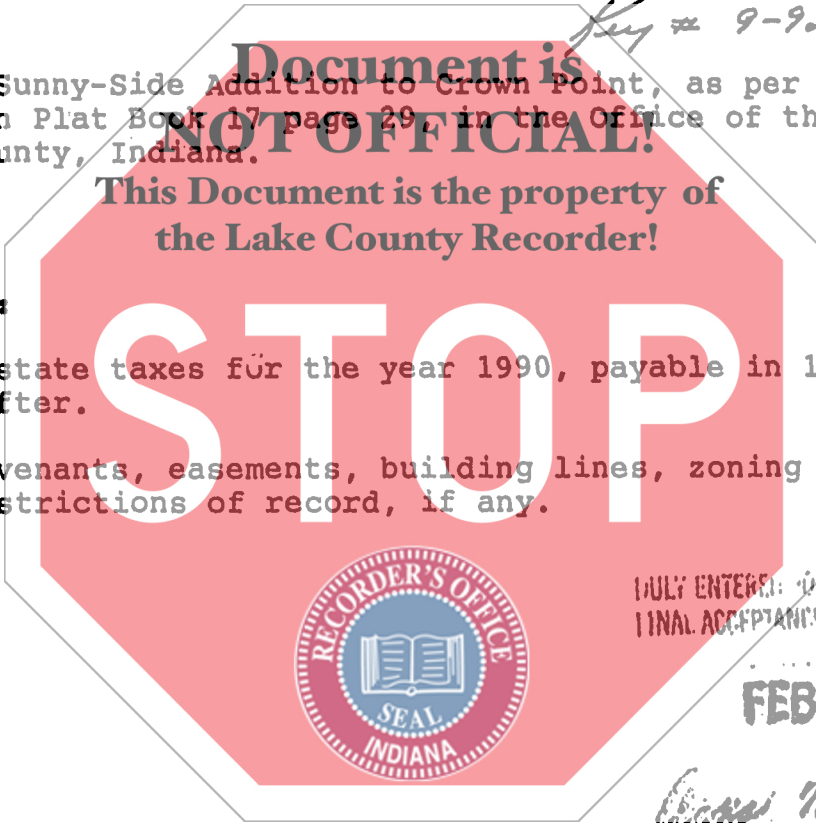

State of Indiana, Lake County, ss:  
Before me, the undersigned, a Notary Public in and for said County and State, this 22nd day of Feb. 1991  
personally appeared:

**JUDY A. BOERSMA**, formerly  
**Judy A. Maynard**

Dated this 22 Day of Feb. 1991

Judy A. Boersma  
**JUDY A. BOERSMA**,  
Formerly **Judy A. Maynard**

And acknowledged the execution of the foregoing deed. In witness whereof, I have hereunto subscribed my name and affixed my official seal. My commission expires Oct. 24 1992

Gloria Miller  
**Gloria Miller** Notary Public

Resident of Lake County.

This instrument prepared by Robert L. Pressler, Attorney at Law  
1000 E. 80th Place Ste 326N, Merrillville, IN 46410

01608  
700  
K